

HIGH VOLTAGE



SHV / MHV / 10 KV / 20 KV DESCRIPTION/SPECIFICATIONS

SHV

JACK

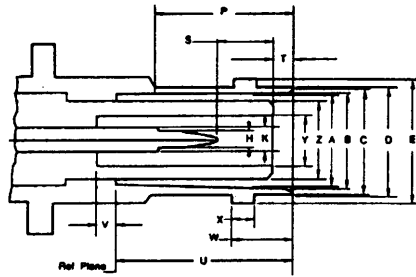

PLUG

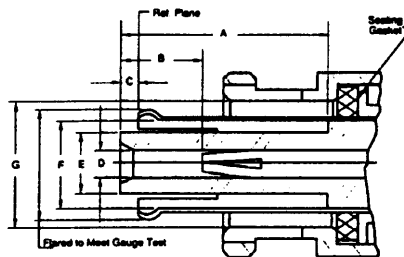

BHV — Jack

Dim Ltr	Inches		Millimeters	
	Min	Max	Min	Max
A	.318	.381	8.10	6.15
B	.325	.333	8.23	8.48
C	.347	.357	8.81	9.07
D	.378	.382	9.60	9.70
E	.432	.435	10.97	11.07
H	.052	.054	1.32	1.37
K	.081	.083	2.06	2.11
P	.427			
S	.188	.208	4.78	5.28
T	.061	.079	1.35	1.98
U	.626	.830	15.90	16.00
V	.064	.085	1.83	2.18
W	.204	.208	5.18	5.08
X	.075	.081	1.90	2.08
Y	.180	.198	4.83	4.98
Z		.250		8.80

MHV

PLUG

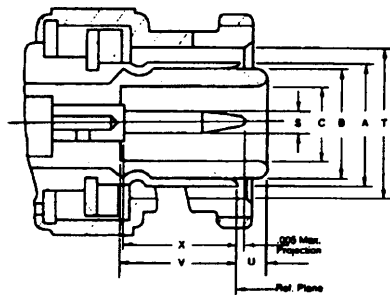

JACK

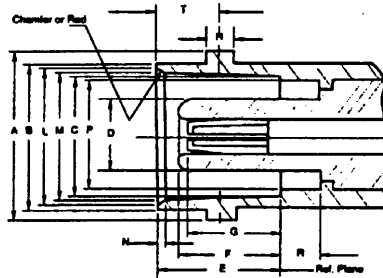

SHV — Plug

Dim Ltr	Inches		Millimeters	
	Min	Max	Min	Max
A	.626	.832	15.95	15.05
B	.238	.862	8.05	8.28
C	.048	.064	1.17	1.53
D	.052		2.08	
E	.180	.185	4.57	4.72
F	.264		6.71	
G	.385	.390	9.78	9.91

10 KV

PLUG

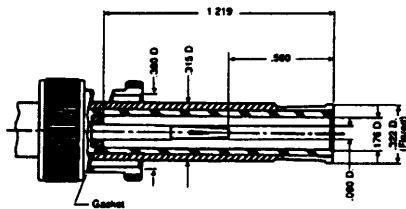

JACK

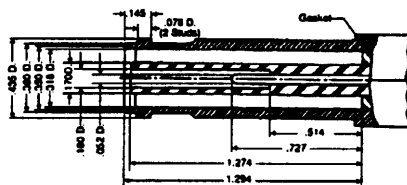

MHV — Plug

Dim Ltr	Inches (mm)	
	Minimum	Maximum
A	Gauge Test	
B	.278 (7.08)	.282 (7.16)
C	.180 (4.33)	.194 (4.83)
S	.082 (1.32)	.054 (1.37)
T	.085 (9.78)	.380 (9.91)
U		.086 (2.18)
V	.302 (7.67)	
X	.300 (7.62)	
Z	.045 (1.14)	.048 (1.24)

20 KV

PLUG

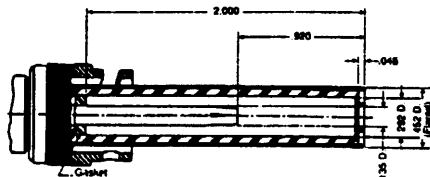

JACK

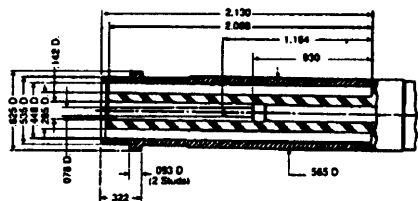

MHV — Jack

Dim Ltr	Inches (mm)	
	Minimum	Maximum
A	.432 (10.97)	.436 (11.07)
B	.378 (9.80)	.382 (9.70)
C	.318 (8.10)	.321 (8.15)
D		.186 (4.72)
E	.327 (8.31)	.335 (8.51)
F	.888 (7.34)	.311 (7.90)
G	.253 (6.43)	.280 (7.11)
H	.075 (1.91)	.081 (2.08)
L	.345 (8.79)	.858 (9.04)
M	.327 (9.31)	.383 (9.04)
N	.016 (0.58)	.030 (0.78)
P	.294 (7.21)	.290 (7.37)
R	.088 (2.18)	
T	.165 (4.18)	.169 (4.39)

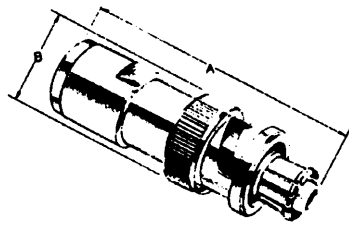

FIGURE 1

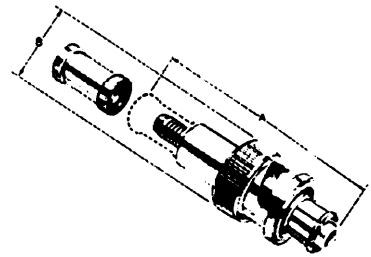

FIGURE 2

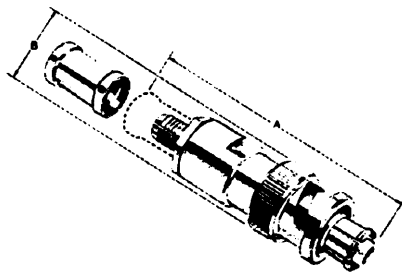

FIGURE 3

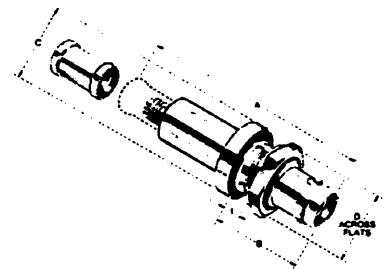
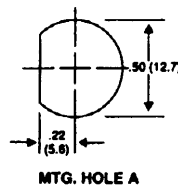

FIGURE 4



SHV

PLUGS – CONVENTIONAL CONSTRUCTION															
CABLE GROUP	KINGS PART NUMBER		FIG. NO.	NOTES	DIMENSIONS						CABLING				
	TR-5 FINISH	TR-5 FINISH			A	B	C	D	t	MTG. HOLE	CBL. TRIM CODE	CRIMP DIE			
	in	mm			in	mm	in	mm	in	mm					
G		1705-14	1		1.81	46.0	1.58	40.1				1001.3			
PLUGS – WEATHERPROOF K-GRIP, JR. CONSTRUCTION															
D		1705-2	2	Crimp Contact	1.83	46.5						441	KTH-2061		
G-1		1705-1	2	Crimp Contact	1.83	46.5						441	KTH-2062		
PLUGS – PRE-ASSEMBLED WEATHERPROOF K-GRIP CONSTRUCTION															
B-1		1705-3	3	Crimp Contact	2.01	51.1						447	KTH-2071		
BULKHEAD JACKS – WEATHERPROOF K-GRIP, JR. CONSTRUCTION															
G-1		1702-1	4	Crimp Contact, Rear Mtg.	2.20	55.9	0.81	20.6	0.89	17.5	0.227	5.8	A	441	KTH-2062