

ROLL CONTROL Demonstration Guide



- ◆ Dispenser must be firmly fastened to a surface.
- ◆ Do not try a hand held Demo.
- ◆ Aim for a trial in preference to a demo.
- ◆ If a demo is necessary, note the following:
 - ◆ Mount the dispenser on a wall or stable demo board.
 - ◆ Do not clip lid fully onto dispenser. (This would prevent a part used roll from being retrieved).
 - ◆ Remove roll core in front of customer and load dispenser.
 - ◆ Note: roll can collapse if transported without the core and lead to jamming.
 - ◆ Dispense sheets for the customer before allowing him to try (ideally minimum of 10 sheets).
 - ◆ Note: dispensing improves the further you get into the roll.
 - ◆ Follow guidelines for correct mounting height, loading and roll use.

Q: Lid is loose.

A: Ensure lid is pushed fully home and the clips click into place achieving a tight seal between lid and base. Force may be required.

Q: Sheets do not dispense well. Sheets are ripping on dispensing.

A: Dispensing must be in a straight down direction. Check if sheet is feeding correctly. Open the door and restart roll if necessary. Check dispenser mounted at correct height.

Q: Two sheets are dispensed at a time.

A: Ensure sheet is gripped as low as possible. Two sheet dispensing can occur when the offset between sheets reduces below 100mm. This will correct itself with continued dispensing. Consumption claims take this into account.

Q: Cannot take the lid off.

A: Lid is intended to be fixed with loading from below. In an emergency, use a short headed screw driver to remove dispenser from wall and release lid clips from behind.

Q: Do Roll Control rollers work with standard dispensers?

A: No. Roll Control was designed as an integrated system requiring both dispenser and rolls. Controlled dispensing will not be possible if either element is missing.

Q: Do Roll Control dispensers work with standard rolls?

A: No. Roll Control was designed as an integrated system requiring both dispenser and rolls. Controlled dispensing will not be possible if either element is missing.

ROLL CONTROL Installation & Usage Guide

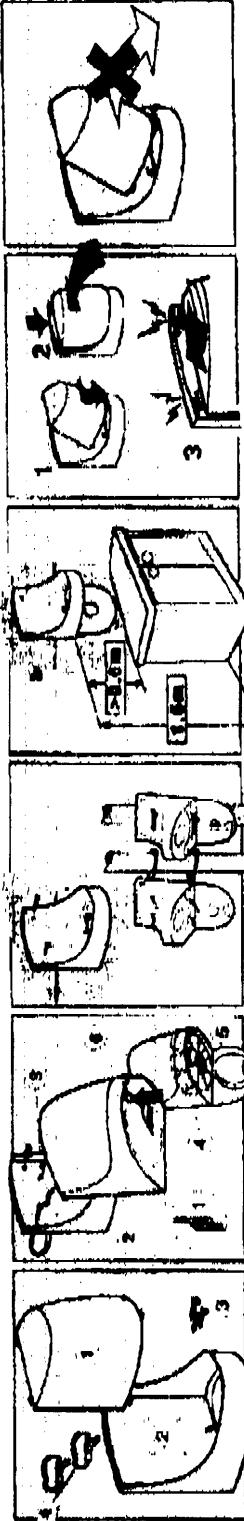

- ◆ Show Contents:
1. Lid
 2. Base
 3. Screws
 4. Cable ties

- ◆ Show Features:
1. Double seal joints
 2. Fixing options
 3. Holes for cable ties (or cable ties for fixing to posts etc.)
 4. One-way flaps
 5. Level indication
 6. Door opening button

- ◆ Fix base securely before lid is fitted.
- ◆ Use screws provided (or cable ties for fixing to posts etc.)

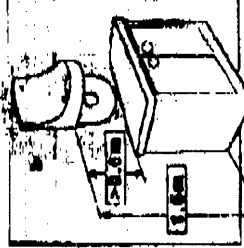

- ◆ Mount dispenser minimum 1.5m high.
- ◆ Allow minimum 0.8m clearance below for roll access and dispensing.

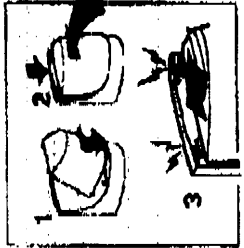

- ◆ Fix lid securely to base.
- ◆ Locate bottom of the lid first, then top of lid ensuring clips click fully into place and a tight seal is achieved between the lid and base.
- ◆ You may need to force the lid home with the heel of your hand.

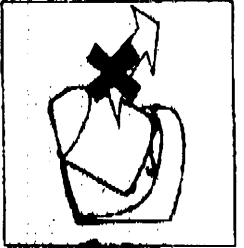

- ◆ Note: The lid is not intended to be removed once fitted.

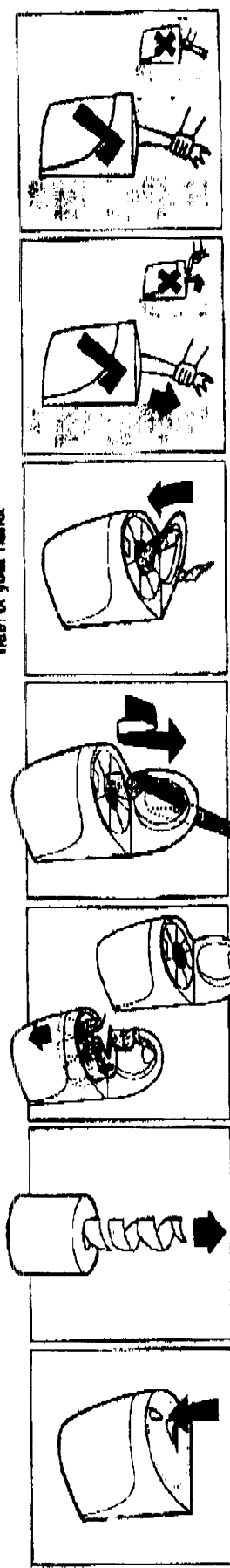

- ◆ Push button to release door.

- ◆ Remove poly wrap from roll.
- ◆ Remove core from roll.
- ◆ Pull out a short length of sheet.

- ◆ Insert roll from below.
- ◆ Push fully past flaps.
- ◆ Check roll rests on flaps.
- ◆ Position roll towards front of dispenser.

- ◆ Feed sheet through aperture as shown.

- ◆ Close door firmly.
- ◆ Do not slam.

- ◆ Pull sheet straight down.
- ◆ Pulling at an angle will cause ripping.

- ◆ Grip trailing sheet as low as possible to avoid taking two sheets.

How to install

How to use