

ITEM NO.	FORM	WIRE GAGE	RANGE OF INSULATION DIA.	STANDARD PACK QUANTITY (SPQ)	DIM. "A"	DIM. "B"	DIM. "C"	DIM. "D"	DIM. "E"	DIM. "F"	FINISH (SEE NOTE 2)
46012-1141	CHAIN	18-20 GA.	.051-.122 (1.30-3.10)	4,000 / REEL	.075±.012	.091±.016	.020	.142±.012	.177±.016	.035	FINISH 1 - BRIGHT TIN OVER NICKEL
46012-1142	LOOSE			1,000 / BAG	(1.90±.30)	(2.30±.40)	(.50)	(3.60±.30)	(4.50±.40)	(.90)	
46012-3141	CHAIN	16 GA.	.122 (3.10) MAX.	4,000 / REEL	.091±.012	.106±.016	.024	.142±.012	.177±.016	.035	
46012-3142	LOOSE			1,000 / BAG	(2.30±.30)	(2.70±.40)	(.60)	(3.60±.30)	(4.50±.40)	(.90)	
46012-1241	CHAIN	18-20 GA.	.051-.122 (1.30-3.10)	4,000 / REEL	.075±.012	.091±.016	.020	.142±.012	.177±.016	.035	FINISH 2 - SEL. GOLD AND SEL. MATTE TIN OVER NICKEL
46012-1242	LOOSE			1,000 / BAG	(1.90±.30)	(2.30±.40)	(.50)	(3.60±.30)	(4.50±.40)	(.90)	
46012-3241	CHAIN	16 GA.	.122 (3.10) MAX.	4,000 / REEL	.091±.012	.106±.016	.024	.142±.012	.177±.016	.035	
46012-3242	LOOSE			1,000 / BAG	(2.30±.30)	(2.70±.40)	(.60)	(3.60±.30)	(4.50±.40)	(.90)	

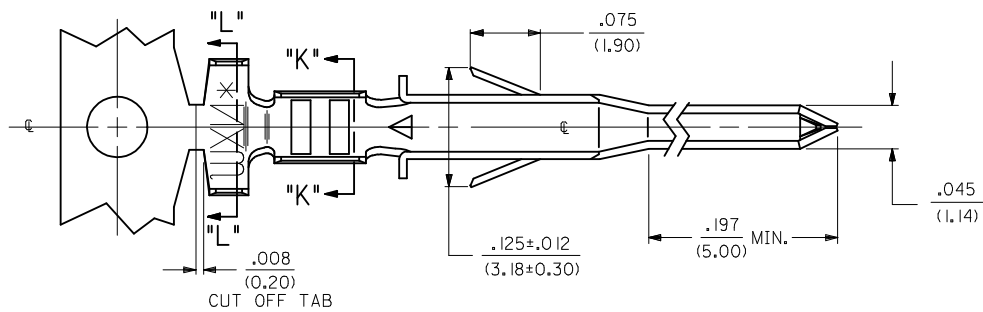

- NOTES:
1. MATERIAL: COPPER ALLOY .0080/(.203) THICK.
  2. FINISH:
    - 1= .000100/(0.00254) MIN. BRIGHT TIN OVER .000050/(0.00127) MIN NICKEL OVERALL.
    - 2= .000030/(.00076) MIN SELECT GOLD IN CONTACT AREA AND .000100/(0.00254) MIN SELECT MATTE TIN IN CRIMP AREA OVER .000050/(0.00127) MIN NICKEL OVERALL. GOLD PLATING RECOMMENDED FOR APPLICATIONS WHERE FRETTING CORROSION IS A CONCERN.
  3. PRODUCT SPECIFICATION: PS-45750-001 (JR), PS-45750-002 (BMI), PS-45750-003 (TPA)
  4. MEASURING POINT FOR PLATING THICKNESS.
  5. TERMINAL FOR USE WITH MOLEX PLUG HOUSINGS 5559, 42475, 43770 AND 30068.
  6. THIS TERMINAL IS DESIGNED FOR SINGLE WIRE CRIMPING.
  7. WHEN TERMINALS ARE INSTALLED IN THE HOUSINGS, THE WIRES ARE TO BE DRESSED IN SUCH A MANNER TO ALLOW THE TERMINALS TO FLOAT FREELY IN THE POCKETS.
  8. TERMINALS ARE ROHS COMPLIANT.

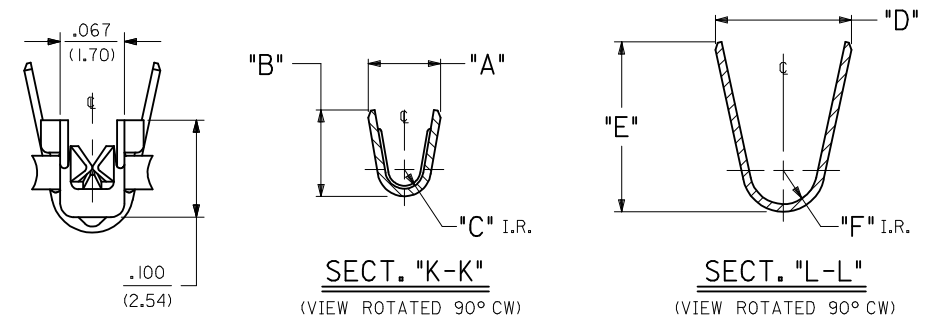
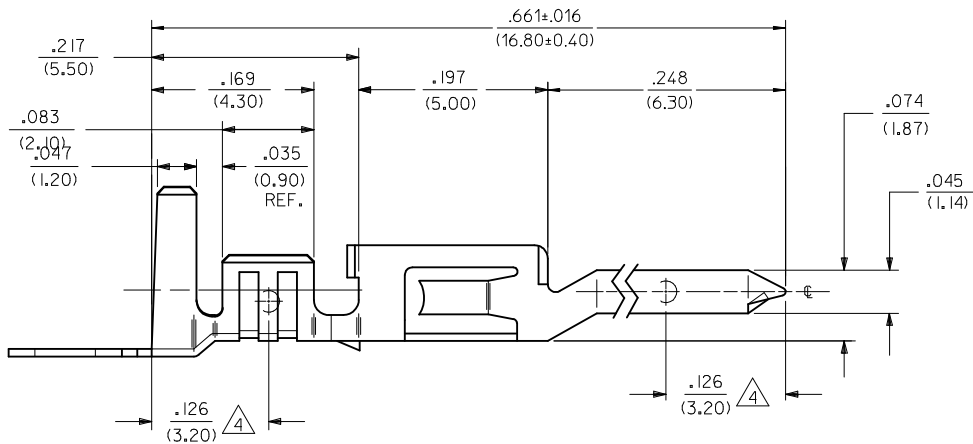

**LEGEND:**

46012 - \* \* 4 \*

BASE NO. \_\_\_\_\_

WIRE GAGE  
1= 18-20  
3= 16

CHAIN OR LOOSE  
1= CHAIN  
2= LOOSE

PLATING  
1= TIN  
2= GOLD

ADD FIN. TO CHART, NOTE 8 EC NO: UCP2009-2063 DRWN: C STEWART 2009/02/24 CHKD: B WIRKUS 2009/04/21 APPR: B WIRKUS 2009/04/22	QUALITY SYMBOLS ▽=0 ▽=0	GENERAL TOLERANCES (UNLESS SPECIFIED) mm INCH 4 PLACES ± --- ± --- 3 PLACES ± --- ± .010 2 PLACES ± 0.25 ± .015 1 PLACE ± 0.38 ± --- ANGULAR ±1/2°	DIMENSION STYLE IN/MM DRAWN BY DATE TGREGORI 2005/07/28 CHECKED BY DATE GPOLGAR APPROVED BY DATE JCOMERC I MATERIAL NO. SEE CHART	SCALE DESIGN UNITS METRIC THIRD ANGLE PROJECTION	TITLE TERM., MALE, CRIMP MINI-FIT JR. HCS PLUS SERIES MOLEX INCORPORATED DOCUMENT NO. SD-46012-001 SHEET NO. 1 OF 1
		DRAFT WHERE APPLICABLE MUST REMAIN WITHIN DIMENSIONS	THIS DRAWING CONTAINS INFORMATION THAT IS PROPRIETARY TO MOLEX INCORPORATED AND SHOULD NOT BE USED WITHOUT WRITTEN PERMISSION		