



PART NO.

MCEI Series

REVISIONS

ECN #	REV	DESCRIPTION	DRAWN	DATE	CHECKD	DATE	APPRVD	DATE
-	A	RELEASED	Jagan	11/2/08	Suresh	11/2/08	G. C	26/2/08

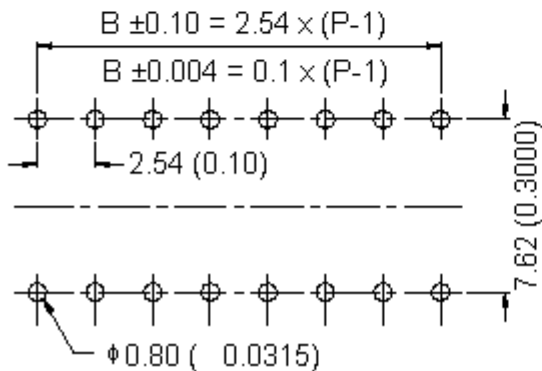
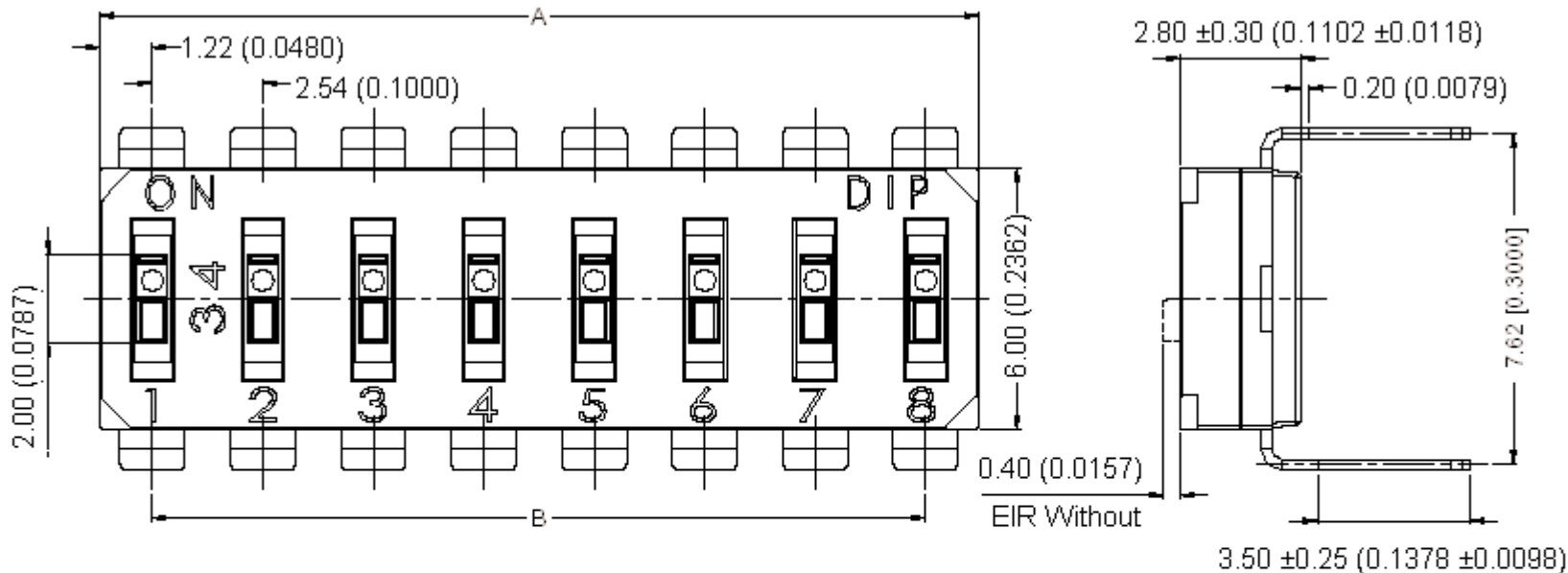

PCB Layout

Schematic (Typical)



(1, 2, 3, 4, 5, 6, 7, 8, 9, 10, 12 Positions Available)

Dimensions : Millimetres (Inches)

This data sheet and its contents (the "Information") belong to the Premier Farnell Group (the "Group") or are licensed to it. No licence is granted for the use of it other than for information purposes in connection with the products to which it relates. No licence of any intellectual property rights is granted. The Information is subject to change without notice and replaces all data sheets previously supplied. The Information supplied is believed to be accurate but the Group assumes no responsibility for its accuracy or completeness, any error in or omission from it or for any use made of it. Users of this data sheet should check for themselves the Information and the suitability of the products for their purpose and not make any assumptions based on information included or omitted. Liability for loss or damage resulting from any reliance on the Information or use of it (including liability resulting from negligence or where the Group was aware of the possibility of such loss or damage arising) is excluded. This will not operate to limit or restrict the Group's liability for death or personal injury resulting from its negligence. SPC MULTICOMP is the registered trademark of the Group. © Premier Farnell plc 2008.

TOLERANCES:
UNLESS OTHERWISE SPECIFIED, DIMENSIONS ARE FOR REFERENCE PURPOSES ONLY.

DRAWN BY:	DATE:
Jagan	11/02/08
CHECKED BY:	DATE:
Suresh	11/02/08
APPROVED BY:	DATE:
G.Cook	26/02/08

DRAWING TITLE:			
Dual In Line Switches - End Stackable			
SIZE	DWG NO.	ELECTRONIC FILE	REV
A	M10000815	EI-EIR_DWG	A
SCALE: NTS		U.O.M.: mm (Inches)	SHEET: 1 OF 5



PART NO.

MCEI Series

REVISIONS

ECN #	REV	DESCRIPTION	DRAWN	DATE	CHECKD	DATE	APPRVD	DATE
-	A	RELEASED	Jagan	11/2/08	Suresh	11/2/08	G. C	26/2/08

Specifications:

Mechanical:

Mechanical life : 2,000 operations.
 Maximum operating force : 1,000gf.
 Stroke : 1.0mm
 Operating temperature range : -20 to +85°C.
 Storage temperature range : -40 to +85°C.

Electrical:

Electrical life : 2,000 cycles.
 Rating : 25mA, 24V dc.
 Minimum contact resistance : 100mΩ at 500V dc.
 Maximum insulation resistance : 100MΩ at 500V dc.
 Dielectric strength : 500V ac/1 minute.
 Contact arrangement : 1 pole throw.

Materials:

Base and cover : UL 94V-0 Nylon high temperature thermoplastic.
 Colour : Black.
 Actuator : UL 94V-0 LCP high temperature thermoplastic.
 Colour : White.
 Contact : Alloy copper with gold plated.
 Terminal : Brass with gold plated.
 Tape : Kapton.

This data sheet and its contents (the "Information") belong to the Premier Farnell Group (the "Group") or are licensed to it. No licence is granted for the use of it other than for information purposes in connection with the products to which it relates. No licence of any intellectual property rights is granted. The Information is subject to change without notice and replaces all data sheets previously supplied. The Information supplied is believed to be accurate but the Group assumes no responsibility for its accuracy or completeness, any error in or omission from it or for any use made of it. Users of this data sheet should check for themselves the Information and the suitability of the products for their purpose and not make any assumptions based on information included or omitted. Liability for loss or damage resulting from any reliance on the Information or use of it (including liability resulting from negligence or where the Group was aware of the possibility of such loss or damage arising) is excluded. This will not operate to limit or restrict the Group's liability for death or personal injury resulting from its negligence. SPC MULTICOMP is the registered trademark of the Group. © Premier Farnell plc 2008.

TOLERANCES:

UNLESS OTHERWISE SPECIFIED, DIMENSIONS ARE FOR REFERENCE PURPOSES ONLY.

DRAWN BY:	DATE:
Jagan	11/02/08
CHECKED BY:	DATE:
Suresh	11/02/08
APPROVED BY:	DATE:
G.Cook	26/02/08

DRAWING TITLE:

Dual In Line Switches - End Stackable

SIZE A	DWG NO. M10000815	ELECTRONIC FILE EI-EIR_DWG	REV A
SCALE: NTS		U.O.M.: mm (Inches)	SHEET: 2 OF 5



PART NO.

MCEI Series

REVISIONS

ECN #	REV	DESCRIPTION	DRAWN	DATE	CHECKD	DATE	APPRVD	DATE
-	A	RELEASED	Jagan	11/2/08	Suresh	11/2/08	G. C	26/2/08

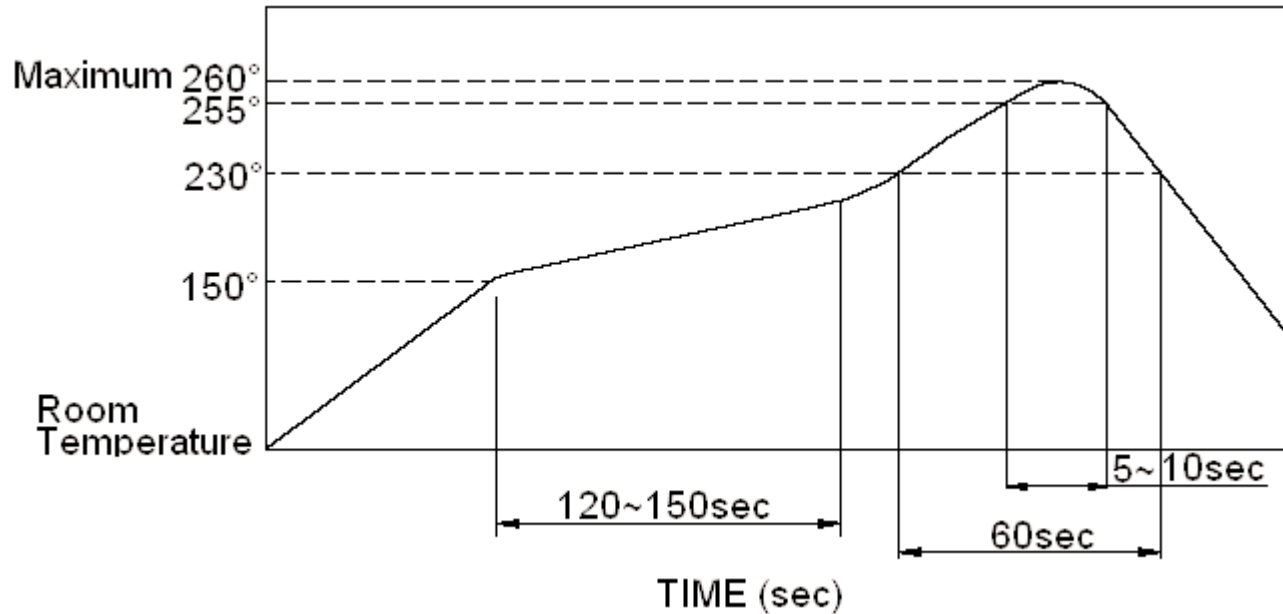

Reflow Temperature Profile

Soldering Process:

Wave soldering: Recommended solder temperature at 500°F (260°C) maximum of 5 seconds for through hole type.

Hand soldering: Use a soldering iron of 30 watts, controlled at 350°C approximately maximum 5 seconds while applying.

Reflow soldering: When applying reflow soldering, the peak temperature or the reflow Oven should be set at 260°C maximum.

Do not wash the switch except top tape sealed type, which suitable for spray cleaning method from top of the s/w.

This data sheet and its contents (the "Information") belong to the Premier Farnell Group (the "Group") or are licensed to it. No licence is granted for the use of it other than for information purposes in connection with the products to which it relates. No licence of any intellectual property rights is granted. The Information is subject to change without notice and replaces all data sheets previously supplied. The Information supplied is believed to be accurate but the Group assumes no responsibility for its accuracy or completeness, any error in or omission from it or for any use made of it. Users of this data sheet should check for themselves the Information and the suitability of the products for their purpose and not make any assumptions based on information included or omitted. Liability for loss or damage resulting from any reliance on the Information or use of it (including liability resulting from negligence or where the Group was aware of the possibility of such loss or damage arising) is excluded. This will not operate to limit or restrict the Group's liability for death or personal injury resulting from its negligence. SPC MULTICOMP is the registered trademark of the Group. © Premier Farnell plc 2008.

TOLERANCES:

UNLESS OTHERWISE SPECIFIED, DIMENSIONS ARE FOR REFERENCE PURPOSES ONLY.

DRAWN BY:	DATE:
Jagan	11/02/08
CHECKED BY:	DATE:
Suresh	11/02/08
APPROVED BY:	DATE:
G.Cook	26/02/08

DRAWING TITLE:

Dual In Line Switches - End Stackable

SIZE A	DWG NO. M10000815	ELECTRONIC FILE EI-EIR_DWG	REV A
SCALE: NTS		U.O.M.: mm (Inches)	SHEET: 3 OF 5



PART NO.

MCEI Series

REVISIONS

ECN #	REV	DESCRIPTION	DRAWN	DATE	CHECKD	DATE	APPRVD	DATE
-	A	RELEASED	Jagan	11/2/08	Suresh	11/2/08	G. C	26/2/08

Specification Table

Number of Positions	Dimensions (A)	Dimensions (B)	Part Number
2	4.98 (0.196)	2.54 (0.100)	MCEI-02
3	7.52 (0.296)	5.08 (0.100)	MCEI-03
4	10.06 (0.396)	7.62 (0.300)	MCEI-04
5	12.60 (0.496)	10.16 (0.400)	MCEI-05
6	15.14 (0.596)	12.70 (0.500)	MCEI-06
7	17.68 (0.696)	15.24 (0.600)	MCEI-07
8	20.22 (0.796)	17.78 (0.700)	MCEI-08
9	22.76 (0.896)	20.32 (0.800)	MCEI-09
10	25.3 (0.996)	22.86 (0.900)	MCEI-10
12	30.38 (1.196)	27.94 (1.190)	MCEI-12
2	4.98 (0.196)	2.54 (0.100)	MCEIR-02
3	7.52 (0.296)	5.08 (0.100)	MCEIR-03
4	10.06 (0.396)	7.62 (0.300)	MCEIR-04
5	12.60 (0.496)	10.16 (0.400)	MCEIR-05
6	15.14 (0.596)	12.70 (0.500)	MCEIR-06
7	17.68 (0.696)	15.24 (0.600)	MCEIR-07
8	20.22 (0.796)	17.78 (0.700)	MCEIR-08
9	22.76 (0.896)	20.32 (0.800)	MCEIR-09
10	25.3 (0.996)	22.86 (0.900)	MCEIR-10
12	30.38 (1.196)	27.94 (1.190)	MCEIR-12

Dimensions : Millimetres (Inches)

This data sheet and its contents (the "Information") belong to the Premier Farnell Group (the "Group") or are licensed to it. No licence is granted for the use of it other than for information purposes in connection with the products to which it relates. No licence of any intellectual property rights is granted. The Information is subject to change without notice and replaces all data sheets previously supplied. The Information supplied is believed to be accurate but the Group assumes no responsibility for its accuracy or completeness, any error in or omission from it or for any use made of it. Users of this data sheet should check for themselves the Information and the suitability of the products for their purpose and not make any assumptions based on information included or omitted. Liability for loss or damage resulting from any reliance on the Information or use of it (including liability resulting from negligence or where the Group was aware of the possibility of such loss or damage arising) is excluded. This will not operate to limit or restrict the Group's liability for death or personal injury resulting from its negligence. SPC MULTICOMP is the registered trademark of the Group. © Premier Farnell plc 2008.

TOLERANCES:
UNLESS OTHERWISE SPECIFIED, DIMENSIONS ARE FOR REFERENCE PURPOSES ONLY.

DRAWN BY:	DATE:
Jagan	11/02/08
CHECKED BY:	DATE:
Suresh	11/02/08
APPROVED BY:	DATE:
G.Cook	26/02/08

DRAWING TITLE:			
Dual In Line Switches - End Stackable			
SIZE	DWG NO.	ELECTRONIC FILE	REV
A	M10000815	EI-EIR_DWG	A
SCALE: NTS		U.O.M.: mm (Inches)	SHEET: 4 OF 5



PART NO.

MCEI Series

REVISIONS

ECN #	REV	DESCRIPTION	DRAWN	DATE	CHECKD	DATE	APPRVD	DATE
-	A	RELEASED	Jagan	11/2/08	Suresh	11/2/08	G. C	26/2/08

Part Number Explanation:

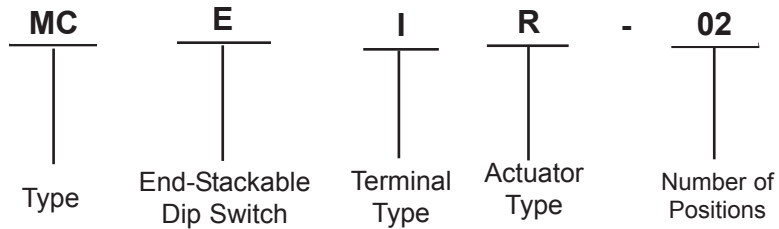

- Terminal Type** : I = Through Hole Type.
- Actuator Type** : R = Recessed Actuator.
 = Raised Actuator.
- Number of Positions** : 02, 03, 04, 05, 06, 07, 08, 09, 10, 12 Positions.

<http://www.farnell.com>
<http://www.newark.com>
<http://www.cpc.co.uk>

This data sheet and its contents (the "Information") belong to the Premier Farnell Group (the "Group") or are licensed to it. No licence is granted for the use of it other than for information purposes in connection with the products to which it relates. No licence of any intellectual property rights is granted. The Information is subject to change without notice and replaces all data sheets previously supplied. The Information supplied is believed to be accurate but the Group assumes no responsibility for its accuracy or completeness, any error in or omission from it or for any use made of it. Users of this data sheet should check for themselves the Information and the suitability of the products for their purpose and not make any assumptions based on information included or omitted. Liability for loss or damage resulting from any reliance on the Information or use of it (including liability resulting from negligence or where the Group was aware of the possibility of such loss or damage arising) is excluded. This will not operate to limit or restrict the Group's liability for death or personal injury resulting from its negligence. SPC MULTICOMP is the registered trademark of the Group. © Premier Farnell plc 2008.

TOLERANCES:
UNLESS OTHERWISE SPECIFIED, DIMENSIONS ARE FOR REFERENCE PURPOSES ONLY.

DRAWN BY:	DATE:
Jagan	11/02/08
CHECKED BY:	DATE:
Suresh	11/02/08
APPROVED BY:	DATE:
G.Cook	26/02/08

DRAWING TITLE:			
Dual In Line Switches - End Stackable			
SIZE	DWG NO.	ELECTRONIC FILE	REV
A	M10000815	EI-EIR_DWG	A
SCALE: NTS		U.O.M.: mm (Inches)	SHEET: 5 OF 5