

	Ref	Puissance	Primaire	Fusible	Secondaire	ta
UI 48x17	45067	40VA	115-230V	400/200	2x6V	50/B
	45068	40VA	115-230V	400/200	2x9V	50/B
	45069	40VA	115-230V	400/200	2x12V	50/B
	45070	40VA	115-230V	400/200	2x15V	50/B
	45071	40VA	115-230V	400/200	2x18V	50/B
UI 48x26	45072	40VA	115-230V	400/200	2x24V	50/B
	45073	60VA	115-230V	630/315	2x6V	50/B
	45074	60VA	115-230V	630/315	2x9V	50/B
	45075	60VA	115-230V	630/315	2x12V	50/B
	45076	60VA	115-230V	630/315	2x15V	50/B
	45077	60VA	115-230V	630/315	2x18V	50/B
	45078	60VA	115-230V	630/315	2x24V	50/B

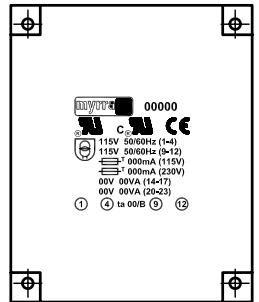
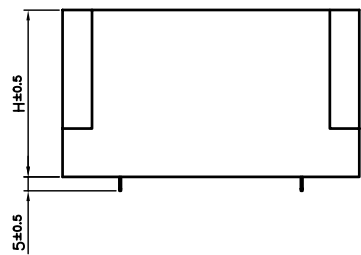
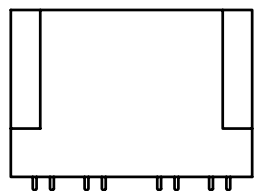

Format	A	B	H
UI 48x17	70	83	38.5
UI 48x26	69.8	85.8	48.3

Rev	Date	Modification	Dessiné	Visa

Finition:		Tolérance générale:	
Finition:		General tolerance:	
Ech: 1:1	Matière:		
	Material:		
Dessiné par: ROUSSEL.Ch	Date: 20/10/2003	Visa: J.P.M.	
<b>TRANSFORMATEURS UI 48</b>			
		22 Allée du Clos des Charmes Z.A. Les Portes de la Forêt 77090 COLLEGIEN Tel : 01-60-37-55-55 Fax : 01-60-17-12-00	<b>UI 48</b>