

FILTERING

FLAT CABLE FERRITES

EFC-25-N/S
EFC-50-N/S

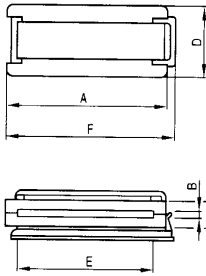

EFC-40-N/S
BCN-26
BCN-50
BCN-40

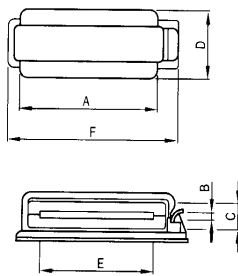

Snap on type mounting
hole and pitch

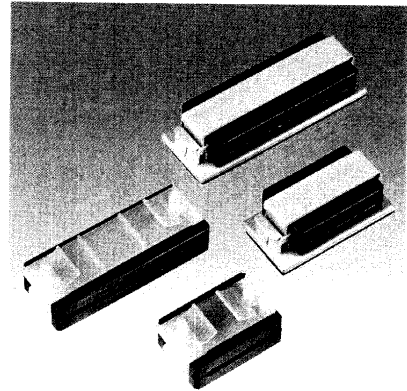
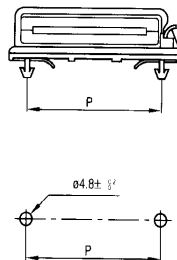

Features

- Split construction permits easy insertion of cables already wired and installed, or cables with connectors.
- Nylon mounting clamp comes with.
- Split block cores supported with plastic mounting clamp for flat cables

Applications

- For noise problems arising in office automation equipment or other digital equipment.

Part No.	Unit: mm							Impedance (Ω)		Applicable cable
	A	B	C	D	E	F	P	25MHz	100MHz	
EFC-25S	44.0	2.0	13.0	28.5	33.0	47.0	33.0	65	150	flat cable Less than the dimension E
EFC-25N	44.0	2.0	13.0	28.5	33.0	47.0	-	65	150	
EFC-40S	63.0	2.0	13.0	28.5	52.0	77.0	64.5	72	175	
EFC-40N	63.0	2.0	13.0	28.5	52.4	77.0	-	72	175	
EFC-50S	76.5	2.0	13.0	28.5	64.5	79.5	64.5	62	185	
EFC-50N	76.5	2.0	13.0	28.5	64.5	79.5	-	62	185	
BCN-26	45.0	2.0	13.0	28.5	34.0	59.0	-	92	180	
BCN-40	63.0	2.0	13.0	28.5	52.0	76.5	-	72	180	
BCN-50	76.5	2.0	13.0	28.5	64.5	90.7	-	63	185	

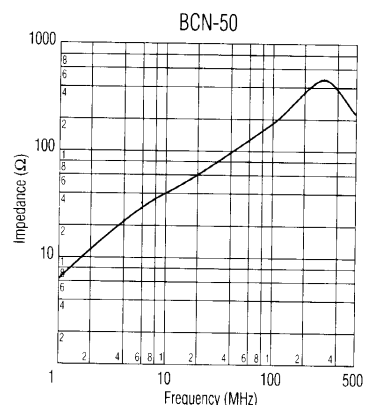
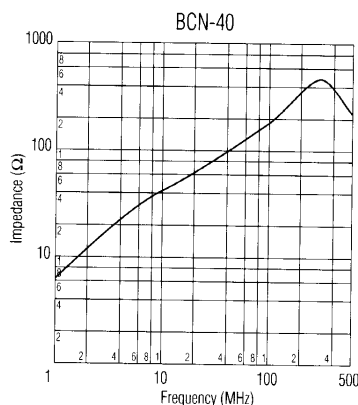
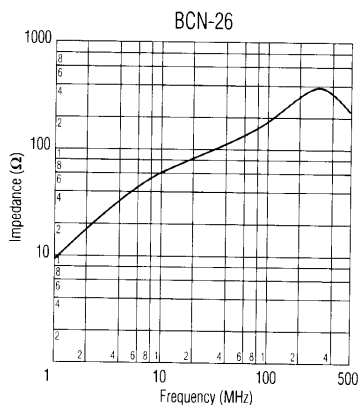
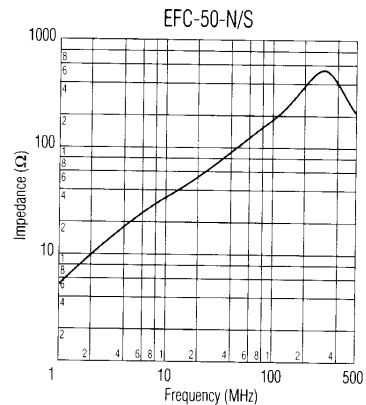
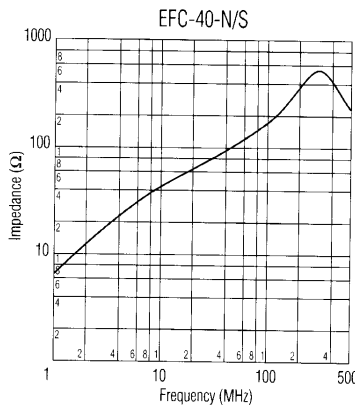
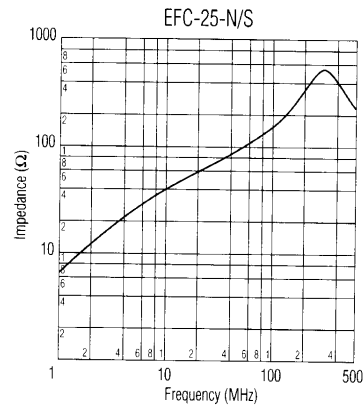

FILTERING

FLAT CABLE FERRITES

Features

- Kitagawa offers a line of bisected flat cable suppression cores to attenuate radiated EMI emissions from ribbon cables.
- Ferrite assembly press-fitted into a pair of metal clips.

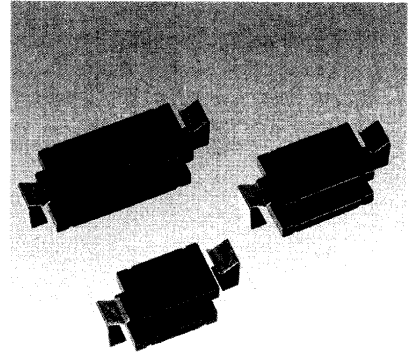
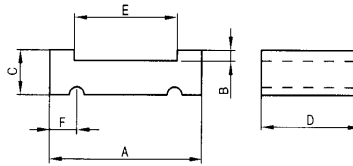

Applications

- Internal ribbon cables between PCB and Data line.
- To suppress radiated EMI emission from flat cable and ribbon cable.

Part No.	Unit: mm						Impedance (Ω)	
	A	B	C	D	E	F	25MHz	100MHz
FP 16,5x2x10,25	16,5	0,6	2,0	10,25	12,5	-	29	72
FP 38,0x6,35x25,4*	38,0	0,8	10,51	25,4	26,6	6,25	103	173
FP 45,0x6,35x28,5*	45,0	0,8	6,35	28,5	34,4	6,25	84	166
FP 55,1x6,35x28,5*	55,1	0,8	6,35	28,5	43,7	6,25	78	179
FP 63,5x6,35x28,5*	63,5	0,8	6,35	28,5	52,0	6,25	74	155
FP 76,2x6,35x28,5*	76,2	0,85	6,35	28,5	65,3	6,25	72	200

*Metal clamp fittings are included.

