

THIS DRAWING IS UNPUBLISHED.

RELEASED FOR PUBLICATION

10AUG , 2005.

© COPYRIGHT 2005 BY TYCO ELECTRONICS CORPORATION. ALL RIGHTS RESERVED.

LOC	DIST	REVISIONS					
		P	LTR	DESCRIPTION	DATE	DWN	APVD
E	B		A	FIRST ISSUE	10AUG05	KR	FWK

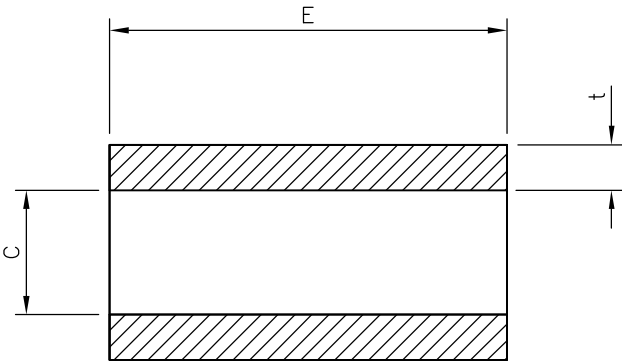
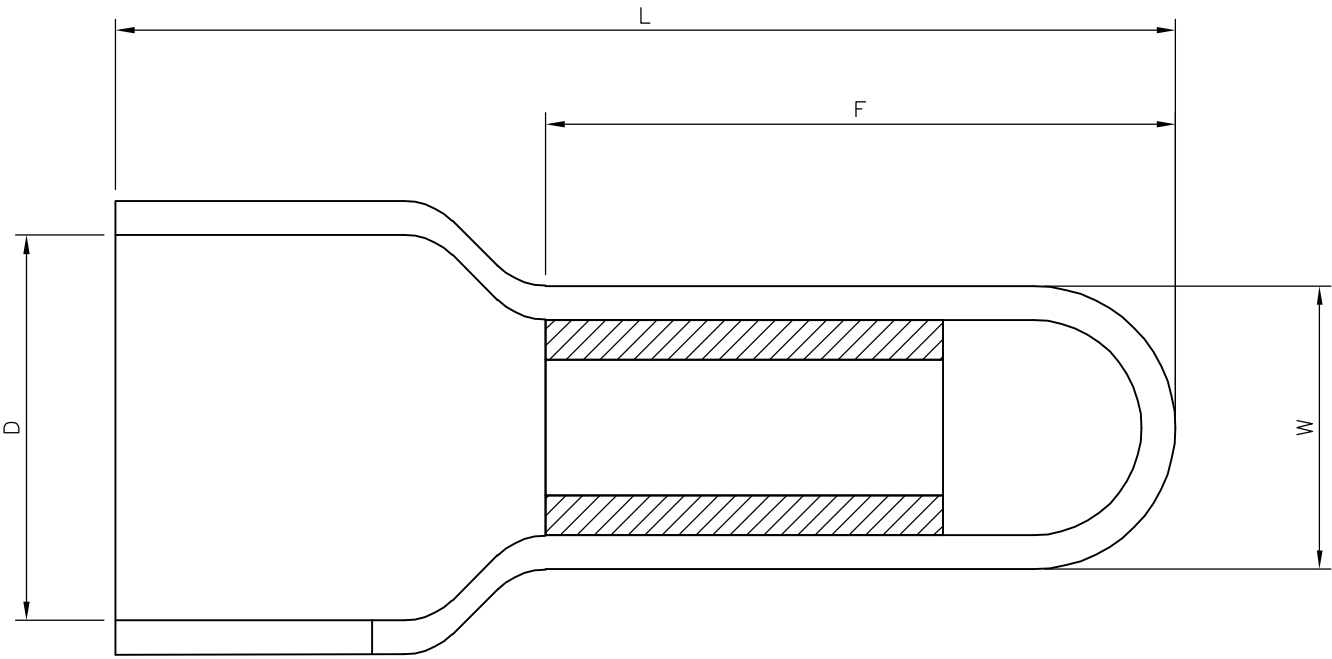

- NOTES:
- FOR TECHNICAL DATA REFER TO YOUR LOCAL TYCO ELECTRONICS SALES OFFICE.
  - ALL DIMENSIONS ARE NOMINAL FOR REFERENCE ONLY UNLESS OTHERWISE STATED.
  - FOR PACKAGING DETAILS SEE SHEET 2.
  - MATERIAL: BODY – COPPER  
SLEEVE – PVC (K65), 94V-0

2-1838205-0	0.5mmsq – 1.5mmsq 22-16(AWG)	2.4x14mm STANDARD ENTRY	END CONNECTOR (INSULATED)	2000	1000	5.00	18.10	10.60	6.00	7.00	0.35	2.70	0.5mmsq – 1.5mmsq 22-16(AWG)	END CONNECTOR (INSULATED)	2-1838205-0				
1-1838205-0				3500	100										1-1838205-0				
STOCK NUMBER	PACKING LABEL DESCRIPTION LINE 3	PACKING LABEL DESCRIPTION LINE 2	PACKING LABEL DESCRIPTION LINE 1	INNER CARTON QTY	QTY	W (±0.20)	L (+0.20 -0	F (±0.20)	D (±0.20)	E (±0.20)	t (±0.05)	C (±0.10)	WIRE SIZE (mmsq) & (AWG)	DESCRIPTION	PART No				
						DIMENSIONS													
								THIS DRAWING IS A CONTROLLED DOCUMENT.		DWN K.Raghunandan		10AUG05		<b>tyco</b> <b>Electronics</b> Tyco Electronics Corporation Bideford, UK, EX39 4HE					
										CHK S. Parlow		12/04/07							
								DIMENSIONS: mm		TOLERANCES UNLESS OTHERWISE SPECIFIED:		APVD F. Wheeler-King		12/04/07		NAME			
										0 PLC ± 0.5		PRODUCT SPEC		EURO-CRIMP INSULATED END CONNECTOR 0.5mmsq – 1.5mmsq / 22-16 AWG RANGE					
										1 PLC ± 0.2		—							
								2 PLC ± 0.1		APPLICATION SPEC		SIZE		CAGE CODE		DRAWING NO		RESTRICTED TO	
								3 PLC ± 0.015		—		A2		00779		C=1838205		—	
								4 PLC ± -		WEIGHT —									
								ANGLES ± -		CUSTOMER DRAWING		SCALE		NTS		SHEET		1 OF 2	
								FINISH —										REV A	

