

Model No.	POS.1	POS.2	POS.3
2MS2	ON	NONE	MOM
Term. Comm.	2-3	OPEN	2-1
SCHEMATIC			

SWITCH FUNCTION

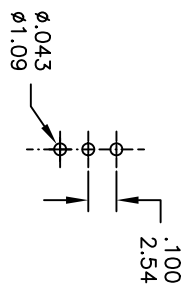
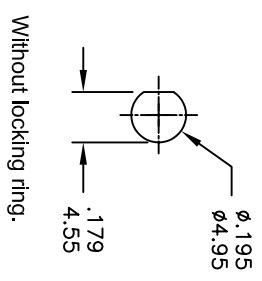

PANEL MOUNTING

P.C. MOUNTING

SPECIFICATIONS

ELECTRICAL LIFE: 30,000 make-and-break cycles at full load.
CONTACT RESISTANCE: 20m Ω max. Initial @ 2-4VDC
 100mA for both silver and gold plated contacts.
INSULATION RESISTANCE: 1,000M Ω min.
DIELECTRIC STRENGTH: 1,000 V RMS@sea level.
OPERATING TEMPERATURE: -30° C to 85° C.

MATERIALS

CASE - Diallyl phthalate(DAPY UL94V-0)
ACTUATOR - Brass, chrome plated
BUSHING - Brass, nickel plated
HOUSING - Stainless Steel
SWITCH SUPPORT - Brass, tin plated.
TERMINALS/CONTACT - Brass, with Silver or gold plated.

RATING :

R : 0.4 Volt-Amps(VA) max. @20V max.(AC or DC)
 Q : 1Amp @250VAC
 3Amps @120 VAC or 28 VDC

符號	原尺寸	修改後尺寸	變更日期
1 (A)			
2 (B)			
3 (C)			
4 (D)			
5 (E)			

SCALE (比例) :	3 : 2
TOLERANCE (公差) :	0.00 mm ± 0.25mm
	0.0 mm ± 0.40mm
ANGULAR :	± 2.54 mm
FILE NAME :	2MSP0099

TITLE 圖名	Sub - Miniature Toggle Switches	SIZE 圖紙	A4
DWG NO. 圖號	2MS2T2B2M2RE	UNIT 單位	inch mm
REV. 版本	A	DATE 日期	APR - 23 - 2003
CHECKED BY 審核	JACK	DRAWN BY 製圖	BLUE
		SHEET 張數	1 of 1

德利威電子股份有限公司
DAILYWELL ELECTRONICS CO.,LTD.