

Modular Terminal Blocks with Fixing Flange or Snap-in Mounting Foot 1.5 mm² / AWG 16, Series 260

Test plug modules see page 10.28	0.08 – 1.5 mm² 400 V/6 kV/3 ① 18 A	AWG 28 – 16 300 V, 10 A 300 V, 15 A	2 x 0.08 – 1.5 mm² 400 V/6 kV/3 ① 18 A	2 x AWG 28 – 16 300 V, 10 A 300 V, 15 A
	Terminal block width 5 mm / 0.197 in 8 – 9 mm / 0.33 in		Terminal block width 8 mm / 0.315 in 8 – 9 mm / 0.33 in	
*		*		

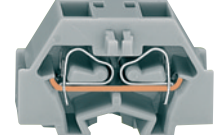

① 400 V = rated voltage
 6 kV = rated surge voltage
 3 = pollution degree
 (see also section 15)

Description	Color	Item No.	Pack.-unit pcs	Color	Item No.	Pack.-unit pcs
Terminal blocks with fixing flange, for screw fixing or similar methods, fixing hole diameter 3.2 mm (with mounting adapter 209-123 also for DIN 35 rail)	2-conductor terminal blocks			4-conductor terminal blocks		
	grey	260-301	300 (6 x 50)	grey	260-331	300 (6 x 50)
	light grey	260-303	300 (6 x 50)	light grey	260-333	300 (6 x 50)
	blue	260-304	300 (6 x 50)	blue	260-334	300 (6 x 50)
	orange	260-306	300 (6 x 50)	orange	260-336	300 (6 x 50)
Terminal blocks with snap-in mounting foot, for plate thickness 0.6 – 1.2 mm, fixing hole diameter 3.5 mm (fits aluminum rail 210-154 or with mounting adapter 209-120 for DIN 35 rail)	2-conductor terminal blocks			4-conductor terminal blocks		
	grey	260-311	300 (6 x 50)	grey	260-341	300 (6 x 50)
	light grey	260-313	300 (6 x 50)	light grey	260-343	300 (6 x 50)
	blue	260-314	300 (6 x 50)	blue	260-344	300 (6 x 50)
	orange	260-316	300 (6 x 50)	orange	260-346	300 (6 x 50)
End terminal block ②, without fixing foot, for terminal strips with snap-in mounting feet (see dimensioned drawings on page 10.19)	2-conductor terminal blocks			4-conductor terminal blocks		
	grey	260-321	300 (6 x 50)	grey	260-351	300 (6 x 50)
	light grey	260-323	300 (6 x 50)	light grey	260-353	300 (6 x 50)
	blue	260-324	300 (6 x 50)	blue	260-354	300 (6 x 50)
	orange	260-326	300 (6 x 50)	orange	260-356	300 (6 x 50)
	green-yellow	260-327	300 (6 x 50)	green-yellow	260-357	300 (6 x 50)

Accessories for modular terminal blocks and terminal strips (Marking accessories see section 14)

	End plate with fixing flange	grey	260-361	100 (2 x 50)	grey	260-361	100 (2 x 50)
	End plate with snap-in mounting foot	grey	260-371	100 (2 x 50)	grey	260-371	100 (2 x 50)
	Comb type jumper bar, insulated, 2-way	I _N 10 A grey	260-402	25	I _N 10 A grey	260-402	25
	Operating tool, insulated, for connecting the comb type jumper bar	2-way	209-132	1	2-way	209-132	1
	Aluminum carrier rail, 1000 x 18 x 7 mm 3'3" x 0.709 x 0.276 in		210-154	1		210-154	1
	Plastic end stop, with WSB marking facility, for aluminum rail 210-154	6 mm / 0.236 in wide grey	209-122	25	6 mm / 0.236 in wide grey	209-122	25
	Mounting adapter, for terminal blocks with snap-in mounting foot, for DIN 35 rail	6 mm / 0.236 in wide grey	209-120	25	6 mm / 0.236 in wide grey	209-120	25
	Mounting adapter with screw, for terminal blocks with fixing flange, for DIN 35 rail	6 mm / 0.236 in wide grey	209-123	25	6 mm / 0.236 in wide grey	209-123	25
	Mounting adapter for DIN 35 rail, can be used as end stop	6.5 mm / 0.256 in wide grey	209-137	25	6.5 mm / 0.256 in wide grey	209-137	25

* For further approvals with corresponding ratings see section 15.