



22

IP68

BUCCANEER "MINI" SEALED CONNECTOR

BULGIN

Electrical + Electronic Components

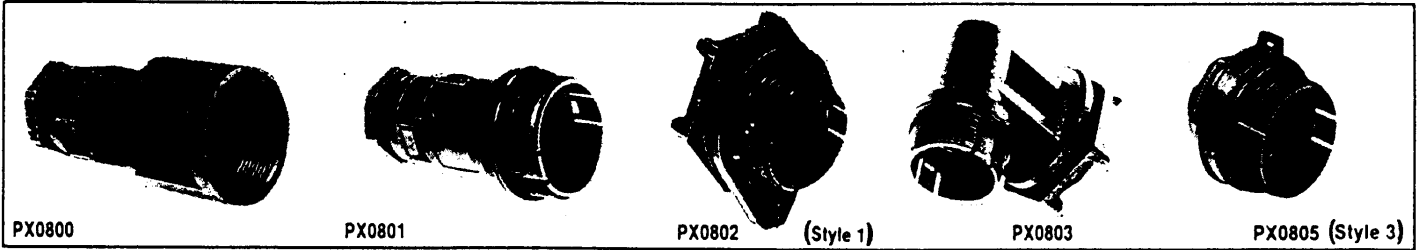

A family of small circular connectors designed for a wide range of applications. Any of the six bodies can accept either 3 or 8 way contact carriers which simply 'snap-fit' into the body after insertion of contacts. The carriers feature a designated leading Earth contact position.

- ★ IP68 sealed against dust and water.
- ★ Choice of Solder or Crimp termination.
- ★ Gold plated contacts.
- ★ 3 and 8 way versions.
- ★ 8 Way type may be selectively loaded up to 8 way.
- ★ Polarizing/Blanking pins available.

TECHNICAL DATA:-

Max. Rating: 5A. 380V. a.c.
 Contact Resistance (Initial): < 5mΩ .
 Insulation Resistance: > 10⁶MΩ . (@ 500V. d.c.).
 Voltage Proof: 2 kV. (@ 50Hz).
 Operating Temperature: -20°C to +70°C.

Insertion/Withdrawal Force (Typical),

Assembled Plugs & Sockets:

Insertion	Withdrawal
3 Way: 0.5 Kgf.	3 Way: 0.3 Kgf.
8 Way: 1.4 Kgf.	8 Way: 1.2 Kgf.

MATERIALS:-

Housing Mouldings & Carriers: Nylon. U.L. 94V-0.
 Contacts: Copper Alloy, gold plated (0.1µm) on nickel.

CABLE ACCEPTANCE:-

Sheath Sizes:

- ø 5 - 7mm Standard (PX0800, PX0801).
- ø 6 - 8mm Optional (PX0800/06, PX0801/06).
- ø 7 - 9mm Optional (PX0800/07, PX0801/07).

Conductors: 0.2 - 0.5mm² (20-24 AWG).

NOTE: Main body unit, contact carriers and contact pins/sockets must be ordered separately:-

MAIN BODIES & Accessories	
List No.	Description
PX0800	Flex Mounting
PX0801	Flex mounting In-Line.
PX0802	Chassis/Panel mounting. (Style 1)
PX0803	Side entry chassis/panel mounting.
PX0804	Chassis/Panel mounting. (Style 2 without cap retainer)
PX0805	Chassis/Panel mounting. (Style 3 with cap retainer)
PX0810	Sealing cap and retaining strap fits - PX0801, PX0802, PX0803, PX0805. PX0804 Cap only.
PX0811	Sealing cap and retaining strap fits PX0800.
SA3147	Polarizing pin/blank. Supplied in packs of 10.
SA3150	Insertion tool.
SA2800	Crimping tool.

SOLDER Termination		
Part No.	Description	
SA3148/1	Solder pins. Supplied in packs of 10.	
SA3149/1	Solder sockets. Supplied in packs of 10.	
12734/1	8 Way pin carrier.	Denoted by Black mouldings
12735/1	8 Way socket carrier.	
12734/3/1	3 Way pin carrier.	
12735/3/1	3 Way socket carrier.	

CRIMP Termination		
Part No.	Description	
SA3148	Crimp pins. Supplied in packs of 10.	
SA3149	Crimp sockets. Supplied in packs of 10.	
12734	8 Way pin carrier.	Denoted by Grey mouldings
12735	8 Way socket carrier.	
12734/3	3 Way pin carrier.	
12735/3	3 Way socket carrier.	

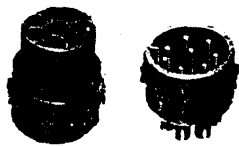
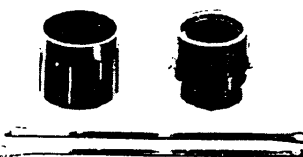
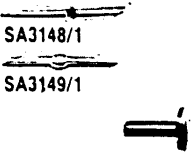
<p>Flex mounting Body shown fitted with carrier & pins.</p>  <p>PX0800 + 12734/1 + SA3148/1</p>	<p>Pin carrier 12734/1 shown fitted with SA3148/1.</p>  <p>12735/1 12734/1</p>	<p>Sealing caps & Retaining Straps.</p>  <p>PX0810 PX0811</p>	<p>Terminations.</p>  <p>SA3148/1 SA3148</p> <p>SA3149/1 SA3149</p> <p>SA3147 Polarizing/Blanking Pin</p>
--	--	--	--

Farnell Electronic Components Ltd.

Canal Road Leeds LS12 2TU

Telephone: 0532 626211 Telex: 55147 F. Fax: 0532 626214

WIRING AND ASSEMBLY INSTRUCTIONS

It is important that these instructions are fully complied with to ensure this product is completely Watertight and Electrically safe.

ASSEMBLY NOTES

Cable and Wiring:

Always wire socket carrier (female) to supply source and pin carriers (male) to appliance or load.

Pin or Socket carriers may be fitted to any main body to provide desired configuration.

Standard gland supplied fits cable sheaths of 5-7mm dia. Optional glands are available for 6-8mm or 7-9mm dia. cable sheaths (see overleaf).

For mains supply, 3 wire systems, always connect:

Brown	to "L" Terminal.
Blue	to "N" Terminal.
Green/Yellow	to "E" Terminal.

For correct sealing ensure all surfaces are free of contamination (dust, grease etc.)

Use only circular sheathed cable. Gland nut must be securely tightened to both seal and clamp cable.

ASSEMBLY:

1. Strip outer sheath and inner conductors to dimensions shown.
2. Thread cable as illustrated.
3. After soldering or crimping contacts, load into appropriate carrier using insertion tool SA3150.
4. Mount polarizing/blanking pins if required.
5. Push carrier firmly home ensuring it is seated on "O" ring and locking tabs snap into place.
6. Assemble gland, cage and gland nut.

Assembly Torques (Minimum)

Flex Mounting &
 In-Line: Gland Nut 0.23Nm min. 0.45Nm max.
 Chassis/Panel &
 Side Entry: Rear Nut 0.7Nm min. 1.7Nm max.
 Sealing Caps &
 Locking Ring: 0.23Nm min. 1.13Nm max.

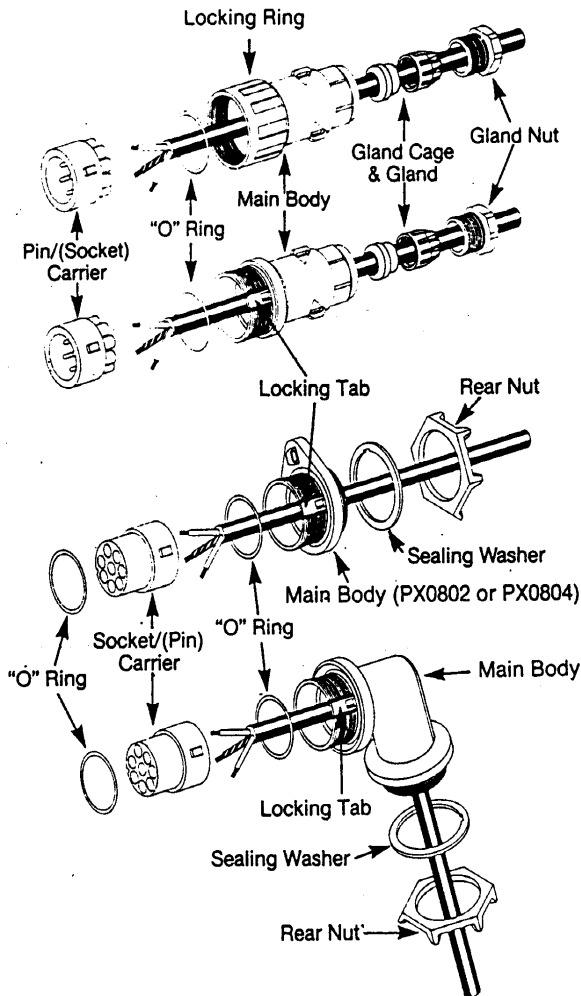

ALL 'O' RINGS ARE PRE-FITTED

Sealing Caps:

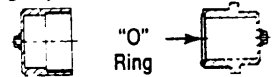

PX0810 Fits PX0801, PX0802, PX0803, PX0804 & PX0805. Ensure "O" Ring is in place on main body male thread.

PX0811 Fits PX0800. Ensure "O" Ring is in place in cap.

SA3150 Insertion Tool

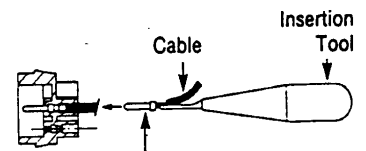

After soldering or crimping, load contact onto insertion tool SA3150 and push fully home into carrier.

Cable Stripping Dimensions

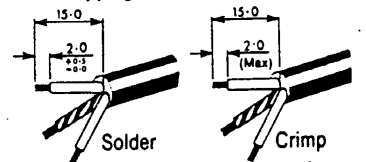

Polarizing/Blanking Pins SA3147

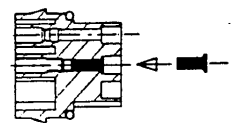

N.B. Once inserted Pins/Sockets cannot be removed and subsequently replaced without changing the carrier moulding.

Dimensions:

