

### Features:

- \* Universal AC Input 90—264Vac
- \* Low ripple & noise
- \* No minimum load requirement
- \* 100% burn in test
- \* 1 year warranty
- \* Safety: UL, cUL, GS, CB, CE, FCC



### SPECIFICATION:

| MODEL NO.                           | 3A-161DA-05  | 3A-161DA-06                | 3A-161DA-07                | 3A-161DA-09                  | 3A-161DA-12              | 3A-161DA-15                  | 3A-161DA-18               | 3A-161DA-20              | 3A-161DA-24              |
|-------------------------------------|--|----------------------------|----------------------------|------------------------------|--------------------------|------------------------------|---------------------------|--------------------------|--------------------------|
| PART NO.                            | T3586ST  | T3587ST                    | T33588ST                   | T3589ST                      | T3590ST                  | T3591ST                      | T3592ST                   | T3593ST                  | T3594ST                  |
| <b>OUTPUT:</b>                      |  |                            |                            |                              |                          |                              |                           |                          |                          |
| Voltage                             | 5VDC   | 6VDC                       | 7VDC                       | 9VDC                         | 12VDC                    | 15VDC                        | 18VDC                     | 20VDC                    | 24VDC                    |
| Current (Max)                       | 2.6A   | 2.5A                       | 2.14A                      | 1.7A                         | 1.25A                    | 1.0A                         | 0.83A                     | 0.75A                    | 0.625A                   |
| Current (Min)                       | 0A   |                            |                            |                              |                          |                              |                           |                          |                          |
| Line Regulation                     | +/-1%  |                            |                            |                              |                          |                              |                           |                          |                          |
| Load Regulation                     | +/-5%  |                            |                            |                              |                          |                              |                           |                          |                          |
| Over Voltage Protection             | 6.46 –7.14VDC<br>O/P Shutdown                              | 7.1-7.9VDC<br>O/P Shutdown | 8.5-9.4VDC<br>O/P Shutdown | 11.4-12.6VDC<br>O/P Shutdown | 15-18VDC<br>O/P Shutdown | 17.1-18.9VDC<br>O/P Shutdown | 19-21vVDC<br>O/P Shutdown | 21-24VDC<br>O/P Shutdown | 25-27VDC<br>O/P Shutdown |
| Short Circuit Protection            | O/P Shutdown<br>Auto Restart                               |                            |                            |                              |                          |                              |                           |                          |                          |
| Ripple Voltage (L.F)                | 150mV p-p  |                            |                            |                              |                          |                              |                           |                          |                          |
| O/P Connector<br>( 1.8M Jack Lead ) | 2.1x5.5x12mm<br>Centre +VE                                 |                            |                            |                              |                          |                              |                           |                          |                          |
| <b>SAFETY:</b>                      |  |                            |                            |                              |                          |                              |                           |                          |                          |
| Hi Pot Test I/P-O/P                 | 3KVAC or<br>4242VDC  |                            |                            |                              |                          |                              |                           |                          |                          |
| Insulation I/P-O/P                  | 100Mohm  |                            |                            |                              |                          |                              |                           |                          |                          |
| <b>TEMPERATURE:</b>                 |  |                            |                            |                              |                          |                              |                           |                          |                          |
| Operating                           | 0° to 40°C   |                            |                            |                              |                          |                              |                           |                          |                          |
| Storage                             | -10°C to 75°C  |                            |                            |                              |                          |                              |                           |                          |                          |
| <b>HUMIDITY:</b>                    |  |                            |                            |                              |                          |                              |                           |                          |                          |
| Operating                           | 20 to 85% Non Condensing                                   |                            |                            |                              |                          |                              |                           |                          |                          |
| Storage                             | -10 to 95% Non Condensing                                  |                            |                            |                              |                          |                              |                           |                          |                          |
| <b>INPUT:</b>                       |  |                            |                            |                              |                          |                              |                           |                          |                          |
| Voltage                             | 90 to 264VAC   |                            |                            |                              |                          |                              |                           |                          |                          |
| Frequency                           | 47 to 63Hz   |                            |                            |                              |                          |                              |                           |                          |                          |
| Current RMS (Max)                   | 600mA  |                            |                            |                              |                          |                              |                           |                          |                          |
| Inrush Current                      | 30/60A   |                            |                            |                              |                          |                              |                           |                          |                          |
| Leakage Current                     | 0.25mA   |                            |                            |                              |                          |                              |                           |                          |                          |
| Efficiency (Min)                    | 60%  |                            |                            |                              |                          |                              |                           |                          |                          |
| MTBF                                | 50K Hours  |                            |                            |                              |                          |                              |                           |                          |                          |
| Safety                              | UL 60950-1, CSA C22.2 No. 60950-1, EN 60950-1, IEC 60950-1 |                            |                            |                              |                          |                              |                           |                          |                          |
| Additional Safety                   | PSE  | PSE                        | PSE                        | PSE                          | PSE                      | PSE                          |                           |                          |                          |
| EMI                                 | FCC CFR 47 PART 15, EN 55022, EN 61000-3                   |                            |                            |                              |                          |                              |                           |                          |                          |
| EMS                                 | EN 50024 (EN 61204-3), EN 61000-4                          |                            |                            |                              |                          |                              |                           |                          |                          |

1 ARKWRIGHT ROAD, READING, BERKS. RG2 0LU

TEL: 0118 9311199

FAX: 0118 9311145

E-Mail: [info@stontronics.co.uk](mailto:info@stontronics.co.uk) [www.stontronics.co.uk](http://www.stontronics.co.uk)

Dimensions:

Weight: 150g Approx.

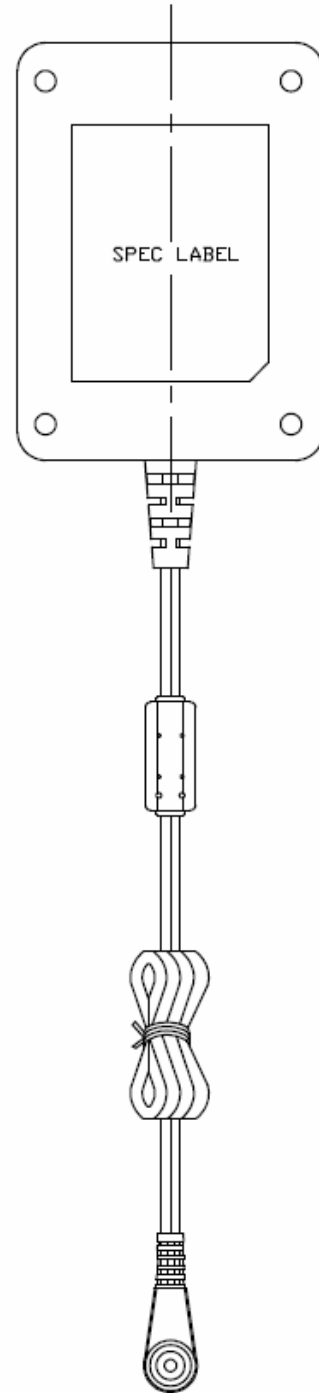
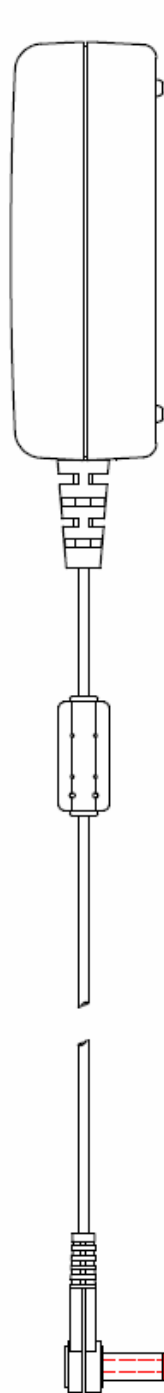
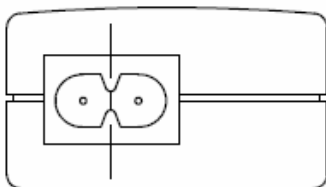
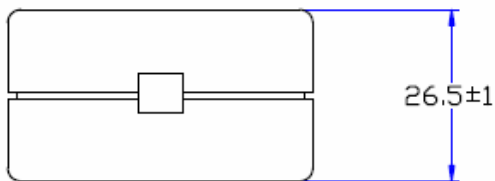
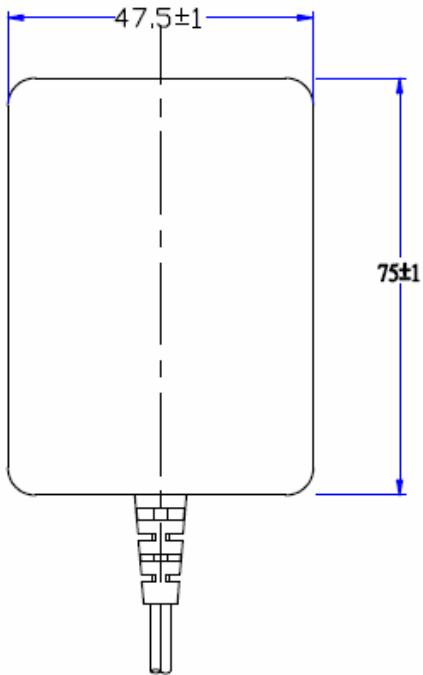

**1 ARKWRIGHT ROAD, READING, BERKS. RG2 0LU**

**TEL: 0118 9311199**

**FAX: 0118 9311145**

**E-Mail: [info@stontronics.co.uk](mailto:info@stontronics.co.uk) [www.stontronics.co.uk](http://www.stontronics.co.uk)**