

Type: **ZB150-150**  
 Article No.: **278466**  
 Sales text **Overload relay 120-150**

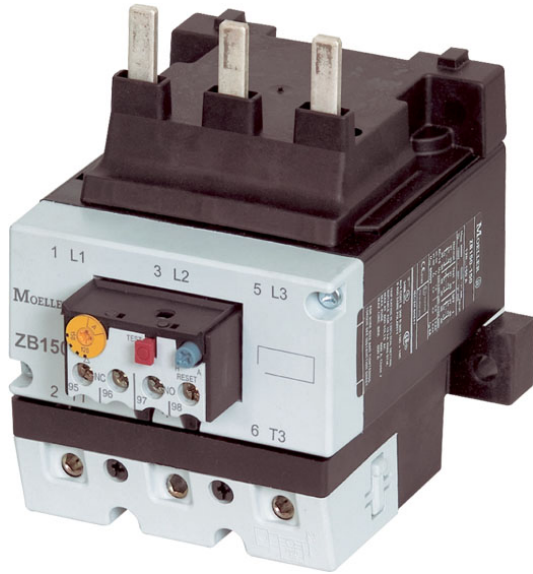

Phase failure sensitivity to IEC/EN 60947, VDE 0660 Part 102

For direct mounting

Ordering information			
Description			Direct fitting
Overload releases	$I_r$	A	120...150
Auxiliary contacts			
N/O = Normally open			1 N/O
N/C = Normally closed			1 N/C
For use with			DILM80, DILM95, DILM115, DILM150, DILM170 DIULM80, DIULM95, DIULM115, DIULM150, SDAINLM140, SDAINLM165, SDAINLM200, SDAINLM260
Short-circuit protection			
Type "1" coordination	gG/gL	A	315
Type "2" coordination	gG/gL	A	250

**Contact sequence**

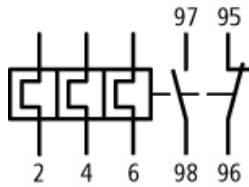

## Note concerning the product

Overload release: tripping class 10 A

Short-circuit protection: Observe the maximum permissible fuse of the contactor with direct device mounting.

Suitable for protection of EEx e-motors.



PTB 04 ATEX 3022

Observe manual AWB2300-1545D/GB.

General			
Standards			IEC/EN 60947, VDE 0660, UL, CSA
Climatic proofing			Damp heat, constant, to IEC 60068-2-78; Damp heat, cyclic, to IEC 60068-2-30
Ambient temperature			
Open		°C	-25...55
Enclosed		°C	-25...40
Temperature compensation			Continuous
Mounting position			Engineering selection data
Weights		kg	1.64
Mechanical shock resistance half-sinusoidal shock 10 ms to IEC 60068-2-27		g	10
Protection type			IP00
Protection against direct contact when actuated from front (IEC 536)			Finger- and back-of-hand proof
Main conducting paths			
Rated impulse withstand voltage	$U_{imp}$	V AC	8000
Overtoltage category/pollution degree			III/3
Rated insulation voltage			

AC	$U_i$	V AC	1000
Rated operational voltage	$U_e$	V AC	1000
Safe isolation to VDE 0106 Part 101 and Part 101/A1			
Between auxiliary contacts and main contacts		V AC	440
Between main circuits		V AC	440
Overload release setting range		A	25...150
Temperature compensation residual error > 40°C		%/K	0.25
Short-circuit protection Maximum fuse			<u>278462</u>
Current heat loss (3 conductors)			
Lower value of the setting range		W	16
Maximum setting		W	18
Terminal capacities			
Solid		mm <sup>2</sup>	2 × (4 – 16)
Flexible with ferrule		mm <sup>2</sup>	1 × (4 – 70) 2 × (4 – 50)
Stranded		mm <sup>2</sup>	1 × (16...50) 2 × (16...50)
Solid or stranded		AWG	2/0
Terminal screw			M10
Tightening torque		Nm	10
Tools			
Hexagon socket-head spanner	SW	mm	5
<b>Auxiliary and control circuits</b>			
Rated impulse withstand voltage	$U_{imp}$	V	6000
Overtoltage category/pollution degree			III/3
Terminal capacities			
Solid		mm <sup>2</sup>	2 × (0.75 – 2.5)
Flexible with ferrule		mm <sup>2</sup>	2 × (0.5...2.5)
Solid or stranded		AWG	2 × (18 – 12)
Terminal screw			M3.5
Tightening torque		Nm	0.8 – 1.2
Tools			
Pozidriv screwdriver		Size	2
Standard screwdriver		mm	1 × 6
Rated insulation voltage	$U_i$	V AC	500
Rated operational voltage	$U_e$	V AC	500

Safe isolation to VDE 0106 Part 101 and Part 101/A1			
between the auxiliary contacts		V AC	240
Conventional thermal current	$I_{th}$	A	6
Rated operational current			
AC-15			
Make contact			
120 V	$I_e$	A	1,5
240 V	$I_e$	A	1,5
415 V	$I_e$	A	0,5
500 V	$I_e$	A	0,5
Break contact			
120 V	$I_e$	A	1,5
240 V	$I_e$	A	1,5
415 V	$I_e$	A	0,9
500 V	$I_e$	A	0,8
DC-13 L/R – 15 ms			
24 V	$I_e$	A	0,9
60 V	$I_e$	A	0,75
110 V	$I_e$	A	0,4
220 V	$I_e$	A	0,2
Short-circuit rating without welding			
max. fuse		A gG/gL	6

## Notes

### Notes

Ambient temperature:  
Operating range to IEC/EN 60947, PTB:  $-5^{\circ}\text{C}$  to  $+55^{\circ}\text{C}$   
Rated operational current:  
Making and breaking conditions to DC-13, L/R constant as stated  
Main contacts terminal capacity solid and stranded conductors with ferrules: When using 2 conductors use identical cross-section  
See overlay "Fuses" for short-circuit rating time/current characteristic (please enquire)  
6 mm flexible with ferrules to DIN 46228  
Rated operational current DC-13, 60 V: N/O auxiliary

## Dimensions

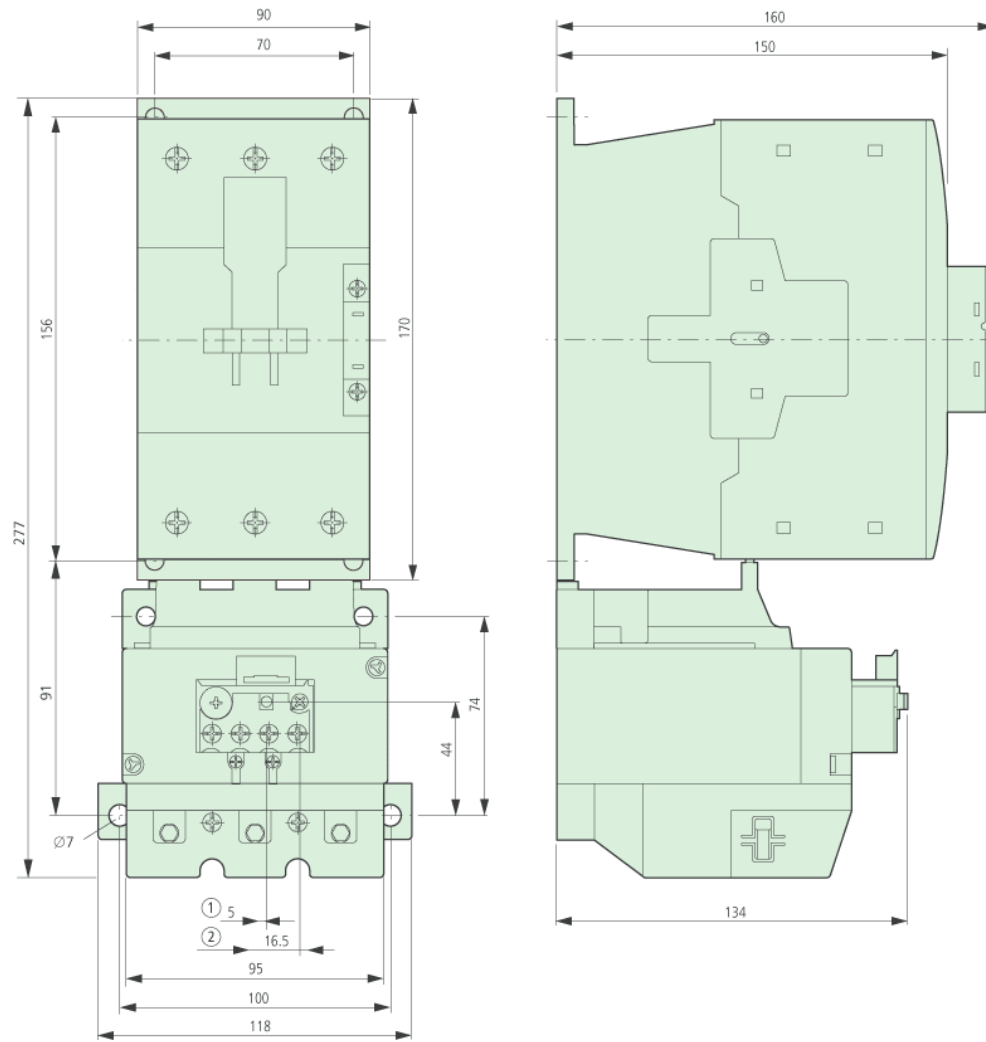

OFF  
Reset/ON

## Characteristic curve

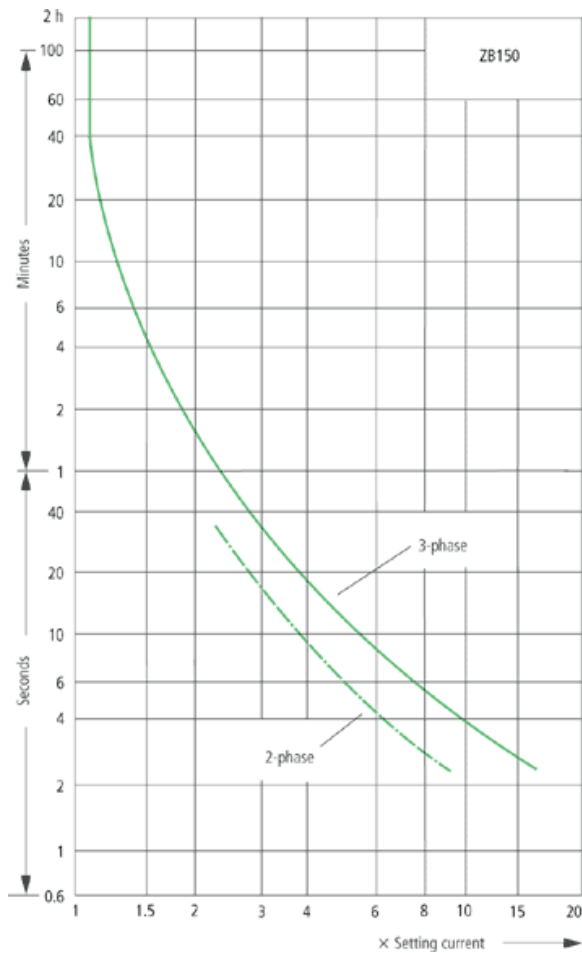

These tripping characteristics are mean values of the spread at 20 °C ambient temperature in a cold state. Tripping time depends on response current. On devices at operating temperature the tripping time of the overload relay drops to approx. 25 % of the read value. Specific characteristics for each individual setting range can be found in the manual.

Moeller GmbH, Hein-Moeller-Str. 7-11, D-53115 Bonn  
 E-Mail: [catalog@moeller.net](mailto:catalog@moeller.net), Internet: [www.moeller.net](http://www.moeller.net), <http://catalog.moeller.net>  
 Copyright 2006 by Moeller GmbH. HPL-C2007G V2.1