

596-061 → 103

596-115 to 152

Connector Covers

3M 4270 Series Connector Covers are made from conductive polyethylene composite material. The covers are permanently volume conductive, free of carbon black particulate, and are low outgassing and noncorrosive.

Circular Covers

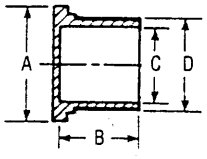
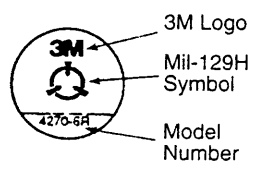
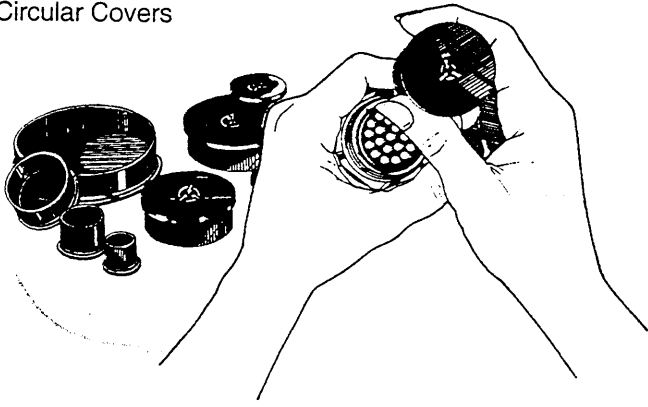

Product No. Dimensions, in.
 A B C D Covers per bag

4270- Circular Connector Covers (sized to MS90376)					
4R	.670	.500	.250	.336	100
5R	.670	.500	.313	.399	(10 bags/box)
6R	.670	.500	.375	.461	
8Y	.670	.625	.413	.483	
8R	.740	.500	.480	.540	
9R	.750	.500	.500	.586	
10Y	.750	.625	.530	.595	
10R	.840	.500	.605	.665	
12Y	.860	.625	.655	.715	
12R	.970	.500	.720	.775	
14Y	1.031	.625	.785	.845	
14R	1.125	.500	.850	.905	
16Y	1.125	.625	.893	.963	
16R	1.220	.500	.973	1.035	
18Y	1.250	.625	1.028	1.088	
18R	1.330	.562	1.093	1.155	
19R	1.400	.562	1.125	1.213	
20Y	1.406	.625	1.150	1.215	50
20R	1.465	.562	1.231	1.301	(10 bags/box)
22Y	1.500	.625	1.270	1.340	
22R	1.590	.562	1.340	1.410	
24Y	1.640	.625	1.390	1.460	
24R	1.700	.562	1.463	1.533	
25Y	1.610	.625	1.540	1.580	
28Y	1.875	.625	1.645	1.718	
28R	1.950	.562	1.715	1.790	
32Y	2.125	.625	1.890	1.970	25
32R	2.220	.562	1.965	2.040	(10 bags/box)
36Y	2.340	.625	2.140	2.210	
36R	2.435	.600	2.215	2.290	
40Y	2.600	.625	2.380	2.450	
40R	2.660	.600	2.440	2.530	
44Y	2.875	.625	2.630	2.700	
44R	2.960	.600	2.720	2.812	
48Y	3.125	.625	2.880	2.950	
48R	3.225	.600	2.960	3.050	

'D' Type Cover

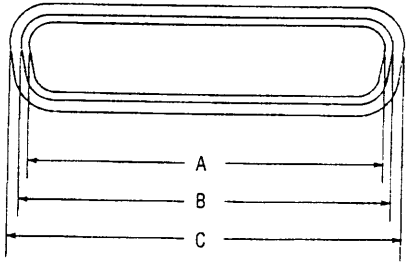
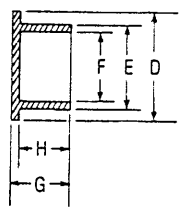
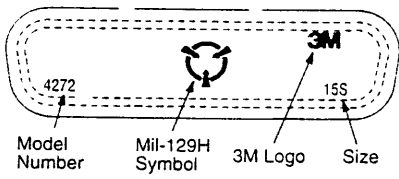
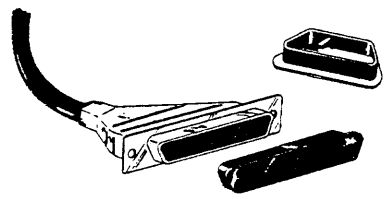

Product No. Dimensions, in.
 A B C D E F G H

4272- D Type Subminiature Connector Covers								
50P	2.112	2.179	2.279	.636	.536	.469	.280	.249
50S	2.049	2.116	2.216	.574	.474	.407	.280	.249
37P	2.216	2.283	2.383	.530	.430	.363	.280	.249
37S	2.143	2.210	2.310	.462	.362	.295	.280	.249
25P	1.568	1.635	1.735	.530	.430	.363	.280	.249
25S	1.495	1.562	1.662	.462	.362	.295	.280	.249
15P	1.040	1.107	1.177	.512	.436	.369	.280	.249
15S	.955	1.022	1.122	.462	.362	.295	.280	.249
9P	.682	.775	.849	.512	.434	.367	.280	.249
9S	.627	.694	.794	.462	.362	.295	.280	.249

10 packs per carton/10 covers per pack.
104P (Pin)
104S (Socket)