



JB5 Jumper Bars

Terminal Blocks Accessories

Features and Benefits

Facilitate & secure your jumper bar assembly process:

- Screwless mounting,
- Pre-cut poles for various circuits configurations,
- Insulated,
- Positive locking.

Main Technical Data

	IEC	cULus - CSA	Ex e
Rated current	32 A	30 A	
Rated voltage	Standard use	1000 V	600 V
	Cut extremities	800 V	300 V
	Cut poles	400 V	300 V
Impulse withstand voltage	8000 V		
Protection	IP 20	NEMA 1	

Mounting Instructions

Screwless

Tool	
Torque	

Material Specifications

Insulating material	Polyamide		
Flammability	V0		
NF F 16 101	I2F2		
Ambient temperature min/max	Service IEC 60068-2-1	-55 +110 °C	-67 +230 F
	Storage	-55 +110 °C	-67 +230 F
	Installing	-5 +40 °C	-23 +104 F

Ordering Details

JB5 Jumper Bars

Description	Type	Order Code	Pack ^(ing) pieces	Weight g (1 pce)	
5.2 mm 0.205 in spacing	2 poles	JB5-2	1SNK 905 302 R0000	50	1.30
	3 poles	JB5-3	1SNK 905 303 R0000	50	2.00
	4 poles	JB5-4	1SNK 905 304 R0000	50	2.70
	5 poles	JB5-5	1SNK 905 305 R0000	50	3.50
	10 poles	JB5-10	1SNK 905 310 R0000	30	7.10
	50 poles	JB5-50	1SNK 905 350 R0000	10	36.10

JB5 Accessories

Description	Type	Order Code	Pack ^(ing) pieces	Weight g (1 pce)	
1 Circuit Separators	Dark Grey	CS	1SNK 900 101 R0000	20	0.20

JB5 Mounting Instructions

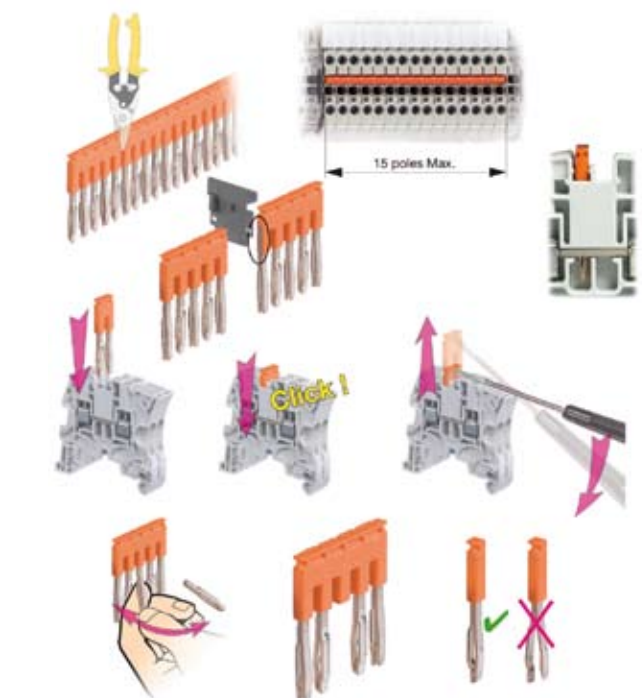

- Caution: use of 50 poles jumper bars or cut jumper bars is not allowed in Explosive atmospheres,
- Jumper bar with cut extremities: when mounted on feed-through or ground terminal blocks: the circuit separator CS must be installed on the cut side,
- Jumper bar with cut poles: for alternated jumpering between terminal blocks.