

**Subminiature Fuses
Type FRT 250F**

quick-acting F
low breaking capacity
directly solderable into
printed circuit boards or
pluggable into fuseholders

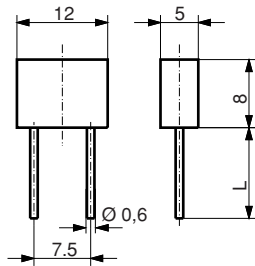

L: 3,5 (short)
or
19 (long)

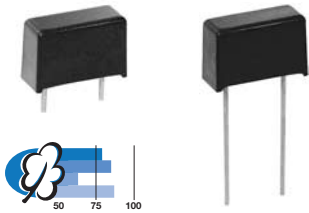
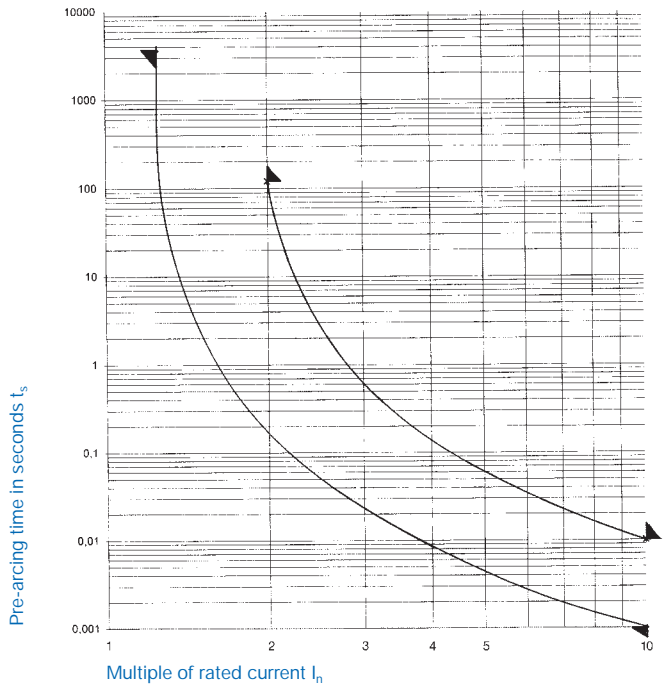

Standards

IEC 60127-4/1; EN 60127-4/1
UL 248-14

Approvals



**Pre-arcing time/current
characteristic (at T_a 23 °C)**

Rated current I _n	n · I _n		10 · I _n	
	1,25 · I _n *	2 · I _n	min.	max.
160 mA–10 A	60 min.	120 s	1 ms	10 ms

* Non fusing current I_{nf}

Order No.			Rated current I _n Rated voltage U _n	Breaking capacity	Voltage drop		Sustained power dissipation / at max. 1,25 I _n typ. mW	Pre-arcing I ² t at 10 · I _n typ. A ² s	Approvals VDE c UL US
Terminals short	long	Taped and reeled			at I _n typ. mV	at 10 · I _n typ. A ² s			
7100.1057.XX	7100.1157.XX	7100.1157.XX	160 mA / 250 V	100 A/250 V AC/DC p.f. / cos φ 0.95	375	170	0,0062	• •	
7100.1058.XX	7100.1158.XX	7100.1158.XX	200 mA / 250 V		290	165	0,015	• •	
7100.1059.XX	7100.1159.XX	7100.1159.XX	250 mA / 250 V		290	210	0,028	• •	
7100.1060.XX	7100.1160.XX	7100.1160.XX	315 mA / 250 V		270	240	0,040	• •	
7100.1061.XX	7100.1161.XX	7100.1161.XX	400 mA / 250 V		300	310	0,088	• •	
7100.1062.XX	7100.1162.XX	7100.1162.XX	500 mA / 250 V		130	120	0,058	• •	
7100.1063.XX	7100.1163.XX	7100.1163.XX	630 mA / 250 V		120	130	0,12	• •	
7100.1064.XX	7100.1164.XX	7100.1164.XX	800 mA / 250 V		110	150	0,21	• •	
7100.1065.XX	7100.1165.XX	7100.1165.XX	1 A / 250 V		160	290	0,18	• •	
7100.1066.XX	7100.1166.XX	7100.1166.XX	1,25 A / 250 V		155	360	0,28	• •	
7100.1067.XX	7100.1167.XX	7100.1167.XX	1,6 A / 250 V		125	370	0,61	• •	
7100.1068.XX	7100.1168.XX	7100.1168.XX	2 A / 250 V		125	480	1	• •	
7100.1069.XX	7100.1169.XX	7100.1169.XX	2,5 A / 250 V		100	470	1,4	• •	
7100.1070.XX	7100.1170.XX	7100.1170.XX	3,15 A / 250 V		95	565	2,5	• •	
7100.1071.XX	7100.1171.XX	7100.1171.XX	4 A / 250 V		90	690	4,5	• •	
7100.1072.XX	7100.1172.XX	7100.1172.XX	5 A / 250 V		85	820	7,5	• •	
7100.1073.XX	7100.1173.XX	7100.1173.XX	6,3 A / 250 V		80	990	15	• •	
7100.1074.XX	7100.1174.XX	7100.1174.XX	8 A / 250 V	75	1170	25,6	• •		
7100.1075.XX	7100.1175.XX	7100.1175.XX	10 A / 250 V	70	1350	55	•		

.XX Packaging index

Additional technical data and packaging see page 78

Suitable fuseholder see page 181

FUSES

Non resettable fuses

**Subminiature Fuses
Type FRT 250T**

time-lag T

low breaking capacity
directly solderable into
printed circuit boards or
pluggable into fuseholders

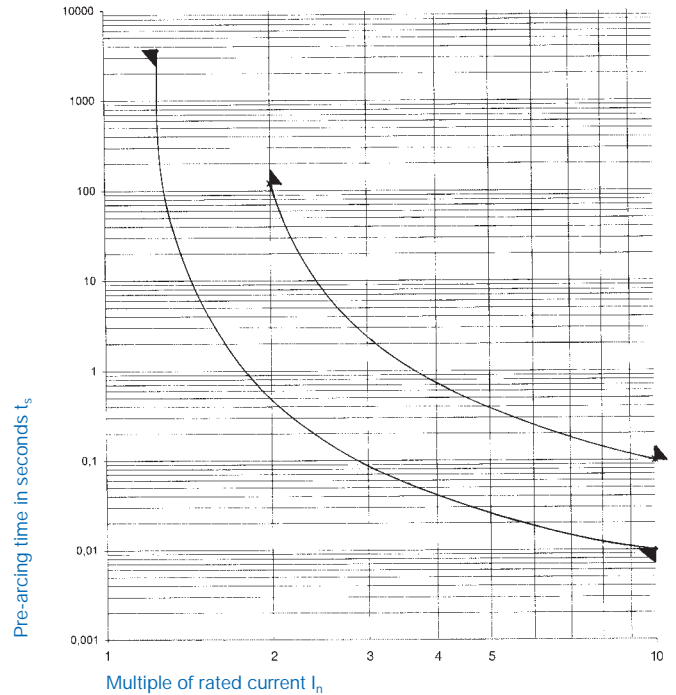
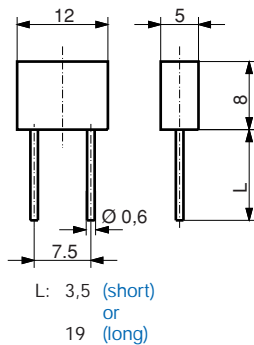
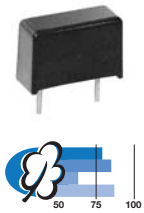

Standards

IEC 60127-4/1; EN 60127-4/1
UL 248-14

Approvals



**Pre-arcing time/current
characteristic (at T_a 23 °C)**

Rated current I _n	n · I _n		10 · I _n	
	1,25 · I _n	2 · I _n	min.	max.
160 mA–10 A	60 min.	120 s	10 ms	100 ms

* Non fusing current I_{nr}

Order No.			Rated current I _n Rated voltage U _n	Breaking capacity	Voltage drop	Sustained power dissipation	Pre-arcing I ² t	Approvals
Terminals		Taped and reeled	Nennspannung U _n		at / bei I _n max.	at / bei 1,25 I _n max.	at / bei 10 · I _n	tionen VDE cULUS
short	long				typ. mV	typ. mW	typ. A ² s	
7100.1007.XX	7100.1107.XX	7100.1107.XX	160 mA / 250 V	100 A/250 V AC/DC p.f. / cos φ 0.95	300	85	0,14	• •
7100.1008.XX	7100.1108.XX	7100.1108.XX	200 mA / 250 V		255	95	0,23	• •
7100.1009.XX	7100.1109.XX	7100.1109.XX	250 mA / 250 V		190	90	0,20	• •
7100.1010.XX	7100.1110.XX	7100.1110.XX	315 mA / 250 V		130	75	0,30	• •
7100.1011.XX	7100.1111.XX	7100.1111.XX	400 mA / 250 V		140	95	0,49	• •
7100.1012.XX	7100.1112.XX	7100.1112.XX	500 mA / 250 V		125	115	0,53	• •
7100.1013.XX	7100.1113.XX	7100.1113.XX	630 mA / 250 V		110	125	1,13	• •
7100.1014.XX	7100.1114.XX	7100.1114.XX	800 mA / 250 V		235	340	1,7	• •
7100.1015.XX	7100.1115.XX	7100.1115.XX	1 A / 250 V		145	250	2	• •
7100.1016.XX	7100.1116.XX	7100.1116.XX	1,25 A / 250 V		125	275	3,7	• •
7100.1017.XX	7100.1117.XX	7100.1117.XX	1,6 A / 250 V		120	380	4,4	• •
7100.1018.XX	7100.1118.XX	7100.1118.XX	2 A / 250 V		120	440	7,2	• •
7100.1019.XX	7100.1119.XX	7100.1119.XX	2,5 A / 250 V		105	450	6,8	• •
7100.1020.XX	7100.1120.XX	7100.1120.XX	3,15 A / 250 V		90	490	13,4	• •
7100.1021.XX	7100.1121.XX	7100.1121.XX	4 A / 250 V	85	590	25	• •	
7100.1022.XX	7100.1122.XX	7100.1122.XX	5 A / 250 V	95	860	32	• •	
7100.1023.XX	7100.1123.XX	7100.1123.XX	6,3 A / 250 V	96	1200	53	• •	
7100.1024.XX	7100.1124.XX	7100.1124.XX	8 A / 250 V	60	900	87	• •	
7100.1025.XX	7100.1125.XX	7100.1125.XX	10 A / 250 V	55	1100	160	•	

.XX Packaging index

Additional technical data and packaging see page 78



Suitable fuseholder see page 181

Technical data and packaging
Types **FRT 250F**
FRT 250T

Additional technical data

Ambient temperature max. T_a	-40 °C to +85 °C
Capacity at different T_a	1 · I_n up to max. 40 °C 0,9 · I_n up to max. 85 °C
Resistance to vibration /	Frequency 10 ÷ 2000 Hz, cross-over frequency 60 Hz < 60 Hz constant amplitude of 1,5 mm > 60 Hz constant acceleration of 100 m/s ² (10 g) according to IEC 60068-2-6, test Fc
Resistance to shock	490 m/s ² (50 g), 11 ms according to IEC 60068-2-27
Climate category	according to DIN 40040
Solderability	235 °C / 2 sec. according to IEC 60068-2-20, test Ta
Soldering heat resistance	260 °C / 10 sec. according to IEC 60068-2-20, test Tb
Materials / Socket and cap	temperature resistant plastic, UL 94V-0
Terminals	Copper tin-plated

Packaging

Box or tape	Types FRT 250 F, FRT 250 T
Boxes of 100 pieces	7100.XXXX.13
Taped and reeled 500 pieces	7100.XXXX.95
Taped and reeled 1000 pieces	7100.XXXX.96

Tape and reel

according to IEC 60286-2

