

This 38mm, panel mount trackball provides smooth, accurate and responsive cursor control in wet, dirty or aggressive environments. Sealed against the ingress of fluids and dust the device automatically configures to provide either PS2 or USB connectivity. The robust chassis is designed to provide secure under-panel fixing for maximum resistance to hard use, abuse, and vandalism.

OVERALL DIMENSIONS

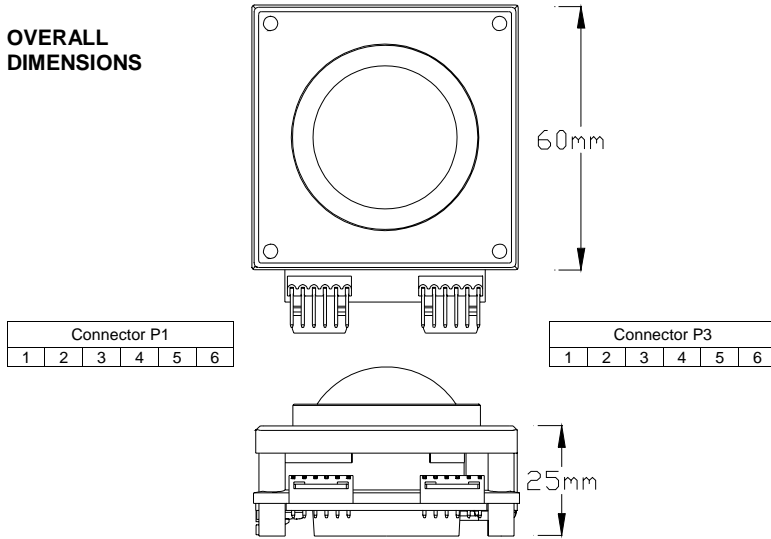

PANEL PREPARATION DETAILS

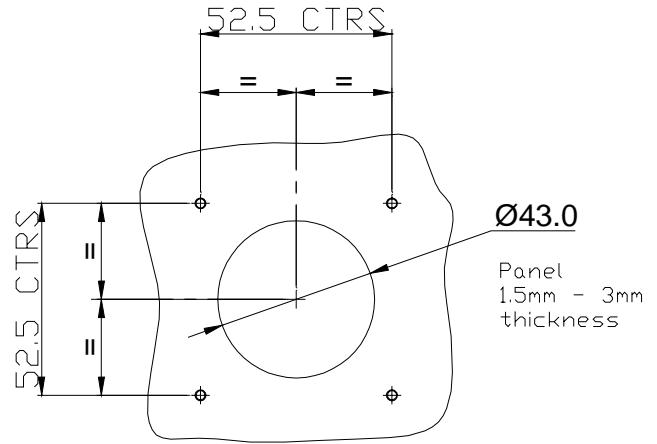

ELECTRICAL

Supply Voltage: 5.0V dc $\pm 10\%$
 Switch Debounce :30ms rising/falling
 Supply Current 15mA maximum
 Resolution 150 pulses, 600 counts/revolution

ENVIRONMENTAL

Operating Temp: -20°C to +60° C
 IP65 seal when ball stationary
 IP54 seal when ball rotating
 Humidity: 95% Rh max, non-condensing

INSTALLATION

Prepare plate with hole for $\phi 43.0$ mm bezel and M3 x 40mm studs on 52.5mm centres
 Fit sealing gasket to trackball
 Place trackball and vandal plate over studs
 Secure with plain washers and Nyloc nuts
IMPORTANT : Max torque 40Ncm on nuts.
 Connect switch cable to P1
 If reqd, fit jumper to enable both buttons as left click.
 Connect PS2 or USB cable to connector P3

MECHANICAL

Tracking Force :50g nominal any direction
 Ball Speed : 250 rpm maximum
 Operational Life : 10 million revolutions min
 Mounting Angle : within $\pm 45^\circ$ from horizontal.

MATERIAL

Robust Trackball: Phenolic Resin
 Vandal Resist. Trackball: Surface Teated Steel
 Seal Material :PTFE with low friction fill
 Vandal Plate :Stainless Steel
 NB. Robust Version does not have Vandal Plate

| Connector Pinout Details | | |
|--------------------------|-------------------------|-----------------------------------|
| Pin | Button Connections (P1) | USB / PS2 Output Connections (P3) |
| 1 | 0V | D- / DATA |
| 2 | Button 1(Left) | D+ / CLOCK |
| 3 | 0V | TEST ONLY |
| 4 | Button 2(Right) | Power +5V |
| 5 | 0V | Ground 0V |
| 6 | Button3(Middle) | Not Used |

The unit automatically selects either USB or PS/2 protocols on power-up without setting any DIP switches.
 If both buttons are required to be set as left click then fit the supplied jumper between connectors P1 and P3
 Please note that the TEST input is reserved for factory test only. On no account should a connection be made to this terminal.
 The Button inputs are pulled high within the unit to the 5V power supply via approximately 7k Ω . Both rising and falling edges of this signal are debounced for 30ms.
 The Storm Trackerball is designed to work with resident drivers and does not require any further software to be loaded.

ORDERING DETAILS

| | |
|---|---------------|
| Cable 2.5m PS2 | 2200-00200[x] |
| Cable 2.5m USB | 2200-00300[x] |
| Trackerball Unit PS2/USB Black Phenolic Ball | 2200-00020[x] |
| Trackerball Unit PS2/USB Stainless Steel Ball | 2200-00030[x] |



Whilst every effort is made to ensure details are correct at time of print, specifications are subject to change without notice.

usa office:
storm data entry technology
 suite 202
 364 pennsylvania avenue
 glen ellyn IL 60137 USA
 tel: (630) 469 2981
 fax: (630) 469 2975
 email: sales.usa@storm-keypads.com
 website: www.storm-keypads.com

uk office:
keymat technology ltd
 14 bentinck court
 bentinck road
 west drayton
 middlesex UB7 7RQ
 tel: +44 (0)1895 431421
 fax: +44 (0)1895 431132
 email: sales@keymat.com
 website: www.keymat.com



FM39602

Storm is a trademark of Keymat Technology Ltd