

- NOTES :
- MATERIALS:  
HOUSING : LCP, GLASS FILLED, UL 94V-0, COLOR : BLACK,  
TERMINAL : COPPER ALLOY, THICKNESS=0.15±0.01mm
  - PLATING :  
CONTACT : 0.76µm MIN. GOLD WITH 1.27µm NICKEL  
UNDERPLATE OVERALL  
SOLDER TAIL : 3.81µm TIN WITH 1.27µm NICKEL  
UNDERPLATE OVERALL.
  - PRODUCT SPECIFICATIONS : PS-87777-002.
4. MXS LOGO AND CAVITY ID LOCATED APPROXIMATELY AS SHOWN.
5. GATE PROTRUSION SHALL NOT EXCEED 0.08mm.
6. PARTS SHALL BE PACKED IN TRAY.
7. COPLANARITY FOR SOLDER TAIL SHALL NOT EXCEED 0.10mm.

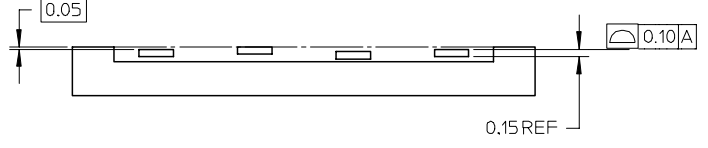

OBS TIN/LEAD P/N	EC NO: S2006-0744	2006/04/04
	DRWN:MLONG	2006/04/07
	CHKD:SHFONG	
	APPR:KCLING	

QUALITY SYMBOLS	▽=0
	∇=0

GENERAL TOLERANCES (UNLESS SPECIFIED)	mm	INCH
	4 PLACES ± ---	± ---
	3 PLACES ± ---	± ---
	2 PLACES ± 0.13	± ---
	1 PLACE ± ---	± ---
ANGULAR ± 3 °		
DRAFT WHERE APPLICABLE MUST REMAIN WITHIN DIMENSIONS		

DIMENSION STYLE		SCALE	DESIGN UNITS	THIRD ANGLE PROJECTION
MM ONLY		NTS	METRIC	
DRAWN BY	DATE	TITLE		
MLONG	2002/11/15	4 PINS COMPRESSION CONNECTOR		
CHECKED BY	DATE			
PTL IM	2002/12/11	MOLEX INCORPORATED		
APPROVED BY	DATE			
SKTOH	2002/12/11	MATERIAL NO. 87777-1001		
DOCUMENT NO. SD-87777-001		SHEET NO. 1 OF 2		

10 9 8 7 6 5 4 3 2 1

F

E

D

C

B

A

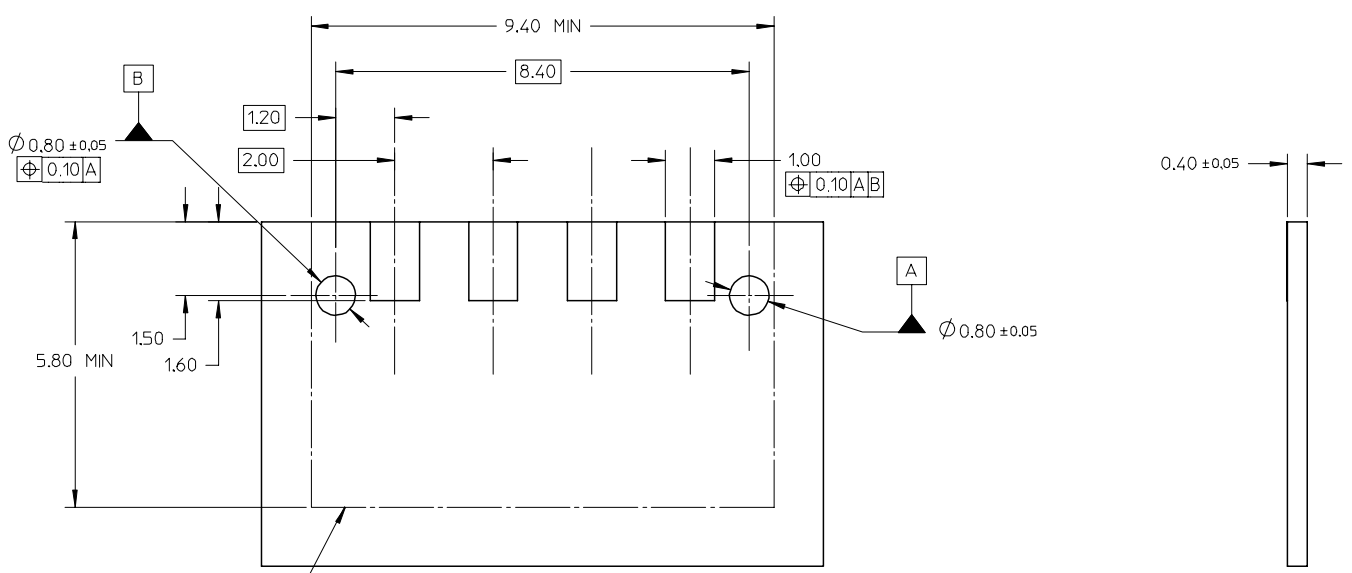

COMPONENT  
KEEP OUT AREA

PCB LAYOUT  
COMPONENT SIDE

OBS TIN/LEAD P/N  
EC NO: S2006-0744  
DRWN:MLONG 2006/04/04  
CHKD:SHFONG 2006/04/06  
APPR:KCLING 2006/04/07

QUALITY SYMBOLS  
▽=0  
∇=0

GENERAL TOLERANCES (UNLESS SPECIFIED)	
	mm
4 PLACES	± 0.13
3 PLACES	± 0.13
2 PLACES	± 0.13
1 PLACE	± 0.13
ANGULAR ± 3°	

DRAFT WHERE APPLICABLE  
MUST REMAIN  
WITHIN DIMENSIONS

DIMENSION STYLE	
MM ONLY	
DRAWN BY	DATE
MLONG	2002/11/15
CHECKED BY	DATE
PTL IM	2002/12/11
APPROVED BY	DATE
SKTOH	2002/12/11
MATERIAL NO.	
87777-1001	

SCALE	DESIGN UNITS	THIRD ANGLE PROJECTION
NTS	METRIC	☉
TITLE		
4 PINS COMPRESSION CONNECTOR		
MOLEX INCORPORATED		
MATERIAL NO.	DOCUMENT NO.	SHEET NO.
87777-1001	SD-87777-001	2 OF 2

9 8 7 6 5 4 3 2 1