

## CROWN CLIP Series Sockets (Continued)

### CROWN CLIP II Sockets Part Number 1643903-1

#### Product Specifications

##### Materials

**Insulator** — Polyester, UL 94V-0

**Contact** — Copper alloy, selectively plated with gold (30 micro inches minimum), over nickel

##### Electrical

##### Current Rating, Steady State —

Nickel plated solid tab: 300 Amp maximum; 230 Amp at 30°C maximum temperature rise

**Current Rating, Hot-Plug** — Gold plated solid tab: 200 Amp maximum, 42V; 100 Amp maximum, 48V

##### Mechanical

**Insertion Force** — 20.0 lbs (9.08 Kg) typical

**Extraction Force** — 10.0 lbs (4.54 Kg) typical

Dual Pole, Float Mount Socket design delivers 300 Amp current capability plus current interruption.

Float mount design provides alignment for blind mating of rack-mounted power supply units. The Dual Pole contact design allows mating to a two pole

laminated bus bar or double sided PCB tab, adding design flexibility by providing feed and return using a single socket. Current interruption ratings are 100A at 48V and 200A at 42V, both using a gold plated, solid tab.

Customer Drawing available upon request.

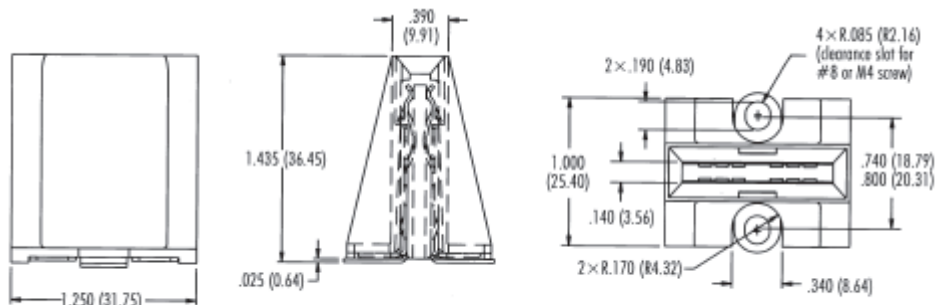

### CROWN CLIP Sockets II Connector Electrical Performance

The graphs below show the electrical performance of CROWN CLIP II sockets in terms of temperature rise and voltage drop at currents from 150 Amps to 350 Amps. The set up used for the test had samples of six CROWN CLIP Sockets mounted on a .25" x 1.75" x 6.0" bus bar, mating with 1.0" long by .125" thick nickel plated blades connected in series using 1/0 AWG wire.

