

SUGGESTED STRIPPING INSTRUCTIONS  
 SUGGESTED CRIMP: .213  
 PIN TO BE SOLDERED OR CRIMPED

REVISIONS		DOC. NO. SPC-FD05, Total Pages: 2						
DCP #	REV	DESCRIPTION	DRAWN	DATE	CHECKD	DATE	APPRVD	DATE
18	A	RELEASED	D.J.C.	4/1/97	J.C.	4/4/97	B.B.	4/16/97
428	B	CHANGE ELECTRONIC FILE NAME	DUC	2/12/98	J.C.	2/17/98	J.C.	2/17/98

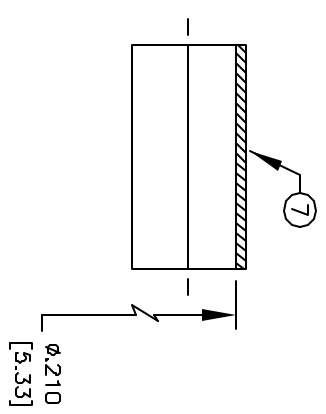
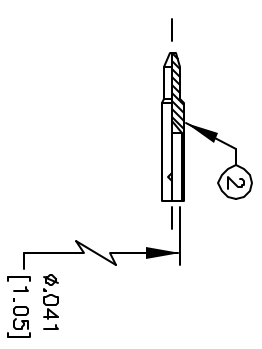

**SPECIFICATIONS:**

IMPEDANCE: 50 OHMS  
 WORKING VOLTAGE: 500V PEAK @ SEA LEVEL  
 FREQUENCY RANGE: 0-12.4 GHz  
 INSERTION LOSS: ≤ -.2 dB @ 6 GHz  
 VSWR MAXIMUM: 1.3:1 @ 12 GHz  
 FOR RG-58, 58A, 58C, 141, 141A, 400/U, BELDEN 8240,  
 B259, 8262, 9201, 9203, 9310, 9311 CABLE

ITEM	DESCRIPTION	QTY	MATERIAL	FINISH
7	FERRULE	1	*BRASS	NICKEL
6	SHELL	1	BRASS	NICKEL
5	RETAINING RING	1	BaCu	NONE
4	GASKET	1	S.I. RUBBER	BRIGHT ORANGE
3	DIELECTRIC	1	TEFLON	NONE
2	PIN	1	BRASS	GOLD
1	BODY	1	BRASS	NICKEL

**DISCLAIMER**  
 ALL STATEMENTS AND TECHNICAL INFORMATION CONTAINED HEREIN ARE BASED UPON INFORMATION AND/OR TESTS WE BELIEVE TO BE ACCURATE AND RELIABLE. SINCE CONDITIONS OF USE ARE BEYOND OUR CONTROL, THE USER SHALL DETERMINE THE SUITABILITY OF THE PRODUCT FOR THE INTENDED USE AND ASSUME ALL RISK AND LIABILITY WHATSOEVER IN CONNECTION THEREWITH.

**SPC TECHNOLOGY**  
 CENTRALIA, IL 62420-1898

DRAWING TITLE: **SMA MALE CRIMP**

DRAWN BY:	DATE:	SIZE	DWG. NO.	CAD FILE	REV
DAN CAREY	4/1/97	A	8589-0833	16N2715.DWG	B
CHECKED BY:	DATE:	SCALE:	NTS	U.O.M.: INCHES [mm]	SHEET: 1 OF 1
JOHN COLE	4/4/97				
APPROVED BY:	DATE:				
BRETT BRAATZ	4/16/97				