

MICRO SWITCH

FREERPORT, ILLINOIS, U.S.A.
A DIVISION OF HONEYWELL

FED. MFG. CODE 91929

MAGNET

CATALOG LISTING

10IMG7

THIS DRAWING COVERS A PROPRIETARY ITEM AND IS THE PROPERTY OF MICRO SWITCH, A DIVISION OF HONEYWELL. THIS DRAWING IS NOT TO BE COPIED OR USED WITHOUT THE APPROVAL OF MICRO SWITCH.

SCALE 2 TO 1

DO NOT SCALE PRINT

UNLESS OTHERWISE NOTED

DIMENSIONS ARE IN INCHES

TOLERANCES ARE:

ONE PLACE	(.0)	±.030
TWO PLACE	(.00)	±.015
THREE PLACE	(.000)	±.005
ANGLES		±

WEIGHT

10IMG7

REPLACES

RELEASE NO. PR-4188

M

DRAWING NUMBER

X 2

X 4

ISSUE

X 4

CHECK

REVISIONS

A	CO-35859	RE R	18 SEP 75
B	CO-45855	G R T	6 APR 79
C	CO-50564	K A G	10 DEC 81

5 JUN 74

RAM

CHECK

74

74

74

74

74

74

74

74

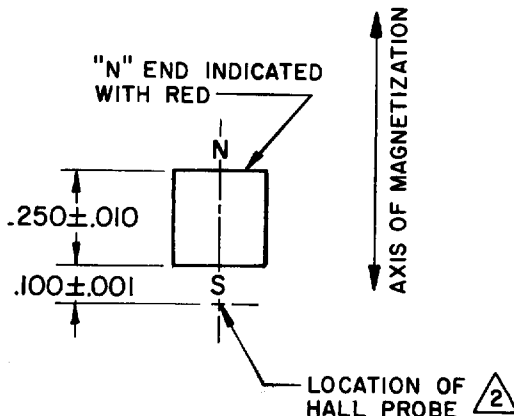
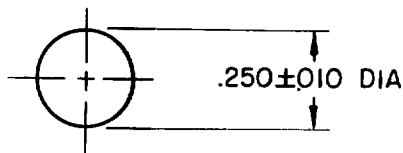

NOTES-

1 - THE MAGNET IS SINTERED ALNICO 8HE MAGNETIZED AND CONDITIONED FOR OPERATION

2 READING IN GAUSS WITH F.W. BELL 620 GAUSSMETER AND PROBE STJ4-0402 AT .100 ± .001 INCHES FROM SOUTH POLE AT TEMPERATURE OF 24 ± 2°C SHALL BE 480 GAUSS MINIMUM AND 600 GAUSS MAXIMUM.