

# REEVITE

INDUSTRIAL MOULDINGS

# OPEN GROMMETS

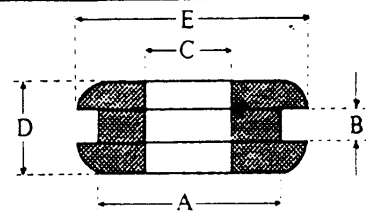

RUBBER PART NO	P.V.C. PART NO	METRIC					IMPERIAL				
		A	B	C	D	E	A	B	C	D	E
RB 222		9.5	1.6	7.2	7.2	15.1	3/8	1/16	9/32	9/32	19/32
	PV 45	9.5	1.6	7.5	6.4	13.5					
ISA-338	PV 37A*	9.5	1.6	8.0	4.8	14.3	3/8	1/16	3/16	3/16	9/16
	PV 37	9.5	1.6	8.0	8.0	14.3	3/8	1/16	3/16	3/16	9/16
RB 37		9.5	1.6	8.0	8.0	15.9	3/8	1/16	3/16	3/16	5/8
RB 3422		9.5	1.8	6.4	6.4	12.7	3/8	.070	1/4	1/4	1/2
	PV 781	9.5	2.0	3.2	6.8	14.3	3/8	3/64	1/8	17/64	9/16
RB 782		9.5	2.0	3.2	6.8	15.9	3/8	3/64	1/8	17/64	5/8
	PV 782	9.5	2.0	4.8	6.0	14.3	3/8	3/64	3/16	13/64	9/16
	PV 783	9.5	2.0	6.4	6.8	14.3	3/8	3/64	1/4	17/64	9/16
	PV 222	9.5	2.0	7.2	6.0	14.3	3/8	3/64	9/32	13/64	9/16
	PV 784	9.5	2.0	8.0	5.2	14.3	3/8	3/64	3/16	13/64	9/16
	PV 785	9.5	2.4	3.2	7.2	14.3	3/8	3/32	1/8	9/32	9/16
RB 783		9.5	2.4	3.2	7.2	15.9	3/8	3/32	1/8	9/32	5/8
	PV 38A	9.5	2.4	4.8	6.4	14.3	3/8	3/32	3/16	1/4	9/16
RB 38B		9.5	2.4	4.8	7.2	15.9	3/8	3/32	3/16	9/32	5/8
RB 3423		9.5	2.4	6.4	7.2	12.7	3/8	3/32	1/4	9/32	1/2
RB 39	PV 39	9.5	2.4	6.4	7.2	14.3	3/8	3/32	1/4	9/32	9/16
RB 786	PV 786	9.5	2.4	7.2	5.6	11.1	3/8	3/32	9/32	7/32	7/16
	PV 39A	9.5	2.4	8.0	8.7	14.3	3/8	3/32	3/16	11/32	9/16
	PV 788	9.5	2.8	3.2	7.6	14.3	3/8	7/64	1/8	19/64	9/16
	PV 789	9.5	2.8	4.8	6.8	14.3	3/8	7/64	3/16	17/64	9/16
	PV 790	9.5	2.8	6.4	7.6	14.3	3/8	7/64	1/4	19/64	9/16
	PV 791	9.5	2.8	8.0	9.1	15.9	3/8	7/64	3/16	23/64	5/8
	PV 792	9.5	3.2	3.2	8.0	14.3	3/8	1/8	1/8	3/16	9/16
RB 784		9.5	3.2	3.2	8.0	15.9	3/8	1/8	1/8	3/16	5/8
	PV 223	9.5	3.2	4.0	6.4	15.9	3/8	1/8	3/32	1/4	5/8
	PV 40	9.5	3.2	4.8	7.2	14.3	3/8	1/8	3/16	9/32	9/16
RB 3424		9.5	3.2	6.4	8.0	12.7	3/8	1/8	1/4	3/16	1/2
RB 41	PV 41	9.5	3.2	6.4	8.0	14.3	3/8	1/8	1/4	3/16	9/16
RB 41B		9.5	3.2	6.4	8.7	14.7	3/8	1/8	1/4	11/16	37/64
RB 42	PV 42	9.5	3.2	8.0	9.5	14.3	3/8	1/8	3/16	3/8	9/16
	PV 793	9.5	3.6	3.2	8.4	14.3	3/8	9/64	1/8	21/64	9/16
	PV 794	9.5	3.6	4.8	7.6	14.3	3/8	9/64	3/16	19/64	9/16
RB 224		9.5	3.6	5.2	6.8	11.9	3/8	9/64	13/64	17/64	13/32
	PV 795	9.5	3.6	6.4	8.4	14.3	3/8	9/64	1/4	21/64	9/16
	PV 796	9.5	3.6	8.0	9.9	14.3	3/8	9/64	3/16	25/64	9/16
RB 225		9.5	4.0	2.4	8.7	12.7	3/8	3/32	3/32	11/32	1/2
	PV 797	9.5	4.0	3.2	8.7	14.3	3/8	3/32	1/8	11/32	9/16
	PV 798	9.5	4.0	4.8	8.0	14.3	3/8	3/32	3/16	3/16	9/16
RB 3425		9.5	4.0	6.4	8.7	12.7	3/8	3/32	1/4	11/32	1/2
	PV 799	9.5	4.0	6.4	8.7	14.3	3/8	3/32	1/4	11/32	9/16
	PV 800	9.5	4.0	8.0	10.3	14.3	3/8	3/32	3/16	13/32	9/16
	PV 801	9.5	4.4	3.2	9.1	14.3	3/8	11/64	1/8	23/64	9/16
	PV 802	9.5	4.4	4.8	8.4	14.3	3/8	11/64	3/16	21/64	9/16
	PV 803	9.5	4.4	6.4	9.1	14.3	3/8	11/64	1/4	23/64	9/16
	PV 804	9.5	4.4	8.0	10.7	14.3	3/8	11/64	3/16	27/64	9/16
	PV 805	9.5	4.8	3.2	9.5	14.3	3/8	3/16	1/8	3/8	9/16
	PV 806	9.5	4.8	4.8	8.7	14.3	3/8	3/16	3/16	11/32	9/16
	PV 807	9.5	4.8	6.4	9.5	14.3	3/8	3/16	1/4	3/8	9/16
RB 226		9.5	4.8	6.4	11.1	12.7	3/8	3/16	1/4	7/16	1/2
	PV 808	9.5	4.8	8.0	11.1	14.3	3/8	3/16	3/16	7/16	9/16
RB 3426		9.5	5.2	6.4	9.5	12.7	3/8	13/64	1/4	25/64	1/2
RB 810		9.5	6.4	6.4	11.1	15.9	3/8	1/4	1/4	7/16	5/8