

NO	DESCRIPTION	DATE
⚠	BACKGROUND FORMAT UPDATED	07.18.02'

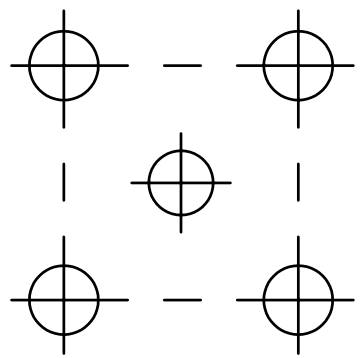
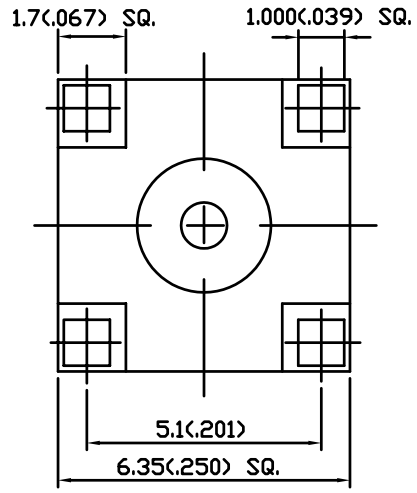
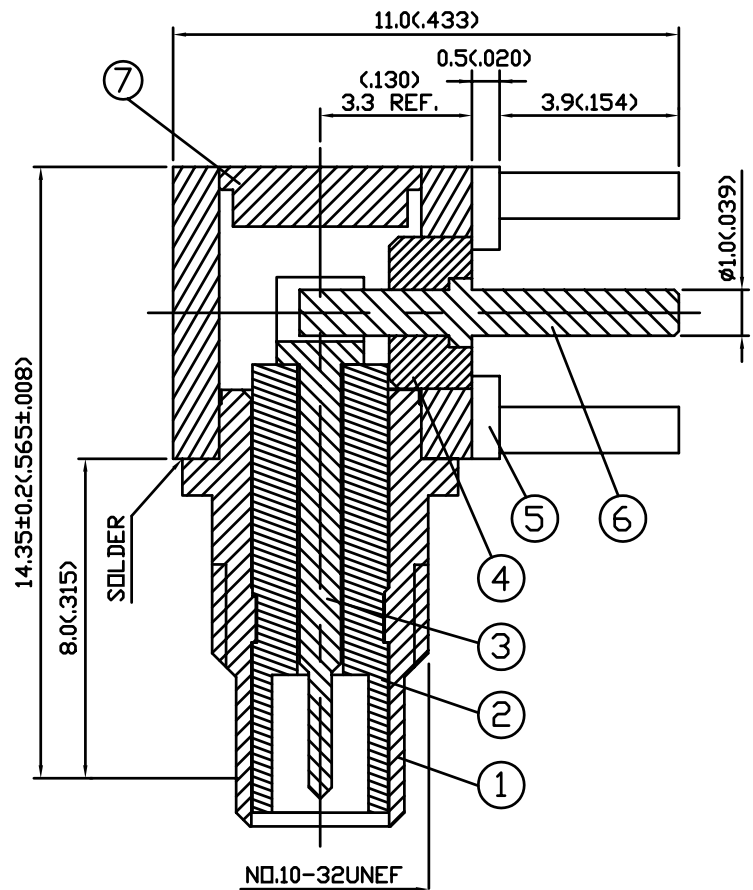

(1) $\phi 1.5(.059)$ MIN.
(4) $\phi 1.4(.055)$ MIN.

MOUNTING HOLE

NOTES: UNLESS OTHERWISE SPECIFIED

1. BODIES: BRASS PER JIS-C3604
2. CENTER CONTACT: BRASS PER JIS-C3604
3. INSULATION: TEFLON PER ASTM D1457 AND ASTM D1710
4. CONNECTOR INTERFACE PER MIL-STD-348A
5. PART TO BE CLEAN AND FREE OF BURRS

NO	DESCRIPTION	MATERIAL	Q'TY	FINISH
7	CAP	BRASS	1	GOLD 3μ " MIN.
6	CENTER CONTACT	BRASS	1	GOLD 30μ " MIN.
5	BODY	BRASS	1	GOLD 3μ " MIN.
4	INSULATION	TEFLON	1	NONE
3	CENTER CONTACT	BRASS	1	GOLD 30μ " MIN.
2	INSULATION	TEFLON	1	NONE
1	BODY	BRASS	1	GOLD 3μ " MIN.

製圖	DRAWN	TOLERANCE	品名	26-10 (50 Ω)	DATE	版次	REV.
	袁金玉						
檢圖	CHECK	.XX ± 0.1	單位	DWG.NO.	26-0010		
	袁金華	.XXX ± 0.05					
認定	APPROVAL	ANGLE $\pm 5^\circ$	比例	SCALE	佳楠精密電子股份有限公司 CHIN NAN PRECISION ELECTRONICS CO.,LTD.		
	蘇文申	8:1					