

Type

Abox 025

80 x 80 x 52 mm

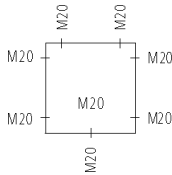

Description

IP 65 junction box complying with DIN VDE 0606, $U_i=690$ V, with M20 self-sealing soft entry membranes, seal range 2-16 mm, cable range 1-4 mm²

Abox 025 L – empty, grey

Abox 025 – 2.5², grey,
5-pole 1.5-4 mm² screw terminal
(4 x 1.5² / 4 x 2.5² / 3 x 4²)

Abox 025 SL – 2.5², grey,
5 screwless terminals 5 x 1- 2.5 mm²

Abox 025 L – empty, white

Abox 025 – 2.5², white,
5-pole 1.5-4 mm² screw terminal
(4 x 1.5² / 4 x 2.5² / 3 x 4²)

Abox 025 SB – empty, red Top
to identify safety power circuits to comply with
DIN VDE 0108

Recommended accessories:

IP 68 cable gland with lock-nut
M 20 (seal range 6-12 mm)

M 20 IP 54 mini-conduit adapter, grey
M 20 IP 54 mini-conduit adapter, white

NEW

Order N°

Packing Qty

802 907 01 60 / 3

802 407 01 60 / 3

802 807 01 60 / 3

802 607 01 60 / 3

802 107 01 60 / 3

802 707 01 60 / 3

227 420 01 50

233 455 01 240 / 20

233 655 01 240 / 20

Abox 025 AB

80 x 80 x 52 mm

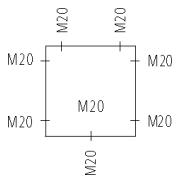

IP 65 junction box complying with DIN VDE 0606, $U_i=690$ V, with M20 self-sealing soft entry membranes, seal range 2-16 mm,
with external fixing lugs

Abox 025 L – empty,
grey

Abox 025 – 2.5²,
grey, 5-pole 1.5-4 mm² screw terminal
(4 x 1.5² / 4 x 2.5² / 3 x 4²)

Abox 025 SL – 2.5²,
grey, 5 screwless terminals 5 x 1- 2.5²

Recommended accessories:

Set of lead seals

IP 68 cable gland with lock-nut
M20 (seal range 6 - 12 mm)

M20 IP 54 mini-conduit adapter, grey

NEW

803 907 01 60 / 3

803 407 01 60 / 3

803 807 01 60 / 3

890 010 01 10

227 420 01 50

233 455 01 240 / 20

ABOX SERIES



Type

Abox 040

93 x 93 x 55 mm

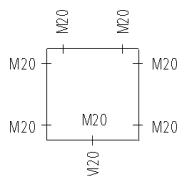

Description

IP 65 junction box complying with DIN VDE 0606, $U_i=690$ V, with M20 self-sealing soft entry membranes, seal range 2-16 mm, cable range 1-4 mm²

Abox 040 L – empty, grey

804 907 01

60 / 3

Abox 040 – 4², grey,
5-pole 1-4 mm² screw terminal
(4 x 1.5² / 4 x 2.5² / 3 x 4²)

804 407 01

60 / 3

Abox 040 L – empty, white

804 607 01

60 / 3

Abox 040 – 4², white,
5-pole 1.5-4 mm² screw terminal
(4 x 1.5² / 4 x 2.5² / 3 x 4²)

804 107 01

60 / 3

Recommended accessories:

IP 68 cable gland with lock-nut

227 420 01

50

M20 (seal range 6 - 12 mm)

227 421 01

30

M20 (" 7 - 14 mm)

M 20 IP 54 mini-conduit adapter, grey

233 455 01

240 / 20

M 20 IP 54 mini-conduit adapter, white

233 655 01

240 / 20

Abox 060

110 x 110 x 67 mm

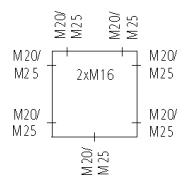

IP 65 junction box complying with DIN VDE 0606, $U_i=690$ V, with IP 54 extension pieces and M25 locking seals, seal range 9-18.5 mm

Abox 060 L – empty,
grey

806 907 01

24 / 2

Abox 060 – 6²,
grey, 5-pole 6 mm² high-set screw terminal
(4 x 2.5² / 4 x 4² / 3 x 6²)

806 407 01

24 / 2

Recommended accessories:

Set of lead seals

890 010 01

10

IP 68 cable gland with lock-nut

227 420 01

50

M20 (seal range 6 - 12 mm)

227 421 01

30

M20 (" 7 - 14 mm)

227 425 01

25

M25 (" 7 - 16 mm)

IP 66 double membrane spouts

260 420 01

600 / 50

M20 (seal range 7 - 12 mm)

260 425 01

600 / 50

M25 (" 9 - 16 mm)

NS 35 DIN rail

81 mm

198 081 01

1

Mounting plate from insulating material

83 x 83 mm

895 006 01

1

Type

Abox 100
140 x 140 x 79 mm

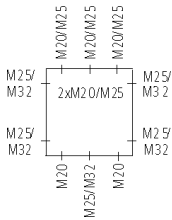

Description

IP 65 junction box complying with DIN VDE 0606, $U_i=690$ V, with IP 54 extension pieces and M32 locking seals, seal range 11- 23 mm

Abox 100 L – empty,
grey

Abox 100 – 10²,
grey, 5-pole 10 mm² high-set screw terminal
(4 x 4² / 4 x 6² / 4 x 10²)

Recommended accessories:
Set of lead seals

IP 68 cable gland with lock-nut
M20 (seal range 6 - 12 mm)
M20 (" 7 - 14 mm)
M25 (" 7 - 16 mm)
M32 (" 11 - 21 mm)

IP 66 double membrane spouts
M25 (seal range 9 - 16 mm)
M32 (" 14 - 21 mm)

NS 35 DIN rail 106 mm
Mounting plate from insulating material 109 x 109 mm

Order N° Packing Qty

810 910 01	20 / 2
810 410 01	20 / 2
890 010 01	10
227 420 01	50
227 421 01	30
227 425 01	25
227 432 01	10
260 425 01	600 / 50
260 432 01	300 / 25
198 106 01	1
895 010 01	1

Abox 160
180 x 180 x 91 mm

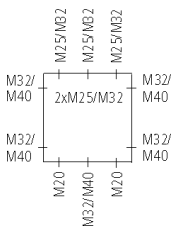

IP 65 junction box complying with DIN VDE 0606, $U_i=690$ V, with IP 54 extension pieces and M40 locking seals, seal range 17-30 mm, with lead seal set

Abox 160 L – empty,
grey

Abox 160 – 16²,
grey, 5-pole 16 mm² high-set screw terminals
(4 x 6² / 4 x 10² / 4 x 16²)

Recommended accessories:

IP 68 cable gland with lock-nut
M20 (seal range 6 - 12 mm)
M20 (" 7 - 14 mm)
M25 (" 7 - 16 mm)
M32 (" 11 - 21 mm)
M40 (" 16 - 28 mm)

IP 66 double membrane spouts
M25 (seal range 9 - 16 mm)
M32 (" 14 - 21 mm)

NS 35 DIN rail 144 mm
Mounting plate from insulating material 149 x 149 mm

816 910 01	10 / 1
816 410 01	10 / 1
227 420 01	50
227 421 01	30
227 425 01	25
227 432 01	10
227 440 01	5
260 425 01	600 / 50
260 432 01	300 / 25
894 016 01	1
895 016 01	1

ABOX SERIES



Type

Abox 350
250 x 250 x 115 mm

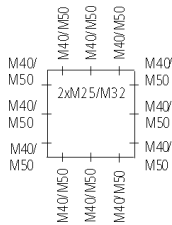

Description

IP 65 junction box complying with DIN VDE 0606, $U_i=690$ V, with IP 54 extension pieces and M40 locking seals, seal range 17- 30 mm, with lead seal set

Abox 350 L – empty,
grey

Order N°

Packing Qty

835 910 01

4 / 1

Abox 350 – 35²,
grey, 5-pole 35 mm² high-set screw terminal
(4 x 16² / 4 x 25² / 4 x 35²)

835 410 01

4 / 1

Recommended accessories:

IP 68 cable gland with lock-nut
M40 (seal range 16 - 28 mm)
M50 (" 21 - 34.5 mm)

227 440 01

5

227 450 01

5

NS 35 DIN rail 216 mm
Mounting plate from insulating material 217 x 217 mm

894 035 01

1

895 035 01

1

Abox 700
450 x 300 x 132 mm

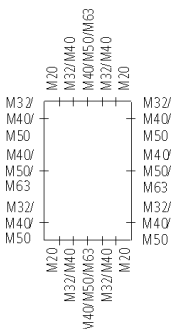

IP 65 junction box, $U_i=690$ V, with 3 twist nipples and lock-nut, IP 54, M63, seal range 24-43 mm, may be sealed with standard leads

Abox 700 L – empty,
grey

870 910 01

1

Abox 700 – 70²,
grey, 4 terminal blocks 4 x 70 mm²

870 410 01

1

Recommended accessories:

IP 68 cable gland with lock-nut
M40 (seal range 16 - 28 mm)
M50 (" 21 - 34.5 mm)
M63 (" 32 - 44.5 mm)

227 440 01

5

227 450 01

5

227 463 01

5

NS 35 DIN rail 216 mm
Mounting plate from insulating material 390 x 240 mm

562 035 01

1

795 003 01

1

Adapter for 5-pole connection 1 Block 4 x 70 mm² 840 070 01 1



Type

Abox HA 250

250 x 250 x 115 mm

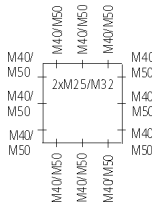

Description

IP 65 interface box complying with DIN VDE 0606, $U_i=400$ V, with 25 mm² main cable branching terminal, IP 54 adapters and M40 locking seals, M50 twist nipple, 4-pole 25 mm² screw terminal, 2 x 25 mm² entry per pole, 4 x 16 mm² exit per pole, with lead seal set

grey

NEW

Recommended accessories:

IP 68 cable gland with lock-nut
M40 (seal range 16 - 28 mm)
M50 (" 21 - 34.5 mm)

Order N°

Packing Qty

480 425 01

4 / 1

227 440 01

5

227 450 01

5

Abox HA 350

250 x 250 x 115 mm

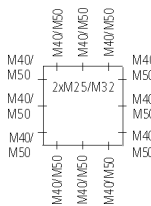

IP 65 interface box complying with DIN VDE 0606, $U_i=400$ V, with 35 mm² main cable branching terminal, IP 54 adapters and M 40 locking seals, M 50 twist nipple, 4-pole 35 mm² screwterminal, 2 x 35 mm² entry per pole, 4 x 35 mm² exit per pole, with lead seal set

grey

NEW

Recommended accessories:

IP 68 cable gland with lock-nut
M40 (seal range 16 - 28 mm)
M50 (" 21 - 34.5 mm)

480 435 01

4 / 1

227 440 01

5

227 450 01

5

Type Abox terminals



Description	Order N°	Packing Qty
Junction terminal complying with DIN EN 60998 / VDE 0613, $U_i=690$ V,		
for		
Abox/Nautic 025/040 5-pole-1-4 mm ² (4 x 1.5 ² / 4 x 2.5 ² / 3 x 4 ²)	840 004 01	10
Abox/Nautic 060 5-pole-6 mm ² (4 x 2.5 ² / 4 x 4 ² / 3 x 6 ²)	840 006 01	5
Abox/Nautic 100 5-pole-10 mm ² (4 x 4 ² / 4 x 6 ² / 4 x 10 ²)	840 010 01	5
Abox/Nautic 160 5-pole-16 mm ² (4 x 6 ² / 4 x 10 ² / 4 x 16 ²)	840 016 01	2
Abox/Nautic 350 5-pole-35 mm ² (4 x 16 ² / 4 x 25 ² / 4 x 35 ²)	840 035 01	1
Abox/Nautic 700* 1-pole-70 mm ²	840 070 01	1
Abox 1500 1-pole-150 mm ² *	076 125 01	1
Abox 2400 1-pole-240 mm ² *	076 140 01	1
Abox/Nautic 040 Voltage terminal 16/6 ²	462 166 01	10

*VDE approval in preparation

Lead seal set



Lead seal set for Abox / Nautic 025 to 100 junction boxes (from Abox / Nautic 160 can be sealed with standard leads)	890 010 01	10
--	------------	----

Cable entries

for Nautic 700 / 1500 / 2400



Plug-in type cable entry with pleated rubber for cables under tension up to 75 mm diameter			
Width 320 mm	2 x 75 mm Ø	073 032 01	5 / 1
Width 440 mm	3 x 75 mm Ø	073 043 01	5 / 1

Cleats

Nautic 700 / 1500 / 2400

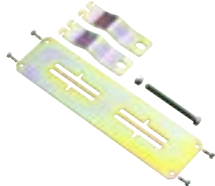

Cleats for cables up to 75 mm			
Width 320 mm for	1 x 75 mm	073 003 01	10 / 1
Width 440 mm for	1 x 75 mm	073 004 01	5 / 1
Recommended accessories: additional clamp for 2nd cable up to 75 mm		073 075 01	50 / 1

DIN rails

NS 35



35 mm DIN rail incl. fixing screws, for			
Abox 060	Length 81 mm	198 081 01	1
Abox 100	Length 106 mm	198 106 01	1
Abox 160	Length 144 mm	894 016 01	1
Abox 350	Length 216 mm	894 035 01	1
Abox 700 (with plastic bearer)	Length 216 mm	562 035 01	1

Mounting plates



Mounting plate from insulating material for installing devices with base fixing, incl. fixing screws, for			
Abox 060	83 x 83 mm	895 006 01	1
Abox 100	109 x 109 mm	895 010 01	1
Abox 160	149 x 149 mm	895 016 01	1
Abox 350	217 x 217 mm	895 035 01	1
Abox 700	390 x 240 mm	795 003 01	1