

Cable insertion system with bending protection spiral for additional reliability



## SKINTOP® CLICK BS

### Application

The innovative CLICK system now also available with additional bending protection for flexible cables. Cables for electrical appliances and machinery, which are moved under normal use, must be protected against excessive bending, as required in accordance with VDE 0730. Safety feature for flexible cables used in e. g.:

- Hand-held equipment
- Flexing machine parts
- Apparatus engineering
- Light and sound applications
- Robotics industry

### Advantage

- Up to 70% time saving due to innovative snap-in system
- Simple, free assembly in any position
- Fewer parts, counter nut no longer needed
- Captive
- No thread required
- Protected against vibration
- Maximum quality
- Strain relief in acc. with EN 50262
- IP 68, hermetically sealed
- Reliable bending protection for cable conservation and functional reliability

### Note

- Disassembly tool contained in the delivery scope

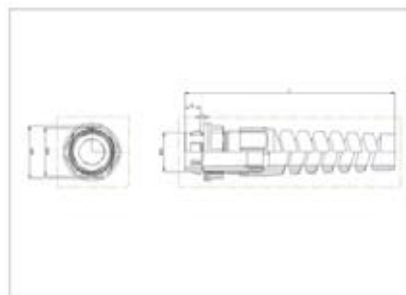

## Technical Data

**RAL** Colour delivered  
RAL 7001 silver-grey  
RAL 7035 light grey  
RAL 9005 black / UV resistant

**Material**  
Body: special polyamide  
Seal: special elastomer

**IP** Degree of protection  
IP 68

**°C** Range of temperature  
-20°C up to +100°C

Part number	Part designation / size	S (wall thickness mm)	Clamping range mm	M (hole mm)	SW1 / SW2 mm	D mm	C mm	PU pieces
<b>SKINTOP® CLICK BS light grey</b>								
53112888	CLICK BS 16	1 - 4	5 - 9	16,3 (-0,2)	19 / 22	8	94	50
53112889	CLICK BS 20	1 - 4	7 - 13	20,3 (-0,2)	25 / 27	8	108	25
53112890	CLICK BS 25	1 - 4	9 - 17	25,3 (-0,2)	30 / 34	8	127	25
<b>SKINTOP® CLICK BS silver-grey</b>								
53112906	CLICK BS 16	1 - 4	5 - 9	16,3 (-0,2)	19 / 22	8	94	50
53112907	CLICK BS 20	1 - 4	7 - 13	20,3 (-0,2)	25 / 27	8	108	25
53112908	CLICK BS 25	1 - 4	9 - 17	25,3 (-0,2)	30 / 34	8	127	25
<b>SKINTOP® CLICK BS black</b>								
53112909	CLICK BS 16	1 - 4	5 - 9	16,3 (-0,2)	19 / 22	8	94	50
53112911	CLICK BS 20	1 - 4	7 - 13	20,3 (-0,2)	25 / 27	8	108	25
53112912	CLICK BS 25	1 - 4	9 - 17	25,3 (-0,2)	30 / 34	8	127	25