

UMT 250



IEC 60127-4 · 250/125 VAC/DC · Time-Lag T

**Description**

- Directly solderable on printed circuit boards

Standards

- IEC 60127-4
- UL 248-14
- CSA C22.2 no. 248.14

Approvals

- VDE License Number: 40013121
- UL File Number: E41599

References

[General Product Information](#)

Time-Current Curves see last page

[Packaging Details](#)

Weblinks

Approvals: <http://www.schurter.com/approvals>

RoHS: <http://www.schurter.com/rohs>

Technical Data

| | |
|------------------------------|--|
| Rated Voltage | 250 VAC / 125 VDC |
| Rated Current | 0.315 - 4 A |
| Breaking Capacity | 200 A |
| Characteristic | Time-Lag T |
| Mounting | PCB,SMT |
| Admissible Ambient Air Temp. | -55 °C to 125 °C |
| Climatic Category | 55/125/21 acc. to IEC 60068-1 |
| Material: Housing | Ceramic |
| Material: Terminals | Tin-Plated Copper Alloy |
| Unit Weight | 0.23 g |
| Stock Conditions | 0 °C to 60 °C, max. 70% r.h. |
| Product Marking | ☐ M, Current Rating, Voltage Rating, Characteristic, Breaking Capacity |

| | |
|------------------------------|--|
| Soldering Methods | Reflow, Wave |
| Solderability | 245 °C / 3 sec acc. to IEC 60068-2-58, Test Td |
| Resistance to Soldering Heat | 260 °C / 10 sec acc. to IEC 60068-2-58, Test Td |
| Flammability | min. UL 94V-1 (acc. to EIA/IS-722, Test 4.12) |

Dimensions

Length  10.1 mm

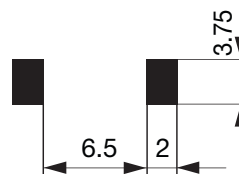
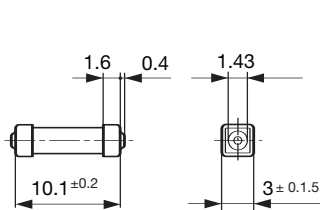

Solder pads reflow soldering

UMT 250

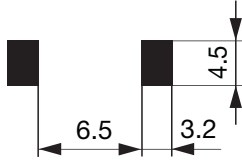







Solder pads wave soldering

Pre-Arcing Time

| Rated Current In | 1.25 x In min. | 2.0 x In max. | 10.0 x In min. | 10.0 x In max. |
|------------------|-------------------|------------------|-------------------|-------------------|
| 0.315 A - 4 A | 60 min | 120 s | 10 ms | 100 ms |

Variants

| Order Number | Rated Current [A] | Rated Voltage [V] | Rated Voltage [VDC] | Breaking Capacity | Voltage Drop 1.0 In max [mV] | Voltage Drop 1.0 In typ [mV] | Power Dissipation 1.25 In typ [mW] | Melting I ² t 10.0 In typ [A ² s] |  |  |  |  |  |  |  |
|--------------|-------------------|-------------------|---------------------|-------------------|---------------------------------|---------------------------------|---------------------------------------|--|--|--|--|--|--|--|--|
| 3403.0161.xx | 0.315 | 250 | 125 | 1) | 750 | 343 | 500 | 0.27 | ● | ● | ● | ● | ● | ● | ● |
| 3403.0162.xx | 0.4 | 250 | 125 | 1) | 700 | 290 | 500 | 0.4 | ● | ● | ● | ● | ● | ● | ● |
| 3403.0163.xx | 0.5 | 250 | 125 | 1) | 600 | 257 | 500 | 0.54 | ● | ● | ● | ● | ● | ● | ● |
| 3403.0164.xx | 0.63 | 250 | 125 | 1) | 500 | 216 | 500 | 1.1 | ● | ● | ● | ● | ● | ● | ● |
| 3403.0165.xx | 0.8 | 250 | 125 | 1) | 400 | 190 | 500 | 1.4 | ● | ● | ● | ● | ● | ● | ● |
| 3403.0166.xx | 1 | 250 | 125 | 1) | 300 | 164 | 500 | 2.8 | ● | ● | ● | ● | ● | ● | ● |
| 3403.0167.xx | 1.25 | 250 | 125 | 1) | 300 | 138 | 1000 | 4.5 | ● | ● | ● | ● | ● | ● | ● |
| 3403.0168.xx | 1.6 | 250 | 125 | 1) | 300 | 124 | 1000 | 6.9 | ● | ● | ● | ● | ● | ● | ● |
| 3403.0169.xx | 2 | 250 | 125 | 1) | 300 | 106 | 1000 | 7.3 | ● | ● | ● | ● | ● | ● | ● |
| 3403.0170.xx | 2.5 | 250 | 125 | 1) | 300 | 124 | 1200 | 7.5 | ● | ● | ● | ● | ● | ● | ● |
| 3403.0171.xx | 3.15 | 250 | 125 | 1) | 300 | 99 | 1500 | 14 | ● | ● | ● | ● | ● | ● | ● |
| 3403.0172.xx | 4 | 250 | 125 | 1) | 300 | 78 | 2000 | 26 | ● | ● | ● | ● | ● | ● | ● |

1) IEC/UL: 200 A @ 250 VAC , p.f. >= 0.95 / 100 A @ 125 VDC

1) UR: 200 A @ 277 VAC, p.f. >= 0.95/ 100 A @ 125 VDC / 35 A @ 250 VDC

1) PSE: 100 A @ 250 VAC / 100 A @ 125 VDC

Packaging Unit

.xx = .11 Plastic Bag (100 pcs.)

.xx = .24 Blister Tape 33 cm Reel (2000 pcs.)

UMT 250

