

REV.	DATE	DESCRIPTION
A	11/19/03	UPDATE DRAWING FORMAT

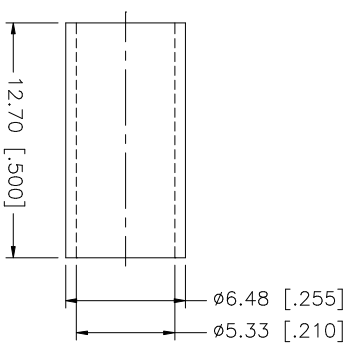
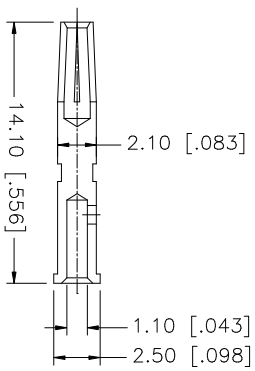
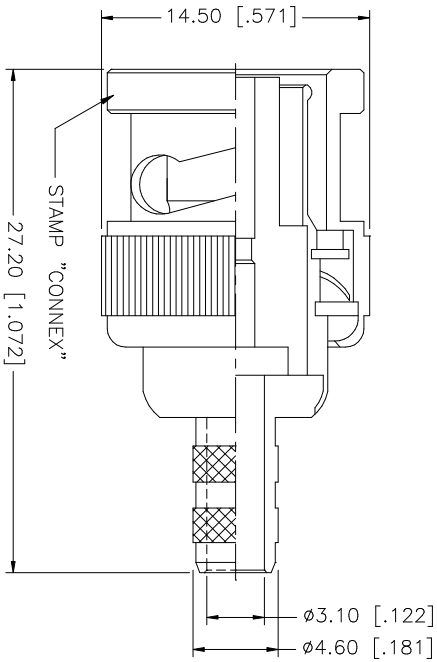
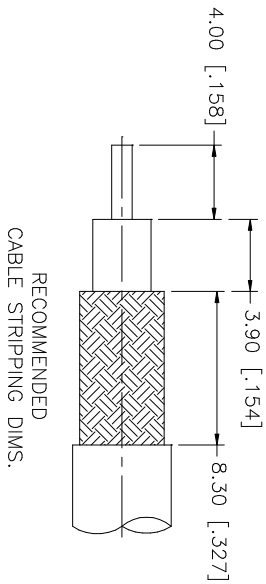

- NOTE:
1. CRIMPED FERRULE  
HEX CRIMP SIZE .213"
  2. CRIMPED CONTACT PIN  
HEX CRIMP SIZE .068"

8				UNLESS OTHERWISE SPECIFIED DIMENSIONS ARE IN MILLIMETERS. DIMENSIONS IN [ ] ARE IN INCHES AND FOR CUSTOMER REFERENCE ONLY.	APPROVALS	DATE	<b>Amphenol Connex</b> <b>BNC REVERSE POLARITY CRIMP PLUG</b> <b>(FOR RG-58C/U CABLE)</b> <b>112116RP</b>	
7				UNLESS OTHERWISE SPECIFIED TOLERANCES FOR MILLIMETERS ARE:	DRAWN	G.R.S.		11/19/03
6				0.5 - 8mm ± 0.20mm	CHECKED			
5				8 - 30mm ± 0.40mm	ISSUED			
4	FERRULE	COPPER	NICKEL	30 - 120mm ± 0.50mm	SHEET	1		OF 1
3	CONTACT PIN	PHOS. BRONZE	GOLD	UNLESS OTHERWISE SPECIFIED TOLERANCES FOR INCHES ARE:	CAD FILE	C:/112/112116RP.DWG		
2	INSULATOR	TEFLON	NATURAL	0.20 - .315 = ± 0.007"	DWG. NO.	112116RP.DWG		
1	BODY	BRASS	NICKEL	.315 - 1.180 = ± 0.015"	REV.	A	SIZE	
	DESCRIPTION	MATERIAL	FINISH	1.180 - 4.724 = ± 0.020"	SCALE	NA		
				DO NOT SCALE DRAWING				