

NOTES

- MATERIAL:** MOLDED USING EITHER FLAME RETARDANT ABS PLASTIC OR POLYSTYRENE
- PARTS:** COMES WITH 2 0.064" BRUSHED ALUMINUM PANELS, AND 4 RUBBER FEET, ABS VERSION COMES WITH M3 0.5 X 10MM PHILLIPS MACHINE SCREWS THREADED INTO BRASS INSERTS. STYRENE COMES WITH #4 X $\frac{3}{8}$ " SELF TAPPING SCREWS.
- COLOR:** CHOICE OF BLACK OR GRAY
- OPTIONS:** PLASTIC FRONT & REAR PANELS, EMI/RFI SHIELDING.

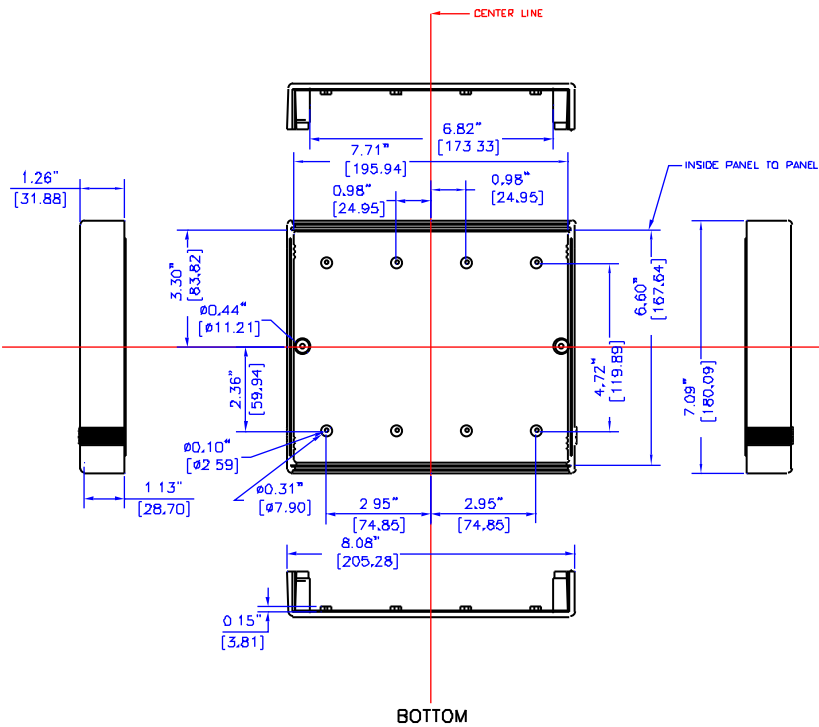

CENTER LINE

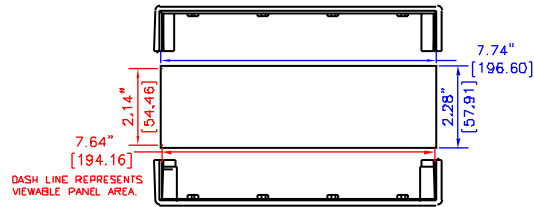
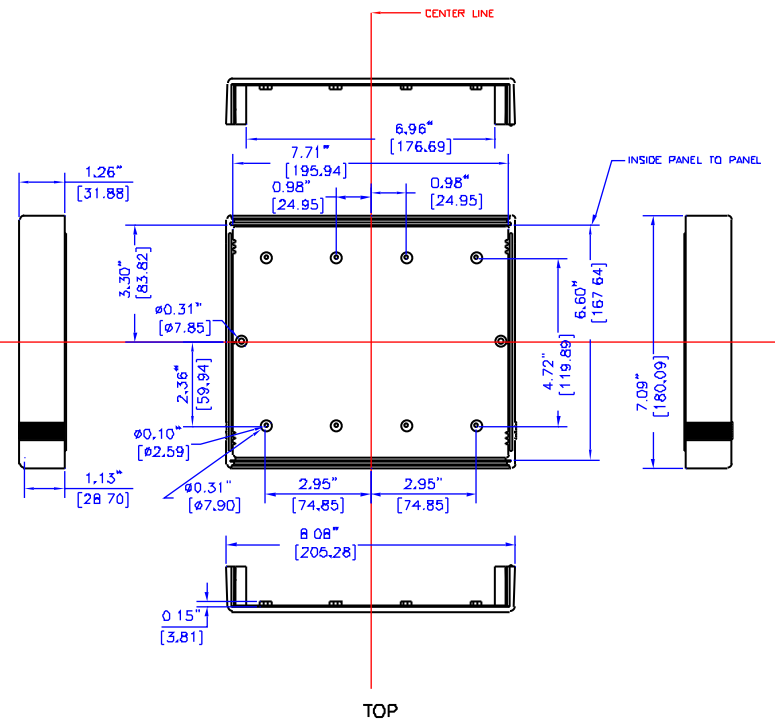

UNLESS OTHERWISE SPECIFIED DIMENSIONS ARE IN INCHES

F	+/- .1
XX	+/- .05
XXX	+/- .015
CUTS	+/- .005
HOLES	+/- .002

NOTES:
HAMMOND MANUFACTURING PROPRIETARY RIGHTS TO THE MATERIAL ON THIS DRAWING. IT IS INTENDED TO BE USED AS A REFERENCE FOR CONSTRUCTION INFORMATION ONLY. THIS INFORMATION MAY NOT BE USED TO REPRODUCE OR MANUFACTURE PRODUCT WITHOUT WRITTEN PERMISSION FROM HAMMOND MANUFACTURING.



HAMMOND MANUFACTURING

WEB: WWW.HAMMONDMFG.COM

TITLE: HAMMOND 1598 SERIES INSTRUMENT ENCLOSURE	
DRAWN BY: MJM	DATE: 06/18/00
SCALE:	PAGE: 1 OF 1
PART NUMBER:	1598D