

Blocks & Holders



French Ferrule Fuses

Modular fuse holders

MSC

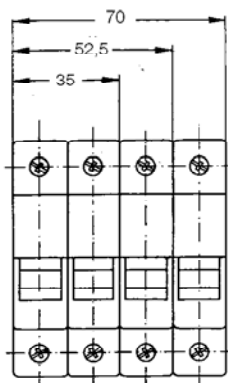
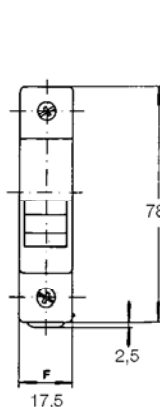
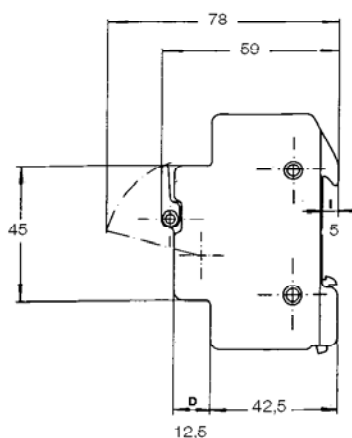

- Blown fuse indicator (120/690V)
- Cable size:
 - unipolar: 1 x 16mm²
 - unipolar + neutre: 1 x 10 mm²
- Provision for locking in versions without indicator.
- IP20



Poles	CATALOG NUMBER		REFERENCE NUMBER		N. Mod. (17,5 mm)	Packing
	Standard	+ indicator	Standard	+ indicator		

MSC 8: Fuse 8x31

In max: 25A ; Vn max: 400V



1	24002	24004	T219253	F222461	1	12
1 + N	24010		B211049		2	6
2	24012		R212604		2	6
3	24014		W213620		3	4
3 + N	24016		C214638		4	3
4	24019		Q216168		4	3
N	24000		Q218215		1	12

Phase + neutral (1mod.)

1 + N	24006	24008	F200772	X201316	1	12
3 + N	24018		J215150		3	4



MSC 10: Fuse 10x38

In max: 32A; Vn max: 690V



1	24202	24204	Q216674	W219784	1	12
1 + N	24210		C212085		2	6
2	24212	24213	F213122	K215151	2	6
3	24214		M215659		3	4
3 + N	24216		E217193		4	3
4	24219		F218735		4	3
N	24000		Q218215		1	12

Phase + neutral (1mod.)

1 + N	24206	24208	Y201317	C211050	2	12
3 + N	24218		S218217		3	4



Assembly pin

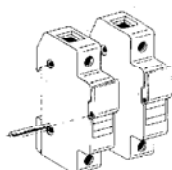

Poles	CATALOG NUMBER	REFERENCE NUMBER	Packing
2	14030	G215125	10
3	14031	Q216145	10
4	14032	A217166	10

Standards: IEC 269-2-1/947, NFC 63.001/63.210, UNE 21103-2-1, 269-2-1, 947-3

Approvals: Bureau Veritas / Lloyd's Register of Shipping

Fuses: See General Purpose Fuses, French Ferrule