

Trimmers — Continued

Miniature Ceramic

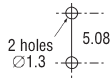

- Ultra miniature ceramic trimmer capacitor
- 5mm Pitch

Drilling plan H (above board) = 6.0, Body dia = 5.0, W (max) = 5.8

Insulation resistance 10MΩ Operating temperature -20°C to +80°C

| Capacitance (pF) | | Temperature Coefficient ppm/°C | Q min @ 10MHz C max. | Voltage Rating V dc | Order Code |
|------------------|------|--------------------------------|----------------------|---------------------|------------|
| 1.5 | 6 | NPO ±250 | 300 | 200 | 148-157 |
| 2.8 | 12.5 | N600 ±250 | 300 | 200 | 148-158 |
| 3.5 | 20 | N750 ±300 | 300 | 200 | 148-159 |
| 5 | 30 | N1500 ±300 | 300 | 200 | 148-160 |
| 5.5 | 50 | N1500 ±500 | 300 | 200 | 148-161 |

CAP29

Order Multiple=5

| Capacitance pF | | Colour Code | Order Code | Price Each | | | |
|----------------|------|-------------|----------------|------------|------|-------|-------|
| Min | Max | | | 5+ | 100+ | 1000+ | 5000+ |
| 1.5 | 6 | Red | 148-157 | | | | |
| 2.8 | 12.5 | Nil | 148-158 | | | | |
| 3.5 | 20 | Blue | 148-159 | | | | |
| 5 | 30 | Yellow | 148-160 | | | | |
| 5.5 | 50 | Green | 148-161 | | | | |

Miniature Ceramic – Washable

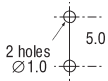

- Washable single turn ceramic trimmer capacitor
- 5mm pitch

Drilling plan H (above board) = 4.8, Body dia. = 6.0

Insulation resistance 10000MΩ Operating temperature -55°C to +85°C

| Capacitance (pF) | | Temperature Coefficient ppm/°C | Q min @ 1MHz, Cmax | Voltage Rating V dc | Mfrs. List No. | Order Code |
|------------------|----|--------------------------------|--------------------|---------------------|----------------|------------|
| 1.5 | 5 | NPO ±200 | 300 | 100 | TZ03Z050ER169 | 108-218 |
| 3 | 11 | N450 ±300 | 500 | 100 | TZ03T110ER169 | 108-219 |
| 4.2 | 20 | N750 ±300 | 500 | 100 | TZ03R200ER169 | 108-220 |
| 5.2 | 30 | N750 ±300 | 500 | 100 | TZ03R300ER169 | 108-221 |
| 6 | 50 | NPO ±300 | 300 | 50 | TZ03Z500ER169 | 108-222 |

CAP109

Order Multiple=5

| Capacitance pF | | Colour Code | Order Code | Price Each | | | | |
|----------------|-----|-------------|-----------------|------------|-----|------|------|-------|
| Min | Max | | | 5+ | 50+ | 100+ | 500+ | 1000+ |
| 1.5 | 5 | Blue | .108-218 | | | | | |
| 3 | 11 | White | .108-219 | | | | | |
| 4.2 | 20 | Red | .108-220 | | | | | |
| 5.2 | 30 | Green | .108-221 | | | | | |
| 6 | 50 | Orange | .108-222 | | | | | |

2222 808 Series – Polyethylene Film Formerly 808 Series

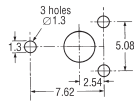
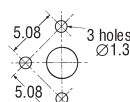

Drilling plan

Drilling plan

H (above board) = 10, (303-835) 11
Body dia = 8.8, (303-835) 11.1

Voltage rating 250V d.c. Climatic category (IEC68) 40/070/21, 40/085/21
Q min @ 1MHz 1000 Operating temperature -40°C to +70°C

Mfrs. List No. 2222 808 11558 = 303-800, 2222 808 11109 = 303-811,
2222 808 11229 = 303-823, 2222 808 32659 = 303-835,
2222 808 31809 = 334-7278, 2222 808 31101 = 334-7280,
2222 808 31121 = 334-7291

CAP30

Order Multiple=5

| Capacitance pF | | Colour Code | Order Code | Price Each | | | |
|----------------|-----|-------------|---------------------|------------|------|-------|-------|
| Min | Max | | | 5+ | 100+ | 1000+ | 3000+ |
| 1.4 | 5.5 | Grey | 303-800 | | | | |
| 2 | 10 | Yellow | 303-811 | | | | |
| 2 | 22 | Green | 303-823 | | | | |
| 5.5 | 65 | Yellow | 303-835 | | | | |
| 6 | 80 | Red | NEW 334-7278 | | | | |
| 7 | 105 | Violet | NEW 334-7280 | | | | |
| 6 | 120 | Violet | NEW 334-7291 | | | | |

2222 809 05 Series – PTFE Film Formerly 809 05 Series

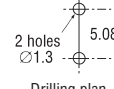

Drilling plan

H (above board) = 11, W = 7.4, D = 6.7

Voltage rating 300V d.c. Climatic category (IEC68) 40/125/21
Q min @ 1MHz 1000 Operating temperature -40°C to +125°C

N.B. Flux Guard treatment to prevent flux penetration.

Mfrs. List No. 2222 809 05215 = 303-847, 2222 809 05217 = 303-859

CAP31

| Capacitance pF | | Colour Code | Order Code | Price Each | | | |
|----------------|-----|-------------|----------------|------------|------|-------|-------|
| Min | Max | | | 1+ | 100+ | 1000+ | 3000+ |
| 1 | 3.5 | Orange | 303-847 | | | | |
| 2 | 18 | Red | 303-859 | | | | |

2222 809 08 Series – PTFE Film Formerly 809 08 Series

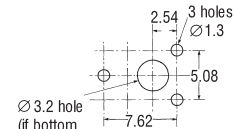

Drilling plan

H (above board) = 11, W = 7.4, D = 6.7

Voltage rating 300V d.c. Climatic category (IEC68) 40/125/21
Q min @ 1MHz 1000 Operating temperature -40°C to +125°C

Mfrs. List No. 2222 809 08002 = 303-860, 2222 809 08003 = 303-872

CAP32

| Capacitance pF | | Colour Code | Order Code | Price Each | | | |
|----------------|-----|-------------|----------------|------------|------|-------|-------|
| Min | Max | | | 1+ | 100+ | 1000+ | 3000+ |
| 4 | 40 | Yellow | 303-860 | | | | |
| 5 | 57 | Blue | 303-872 | | | | |

TZ Series Trimming Tool



- Ceramic bladed trimming tool with plastic handle
- Standard type (minus slot) – blade width 2.2mm
- Ideal for use with TZC03 trimmer capacitors
- Also suitable for other standard trimmers

CAP294

| Mfrs. List No. | Order Code | Price Each | | | |
|----------------|-----------------|------------|-----|-----|------|
| PPTZ-0022 | 353-1764 | 1+ | 10+ | 50+ | 100+ |

Polyester

High performance with a fairly high capacitance per unit volume make these suitable for general purpose applications such as coupling and decoupling.

CAP121

2220 Series – Surface Mount



- Metallised polyester film surface mount
- Applications include signal coupling and bypassing
- Flame retardant plastic case
- Low profile high reliability



Tolerance ±20% Operating temperature -55°C to +100°C
Climatic category 55/100/21 Case tolerance ±0.2