

Universal/'SMART' Indicator

Universal 'SMART' Indicator
Temperature, Pressure, Voltage or Current Input



H = 48, W = 96,
D = 140 (behind bezel), Panel cut out = 92.44

- Large 6 digit high brightness LED display
- Flush clean-line design, sealed to IP65
- User selectable input by means of three membrane keys
- Display can be scaled into user selectable units, e.g. pallets/min
- RFI screened aluminium case with plastic front bezel
- Up to 4 alarms with optional plug-in outputs may be selected
- 4 to 20mA re-transmit option available which plugs in to standard unit



Supply voltage 240V 50/60Hz (120Vac selectable by internal links)
Inputs Any Thermocouple or PT100; Voltage ± 10 , 1-5, ± 1 , ± 0.1 ; Current 4-20mA, 0-10mA, 0-20 mA
Display 6 digit, 7 segment, 14mm LED. 3.3Hz update
Alarm status 4 Panel front discrete LEDs

PM71X

	Mfrs. List No.	Order Code	Price Each		
			1+	5+	10+
Indicator	DM4000U	615-699.			
2 Channel Relay module	OPT400002	615-705.			
4-20mA Transmit module	OPT400003	615-717.			

IP66 Watertight Covers



- Range of covers to give IP66 watertight protection to DIN size panel instruments
- Ideal for applications where panels have to be cleaned or hosed down
- Front cover is made from polycarbonate which can be cleaned using water or ethanol. Seal is chloroprene rubber

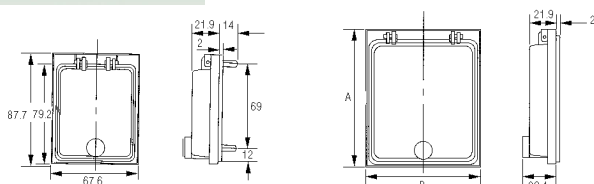

478-027 Panel Cut-out:
45.45 square hole + 2 4.5 dia holes
on fixing centres 69

478-039: A = 131.7, B = 67.6
478-040: A = 107.7, B = 91.6
478-052: A = 131.7, B = 115.6

Mfrs. List No. Y92A-48N = 478-027, Y92A-72N = 478-040
Y92A-49N = 478-039, Y92A-96N = 478-052

PLC111

Size (mm)	Order Code	Price Each			
		1+	5+	10+	25+
48 48	478-027.				
48 96	478-039.				
72 72	478-040.				
96 96	478-052.				

New Products

For more information on new products check out the New Product Guide.

Temperature Transmitters

PT100 or Thermocouple to 4-20mA



- Two transmitters, one PT100 input, one J, K or T thermocouple input (user selectable)
- Both have 4-20mA output
- DIN sized for in head installation
- Screw terminals for inputs and outputs
- Corrosion resist plastic case
- 0.2°C accuracy
- Tested to EN55011, IEC 801-2, 3, 4, for EMC compatibility

H = 23.0, Dia. = 41.8
2 Mounting holes dia. 5.5 @ 33 centres.
Centre hole (sensor wire entry) Dia. = 4.0mm

Output 4-20mA loop powered max. 30mA
Loop supply 10 to 30 Vdc reverse polarity protection
Loop resistance 700 Ω @ 24V
Loop sensitivity 10 μ A/volt
Temperature stability Zero drift typ. 0.02%/°C, Span typ. 0.005%/°C
Ambient temperature 0 to 70°C, (95% humidity, max. non condensing)

PT100 Version
to DIN 43760 100R @ 0°C (2 or 3 wire)
Accuracy $\pm 0.2^\circ\text{C}$ and $+0.2\%$ rdg.
Offset adjustment range dependant
Gain/adjustment 25°C to 500°C
Impedance
Burn out Up scale standard (downscale option)
Cold junction Automatic 0 to 70°C $\pm 0.2^\circ\text{C}$
Temperature range -30 to +400°C

Thermocouple Versions (J,K,T)
Insulated junction J K or T sensor
 $\pm 0.1\%$ FS and cold junction errors
 $\pm 100^\circ\text{C}$, solder link & potentiometer
100 to 1000°C
>1M Ω
J = 0 to +400°C, K = 0 to +1000°C,
T = 0 to +400°C

PLC30X

Sensor Type	Mfrs. List No.	Order Code	Price Each			
			1+	5+	10+	25+
PT100	SEM104PT100	615-675				
Thermocouple	SEM104TC	615-687				

PT100, Thermocouple, mV & Slide Wire to 4-20mA
Programmable



H = 21, Dia = 43 2 mounting holes dia 5.5@33 centres

- Accept temperature sensor, slidewire or mV signal and convert the output to 4-20mA
- Sensor type and range can easily be programmed by windows based software package
- Fitted with screw terminals
- Galvanically isolated
- Corrosion resistant plastic case
- CE Marked

Output 4-20mA (loop powered)
Loop Supply 10-35Vdc (reverse polarity protected)
Inputs PT100: -200 to 850°C (18-390 Ω)
Thermocouple: J,K,T,R,S,E,F & N
mV: -10 to 75mV
Slidewire: 3 wire potentiometer (10 Ω to 390 Ω)

Approvals EN50081-1
EN50082-2
Operating temperature -40 to 85°C
Programming kit Windows based, 3.1 95NT
Kit content: PSU, configurator, software disk
all supplied in compact case

PLC73

Transmitter	Mfrs. List No.	Order Code	Price Each			
			1+	5+	10+	25+
Transmitter	SEM210	161-858				
Programming Kit	RCPW	161-846.				

Linear Dimensions

All linear dimensions appear in (mm) unless otherwise stated.