

Control functions: 2 way – Raise, lower  
 4 way – Raise, lower, right, left  
 6 way – Raise, lower, right, left, forward, reverse

Cable entry (cut to size): 2 way – 9-13mm dia.  
 4 way, 6 way – 8-26mm dia.

Terminal capacity 1 2.5mm or 2 1.5mm cable

Contact breaking capacity 1.5kVA @ 24V, 9.6kVA @ 127V, 15.6kVA @ 220V,  
 24kVA @ 380V(50/60Hz).  
 600W @ 24V dc, 240W @ 110V dc, 190W @ 220V dc,  
 130W @ 440V dc.

Temperature range -25°C to +70°C

Mfrs. List No: XAC-A215 = 177-629, XAC-A04 SPEC 0304 = 177-630,  
 XAC-A06 SPEC 0305 = 177-631.

CTL056

Control Stations	Order Code	Price Each			
		1+	5+	10+	25+ 40+
2 way	.177-629				
4 way	.177-630				
6 way	.177-631				

## 30mm Switches

### Ultra Low Profile IP67-14 Series Illuminated Push Buttons - 5A @250Vac

e a o ■ Swisstac

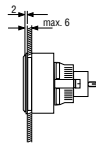

- Ultra low profile - only 2mm protrusion from front panel
- Anodised aluminum bezel
- Self cleaning, double break, snap action switching mechanism
- Gold plated contacts can be used as NC or NO or changeover configuration.
- Sealing to **IP67**
- Approved to **VDE, UL, CSA, SEV, OVE** and **GL**.

Panel cut out = 30.5  
 L = 43, Bezel 35 dia, depth behind panel = 41

CTL189

Voltage	Mfrs. List No.	Order Code	Price Each		
			1+	10+	100+
<b>Push Button - Momentary</b>					
Red	K14-131 . 0252518	<b>593-801</b>			
Green	K14-131 . 0255518	<b>593-825</b>			

### Ultra Low Profile IP65-04 Series Illuminated Push Buttons and Selector Switches - 10A @ 500Vac

e a o ■ Swisstac

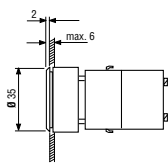

Back of Panel:  
**D=55, W=40 (Illuminated Push Button, Indicator)**  
**D=39, W=40 (Non-Illuminated Push Button, Selector Switch)**  
 Add 23mm per contact block

Contact Block Selector Switch

- Ultra low profile - only 2mm protrusion from front panel
- Anodised aluminum bezel
- Self cleaning, double break, snap action switching mechanism
- Up to 3 contact blocks can be snapped into each actuator
- Sealing to **IP65**
- Approved to **UL, CSA, SEV, NEMKO** and **GL**.

CTL190

Voltage	Mfrs. List No.	Order Code	Price Each		
			1+	10+	100+
<b>Illuminated Push Button Actuators - Momentary</b>					
Red	704-030 . 218	<b>593-898</b>			
Green	704-030 . 518	<b>593-916</b>			
<b>Illuminated Push Button Actuators - Latching</b>					
Red	704-060 . 218	<b>593-930</b>			
Green	704-060 . 518	<b>593-953</b>			
<b>Selector Switch - Actuators</b>					
2 Position	704-410 . 018	<b>594-064</b>			
3 Position	704-402 . 018	<b>594-076</b>			
<b>Contact Block - Screw Terminal</b>					
1 NO Contact	704-900 . 1	<b>594-088</b>			
2 NO Contact	704-900 . 3	<b>594-090</b>			
1 No, 1 NC Contact	704-900 . 5	<b>594-106</b>			

## 30.5mm Pushbuttons

CUTLER HAMMER

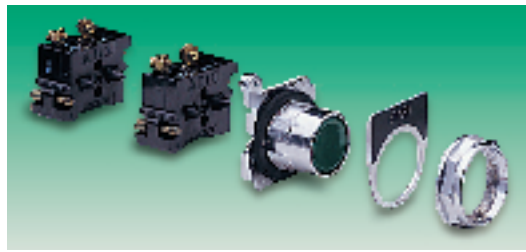

Contacts, Operator, Legend, Bezel

- Modular 30.5mm pushbutton range
- Versatile, durable and flexible
- Oil tight to IP65 protection

This range of modular 30.5mm pushbuttons is versatile, durable, flexible and lasts the test of time even under the most hostile environments. The modular design enables the pushbuttons to be configured in a number of ways by utilising different types of operators, pushbuttons, selector switches, mushroom and palm buttons, indicating lights, contactors, enclosures and joystick controllers.

PR0002

## Operators – Flush Button

CUTLER HAMMER

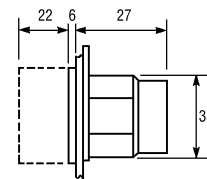

Max. frequency of operations 6000/hr.  
 Mechanical life 10 106

- Range of flush button operators in selection of colours to suit application
- Oil tight to IP65 with neoprene rubber seal
- Fully compliant with IEC947-5-1
- Panel thickness adjustable between 1.6 and 8mm
- Chrome finish for maximum durability

PR0001

Colour	Order Code	Price Each				
		1+	10+	20+	50+	100+
Black	<b>710-0966</b>					
Red	<b>710-0978</b>					
Green	<b>710-0980</b>					
Yellow	<b>710-0991</b>					

## Bare Shaft Operator

CUTLER HAMMER



- Fully compliant with **IEC 947-5-1**
- Range of momentary push and latch operators
- Choice of 38mm and 63.5 mm pushes

This range of 30.5mm bare shaft operators is compatible with either a 38mm mushroom push or a 63.5mm palm push.

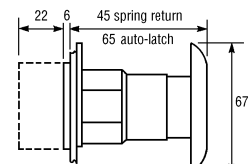
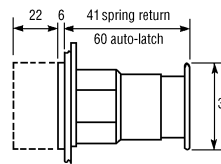

Operator, momentary	Max. Frequency of Operations	Mechanical Life	Order Code
	6000/hr.	10x106 operations	710-1703
	1200/hr	10x106 operations	710-1715

PR0003

Type	Mfrs' List No.	Order Code	Price Each			
			1+	10+	20+	50+
Momentary	91000T100	<b>710-1703</b>				
Auto-latch	91000T140	<b>710-1715</b>				
Black mushroom	91000T281	<b>710-1727</b>				
Red mushroom	91000T282	<b>710-1739</b>				
Red palm	91000T292	<b>710-1740</b>				

continued