

## R.F. Connector Accessories — Continued

### Insulating Washers

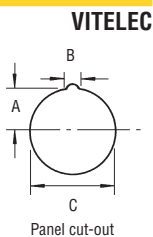

Style	A	B	C	Order Code
Bulkhead jack	7.93	2.28	16.00	234-266
Bulkhead socket	5.72	2.35	11.65	234-278



Two sizes of nylon washers for insulating BNC and TNC bulkhead jacks and sockets.  
Supplied in packs of 10.

Mftrs. List No. VIW10315 = 234-266, VIW1094 = 234-278

crf125

10 Per Pack	Order Code	1+	10+	25+	50+
Bulkhead jack	<b>234-266</b>				
Bulkhead socket	<b>234-278</b>				

### Strain Relief Sleeves

For use with BNC, TNC & UHF crimp connectors

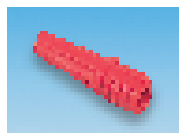

Colour	Cable types		
	RG174, 179, UR95	RG58, UR43, 76, 202	RG59, 62, UR70
Green	—	151-811	151-819
Blue	—	151-812	151-820
Yellow	—	151-814	151-822
Red	—	151-815	151-823
Grey	—	151-816	—
White	—	—	151-825
Black	151-810	151-818	151-826

Mftrs List No. 10641298 = 151-810, 10872098 = 151-811, 10872198 = 151-812, 10872398 = 151-814, 10872498 = 151-815, 10872598 = 151-816, 10872998 = 151-818, 10873098 = 151-819, 10873198 = 151-820, 10873398 = 151-822, 10873498 = 151-823, 10873898 = 151-825, 10873998 = 151-826

crf122

10 Per Pack	Order Code	1+	5+	10+	50+	100+
.All Colours						

### BNC, N, TNC and Twinax

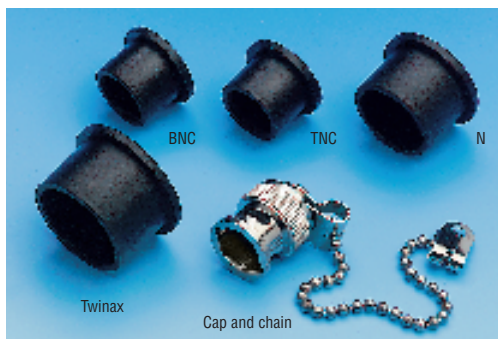

- All caps fit female jack sockets
- Caps provide protection against dust and damage
- Plastic versions push-fit on to jack sockets
- BNC cap and chain twist locks on to jack
- Metal version nickel plated brass

Best value

crf131

10 Per Pack	Nom. I/D	Order Code	1+	8+	48+	100+
<b>Plastic Caps</b>						
BNC/TNC	10.4mm	<b>779-763</b>				
N	15.5mm	<b>779-787</b>				
Twinax	18.5mm	<b>779-775</b>				
<b>1 Per Pack</b>						
<b>Metal</b>			1+	8+	48+	100+
BNC cap & chain (3mm tab fixing)		<b>779-751</b>				

### Standard WECO Patching, 75Ω



- Nickel bodies
- Gold plated centre contacts
- Beryllium copper finger springs
- Teflon dielectric

New

Mftrs. List No. Order Code

<b>BNC to WECO Adaptor</b>		
WECO plug to BNC	AD1WHD	356-3868
<b>WECO Patching</b>		
Single patch jack to BNC	J3W	356-3870
Dual std. jack (non-terminating)	J314W	356-3881
Dual std. jack (terminating)	J314WT	356-3893
Standard patch cord (0.9m)	PCW-36-75	356-3900

CRF162

Mftrs. List No.	Order Code	1+	10+	25+	100+	250+	500+
AD1WHD	<b>356-3868</b>						
J3W	<b>356-3870</b>						
J314W	<b>356-3881</b>						
J314WT	<b>356-3893</b>						
PCW-36-75	<b>356-3900</b>						

### Miniature WECO Patching, 75Ω

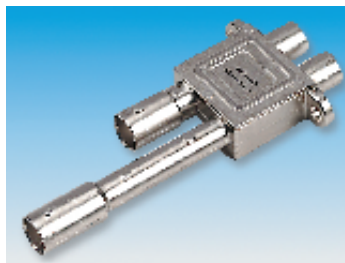

- Nickel bodies
- Gold plated centre contacts
- Beryllium copper finger springs
- Teflon dielectric

New

Dual mini jack (non-terminating)	Mftrs. List No. J314MW	Order Code 356-3923
Dual mini jack (terminating)	J314MWT	356-3935

CRF166

Order Code	1+	10+	25+	100+	250+	500+
<b>356-3923</b>						
<b>356-3935</b>						

### BNC Patch Panel, 19" Rack Type

Available in Bulkhead Socket or Bulkhead Jack Cut-out

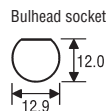
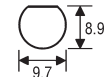
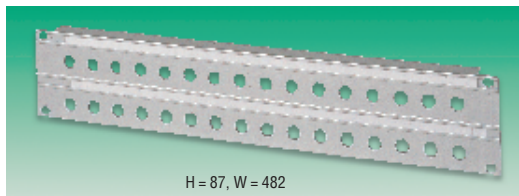

- Aluminium BNC patch panel with 32 punched cut-outs
- 19" rack mounting, 2U high. Bulkhead socket and Jack versions
- Both types have recessed strip for label or logos

crf141

Order Code	1+	5+	10+	25+
Bulkhead socket 8.9 9.7				
<b>474-861</b>				
Bulkhead jack 12 12.9				
<b>474-873</b>				

### Patch Panel

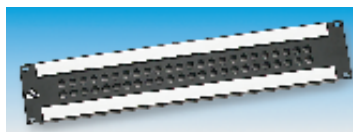

TROMPETER ELECTRONICS, INC.

New

- 19" aluminium punched panel
- For standard and miniature WECO jacks

CRF175

Mftrs. List No.	Order Code	1+	10+	25+	100+
48W standard WECO jacks	JSIB-48/J314WT				
	<b>356-3911</b>				
64 miniature WECO jacks	JSMW64D/J314MW				
	<b>356-3947</b>				