

## 4mm, Wide Cable Entry



L = 48.75, Dia = 10, Cable entry = 7.1 max.

Current rating 10A  
Contact resistance 10mΩ max.

FOR SUITABLE SPEAKER CABLE SEE SECTION 5



4mm plugs suitable for large diameter loud-speaker cable. The plugs feature a large solder bucket, which may be crimped, and will accept a conductor of 5.5mm diameter. Also available with extra screw termination option. Finished with nickel or 0.5 micron gold plated contacts, and a red or black acetal screw-on cover.

Mfrs. List No.	Order Code	Price Each			
		1+	5+	50+	100+ 500+
<b>Nickel – Solder Termination</b>					
Red 579-0500	<b>152-284</b>				
Black 579-0100	<b>152-285</b>				
<b>Gold – Solder Termination</b>					
Red 580-0500	<b>152-286</b>				
Black 580-0100	<b>152-287</b>				
<b>Nickel – Screw Termination</b>					
Red 583-0500	<b>582-440</b>				
Black 583-0100	<b>582-451</b>				
<b>Gold – Screw Termination</b>					
Red 584-0500	<b>582-463</b>				
Black 584-0100	<b>582-475</b>				

CA076

## Finger Proof to BS EN60065 Multi-Termination

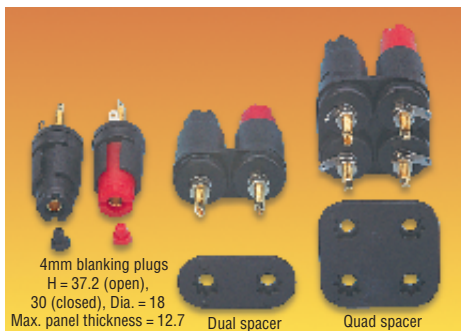

4mm blanking plugs  
H = 37.2 (open),  
30 (closed), Dia. = 18  
Max. panel thickness = 12.7

Dual spacer

Quad spacer

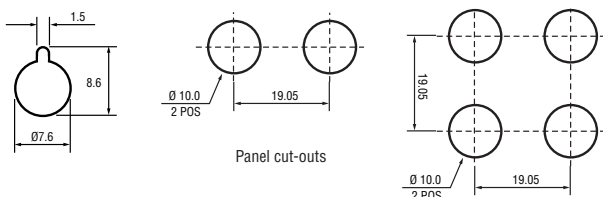

- Comply with BS EN60065 Section 15 requirements
- 4mm blanking plugs to comply with Euro legislation
- Terminates up to 5mm dia. wire
- Fork terminal access slot
- Multi-angle cable entry on dual and quad assemblies
- Tightened via coin slot or spanner
- Top entry 4mm banana socket

Current rating 30A @ 1000V  
Housing Acetal  
Contacts Solder tag  
Brass, nickel plated  
Brass, tin plated

FOR SUITABLE FORK TERMINAL SEE OPPOSITE

CA075

Mfrs. List No.	Order Code	Price Each			
		1+	10+	50+	100+
<b>Single Terminal</b>					
Red 574-0500	<b>662-112</b>				
Black 574-0100	<b>662-124</b>				
<b>Black Spacers 5 Per Pack</b>					
Dual 574-0010	<b>662-136</b>	1+	5+	10+	50+
Quad 574-0020	<b>662-148</b>				

## Fixed Prices

We aim to maintain all prices in this book for the lifetime of this issue.

## 'Speakon'-2 Pole

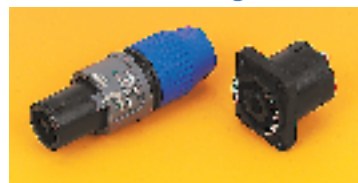

- 2-pole SPEAKON version
- High current contacts - non arcing
- Positive Keying and Latching
- Plug mates with 4 pole socket
- Small size
- Fully CE marked
- EMC shielded. Specifications as per pole below

CA077

Mfrs. List No.	Order Code	Price Each			
		1+	10+	50+	100+ 500+
Plug NL2FC	<b>310-4394</b>				
Socket NL2MP	<b>310-4400</b>				

## 'Speakon' – 4 Pole



Plug L = 73, Dia = 29.10  
Coupler L = 54, Dia. = 24  
Socket H = 31.0, W = 26.0, D = 27.0  
Cable entry = 6–15

Meeting the requirements of all major broadcasting authorities, these rugged, 'Quicklock' latching 4-pole connectors are for professional loudspeaker/amplifier interconnections. For ease of assembly, all terminations are solderless. The chassis socket is airtight, and fits cut-outs for existing audio connector types. The coupler enables in-line connection of two plugs for cable extensions.

All contacts are 'touch proof' and meet the safety requirements of IEC65/348.

Current rating 30A rms (per contact) continuous  
Operating voltage 250V ac  
Test voltage 4250V pp  
Contact resistance ≤ 3mΩ (5000 operations)  
Insulation resistance >10<sup>9</sup>Ω  
Housing PA6, 30% GR  
Contacts Zinc alloy, silver plated  
Insulator PA6, 15% GR  
Temperature range -30°C to +80°C

CA078

Mfrs. List No.	Order Code	Price Each			
		1+	10+	50+	100+ 500+
Plug NL4FC	<b>.152-305</b>				
Socket NL4MP	<b>.152-306</b>				
Coupler NL4MM	<b>.439-101</b>				

## 'Speakon' – 8 Pole



Current rating 30A rms (per contact) continuous  
Operating voltage 250V ac  
Test voltage 4240 Vpp  
Contact resistance ≤ 3mΩ (5,000 operations)  
Insulation resistance IEC68.2.11 : >10<sup>9</sup>Ω  
Housing PA 6.6, 30% GR  
Contacts Zinc alloy, silver plated  
Insulator PA 6.6, 15% GR  
Temperature range -30°C to +80°C

CA079

Mfrs. List No.	Order Code	Price Each			
		1+	10+	50+	100+ 500+
Plug NL8FC	<b>724-567</b>				
Socket NL8MPR	<b>724-579</b>				
Coupler NL8MM	<b>724-580</b>				

- 'Quicklock' 8 pole connectors for loudspeaker/amplifier interconnections, all terminations are solderless
  - Contacts designed to prevent damage (arcing) when disconnected under load.
  - Chassis socket is airtight and fits cut-outs of existing audio connector types.
  - The coupler enables in-line connection of two plugs for cable extensions.
- All contacts are 'touch-proof' and meet safety requirements of IEC65, IEC348.