

Single Turn Potentiometers — continued

9 mm sq Metal Shaft

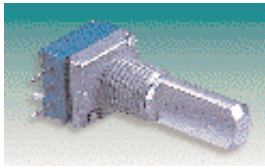

- Compact size PCB mounting
- Ideal for volume, tone and balance control in audio equipment.

ALPS

Body size = 9.5 9.5 D = 7.05 (dual D = 9.55)
 Bush = M7 0.75 L = 20
 642-915, 642-897 Round shaft with slot
 642-903 Flatted shaft

Power rating 0.05W
 Voltage rating 50V a.c.
 Resistance tolerance ±20%

Mfrs. List No. RK0971120K = 642-903,
 RK09712150K = 642-915,
 RK09711110K = 642-897

RP179

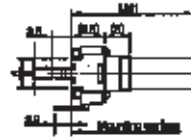

Mfrs. List No. RK09D Series

Mounting into drill viewed from mounting side

RP204

| | Order Code | Price Each | | | |
|--------------------------|----------------|------------|-----|-----|-----|
| | | 1+ | 10+ | 25+ | 50+ |
| Logarithmic | | | | | |
| Round shaft 20K single | 642-903 | | | | |
| Round shaft 50K dual | 642-915 | | | | |
| Linear | | | | | |
| Flatted shaft 10K single | 642-897 | | | | |

| Value | Taper | Order Code | Price Each | | | | |
|-------|-------|----------------|------------|-----|-----|------|------|
| | | | 1+ | 10+ | 50+ | 100+ | 250+ |
| 10K | B | 918-866 | | | | | |
| 10K | A | 918-878 | | | | | |
| 100K | B | 918-891 | | | | | |
| 100K | A | 918-908 | | | | | |

5

338

Resistors, Potentiometers & Thermistors

9mm Sq Metal Shaft

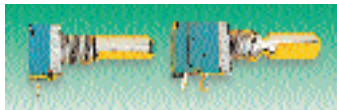

Flatted Shaft = 6 dia Bush = M7 0.75
 Shaft Length = 25 (inc. bush)

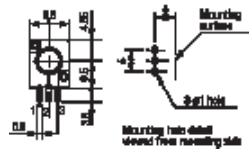

ALPS

- Metal shaft bush mounting
- Available with up to 2 gangs, single to double units
- Low gang error for superior performance

FOR SUITABLE KNOBS SEE BOOK 6, SECTION 7

Mfrs. List No: RK09711 Series

| | | | |
|----------------------|------------------------------|-----------------|-------------------|
| Power rating | 0.05W | Mounting height | 6.5 |
| Voltage rating | 50V a.c. | Voltage rating | 16V d.c. (switch) |
| Resistance tolerance | ±20% | Current rating | 3A (switch) |
| Body length | 7.05 (single) 9.55 (Dual) | | |

A Taper Single Gang

1K = **919-354** 10K = **919-378** 50K = **919-391** 250K = **919-410**
 5K = **919-366** 20K = **919-380** 100K = **919-408**

B Taper Single Gang

10K = **919-469** 50K = **919-482** 100K = **919-494**

RD Taper Single Gang (Reverse Log)

5K = **919-524**

Single Gang with SPDT Switch A Taper

10K = **919-550** 20K = **919-561**

Single Gang with SPDT Switch B Taper

10K = **919-573**

RP202

| Order Code | Price Each | | | | |
|---------------------------------------|------------|-----|-----|------|------|
| | 1+ | 10+ | 50+ | 100+ | 250+ |
| All Values Taper A, B & RD | | | | | |
| All Values with Switch | | | | | |

A Taper Dual Gang

1K = **919-597** 10K = **919-615** 20K = **919-627** 50K = **919-639** 100K = **919-640**

B Taper Dual Gang

1K = **919-676** 10K = **919-690** 20K = **919-706** 100K = **919-720**

Dual Gang with Switch A Taper

10K = **919-780**

| Order Code | Price Each | | | | |
|-----------------------------------|------------|-----|-----|------|------|
| | 1+ | 10+ | 50+ | 100+ | 250+ |
| All Values Taper A & B | | | | | |
| All Values with Switch | | | | | |

9mm Snap-In With Collar



- Vertical snap in design
- Metal collar to support shaft and improve stability
- Enclosed and dust proof

Power rating 0.05W (single)
 0.03W (Dual)
 Voltage rating 50V a.c.
 Resistance tolerance ±20%
 Mechanical rotation 300°

ALPS

11mm Snap-In



Horizontal Bush M9 0.75 Vertical

- Horizontal and vertical mounting
- Sealed units ideal for flow soldering
- Available in two mounting heights
- Bush mounting for overall stability

Power rating 0.05W
 Voltage rating 50V a.c. 20V d.c.
 Resistance tolerance ±20%
 Mechanical rotation 300°

ALPS



Mfrs. List No. RK11K Series

RP208

| Value | Taper | Order Code | Price Each | | | | |
|--|-------|----------------|------------|-----|-----|------|------|
| | | | 1+ | 10+ | 50+ | 100+ | 250+ |
| Horizontal 10mm Mounting Height | | | | | | | |
| 10K | A | 918-970 | | | | | |
| 10K | B | 918-982 | | | | | |
| Horizontal 12.5mm Mounting Height | | | | | | | |
| 10K | A | 919-032 | | | | | |
| Vertical Mounting | | | | | | | |
| 10K | A | 919-093 | | | | | |
| 10K | B | 919-100 | | | | | |
| 20K | B | 919-111 | | | | | |
| 100K | A | 919-123 | | | | | |
| 100K | B | 919-135 | | | | | |

14mm Snap-In Dual

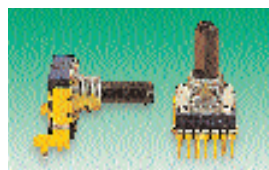

Bush = M9 0.75 Shaft = 6 dia with flat

- Dual potentiometer in one 14mm unit
- Bush mounting for extra stability
- Available in vertical and two horizontal mounting heights

Power rating 0.05W
 Voltage rating 50V a.c.
 Resistance tolerance ±20%
 Mechanical rotation 300°

ALPS

