



	Order Code	1+	4+	20+	40+
2.6 to 5.5mm tap dia.	201-996				
4.6 to 8.0mm tap dia.	202-009				

act348

Circular Diestocks

PRESTO
Engineers Cutting Tools

act354

	Order Code	1+	4+	20+	40+
For 13/16" diameter dies	100-969				
For 1" diameter dies	100-968				

Pipe Threading

Conduit Threader Set

PRESTO
Engineers Cutting Tools

Overall length = 430

- A kit comprising a die stock with screw in handles, two dies M20x1.5mm and M25x1.5mm with two centring guides

act352

	Order Code	1+	4+	20+
	266-553			

Screw Extractors

Screw Extractor Set
5pc

DURATOOL



- For removing broken studs or screws of 3 to 20mm

New

	Order Code	1+	5+	10+
	312-8076			

act369

Drill and Extractor Set



- Five screw extractors and five pilot drills in a metal storage case

Drill sizes 2.5, 3, 4.5, 6, 8
Extractor sizes M3-6, M6-8, M8-11, M11-14, M14-18

Warning! Extractors are hardened and can fracture easily, always use a tap wrench

H = 20 (Closed), W = 111, D = 140

act351

Mftrs. List No.	Order Code	1+	4+	20+	40+
3061	629-935				

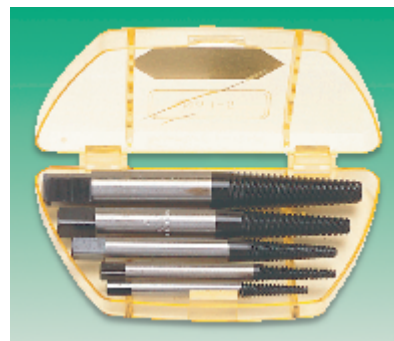

- Set of 5 screw extractors in a storage case for removal of broken studs or screws
- The set covers a range from 3mm to 20mm

WARNING! Extractors are hardened and can fracture easily, always use a tap wrench.

FOR SUITABLE TAP WRENCHES SEE PAGE 1650

act350

Mftrs. List No.	Order Code	1+	4+	20+	40+
3062-1	501-359				

Carbide Milling

Square Shoulder Milling Cutter
90° Positive

Inserts Sold Separately

- A range of milling cutters for surface milling or producing square edge steps
- The cutting inserts are held in place with a locking screw
- Cutting inserts are available separately

Tool angles:

- Radial rake angle 0°
- Lead angle 90°
- Axial rake angle 0°
- Cutting rake angle 0°

For suitable inserts see TPKN 1603, Page 1652.

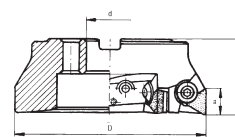

D	H	d	a	Number of Teeth	Mftrs. List No.	Order Code
40	40	16	14.5	3	220.17-040	711-6287

ACT204

Ø	Bore	Order Code	1+	3+	6+	12+
40	16	711-6287				

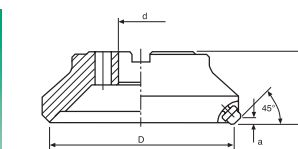
Face Milling Cutters
45° Positive/Negative

Inserts sold separately

- A range of milling cutters for surface milling or producing 45° steps
- The cutting inserts are held in place with a locking screw and inclined anvil
- Cutting inserts are available separately

Tool angles:

- Top-rake angle +6°
- Setting angle 45°
- Axial rake angle +20°
- Radial rake angle -9°

For suitable inserts see SEAN 1203, Page 1652 and SEKN 1203, Page 1652.

D	H	d	a	Number of Teeth	Mftrs. List No.	Order Code
63	40	22	6	5	220.130-063-12	711-6925
80	50	27	6	6	220.130-080-12	711-6937

ACT207

Ø	Bore	Order Code	1+	3+	6+	12+
63	22	711-6925	444.36			
80	27	711-6937	398.85			

continued