

SW120

LORLIN

Poles	Positions	Order Code	Price Each				
			1+	25+	50+	100+	250+
Standard, Non-Shorting							
1	12	.146-034					
2	6	.146-035					
3	4	.146-036					
4	3	.146-037					
Standard, Shorting							
1	12	.146-038					
2	6	.146-039					
Accessories							
Dummy wafer		.146-040					
Rotating open circuit wafer		.146-041					
Electrostatic screen		.146-042					
Spacer, 3mm		.146-043					
Spacer, 6mm		.146-044					
Spacer, 10mm		.146-045					

Key Actuator (for MK and MA Series)

Burgess



- Six position key actuator for use with either MA or MK series wafers
- Maximum of 4 MA or 3 MK wafers may be used
- Supplied with two different sized shafts to accommodate MA or MK wafers
- 5 disc tumbler with 60° between positions is fitted, key being removable in any position
- Supplied with two random keys

Panel Cut-out = 19 dia, Max panel thickness = 13.5

Mfrs. List No. A20667

SW66

Order Code		Price Each			
		1+	25+	100+	250+
.147-143					

PT Series

LORLIN

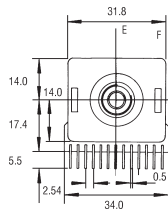
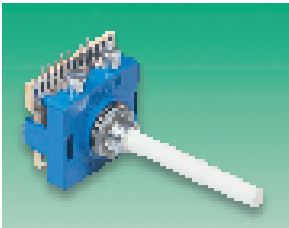

End View

H = 31.4, W = 31.8, D = 16.7
 Indexing angle = 30°, Bush L = 8, Th = M10 0.75
 Spindle L = 42.0 (exc. bush), Dia = 6.0

- Printed circuit mounting
- Moulded from flame retardant polyester and rear glass fibre PCB
- Supplied with adjustable stop, 2 to 12 position
- 2 pole/5 way and 3 pole/3 way switches can also have an 'OFF' position

Voltage rating	250V ac/dc	Insulation resistance	500MΩ
Proof voltage	1000V	Contacts	Silver plated
Current rating (non-switching)	2A continuous	Contact resistance	<50mΩ
Contact rating	0.5A continuous	Switching life	10,000 ops

Mfrs. List No's. PT6434/BMH = 150-569, PT6422/BMH = 150-570, PT6509/BMH = 150-571

SW151

Poles	Positions	Order Code	Price Each			
			1+	15+	100+	250+
1	12	.150-569				
2	5	.150-570				
3	3	.150-571				

Any Questions?

Our technical help desk will provide the answers, free of charge.
 Please call (65) 788 1922
 or e-mail singapore-technical@farnell.com

CK Series

350mA @ 110V ac/dc, 150mA @ 250V ac/dc

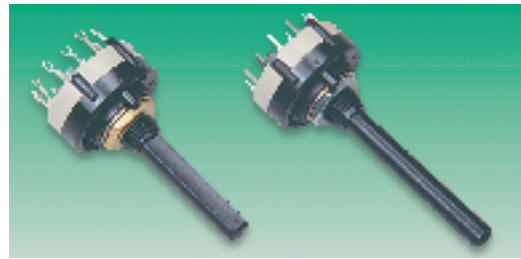

<p>Solder terminals Max body dia = 27.5, body H = 12.8 Mounting bush: L = 8, Dia = 9.5 Spindle L = 38, Dia = 6.35 (with 30mm flat) Imperial Dia = 6.0 Metric</p>	<p>PCB terminals Max body dia = 27.5, body H = 12.8 Mounting bush: L = 8, Dia = 10 Spindle L = 50, Dia = 6.0</p>
---	--

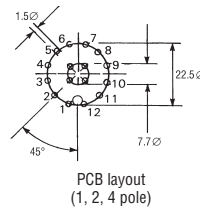

PCB layout (1, 2, 4 pole)

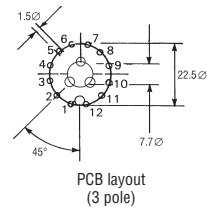

PCB layout (3 pole)

- Single bank switches moulded in **UL94V-0** rated glass filled nylon
- Adjustable stop facility mechanism
- Positive indexing obtained from dual spring plunger
- Choice of non-shorting or shorting contacts
- Choice of metric or imperial spindle diameter
- Choice of solder or PCB terminals

Best value

Voltage rating	300V ac/dc	Contact material	Silver plated brass, minimum 0.0001" silver ensures a life of 15,000 switching operations
Proof voltage	1000V	Operating temperature	-30°C to +85°C
Current rating (non-switching)	5A continuous		
Contact resistance	<10mΩ		
Indexing angle	30°		

Mfrs. List No.

CK1029 = 480-502,	CK1024 = 422-381,	CK1025 = 422-393,	CK1026 = 425-310,
CK1027 = 422-411,	CK1034 = 422-423,	CK1035 = 422-435,	CK1036 = 422-447,
CK1037 = 422-459,	CK1049 = 422-460,	CK1050 = 422-472,	CK1051 = 422-484,
CK1052 = 422-496,	CK1059 = 422-502,	CK1060 = 422-514,	CK1061 = 422-526,
CK1062 = 422-538,	CK1031 = 480-526,	CK1032 = 480-538,	CK1030 = 480-514

SW68

Poles	Positions	Order Code	Price Each				
			1+	25+	100+	250+	1000+
Imperial with Solder Terminals							
Non-Shorting							
1	12	.422-381					
2	6	.422-393					
3	4	.425-310					
4	3	.422-411					
Shorting							
1	12	.422-423					
2	6	.422-435					
3	4	.422-447					
4	3	.422-459					
Metric with PCB Terminals							
Non-Shorting							
1	12	.422-460					
2	6	.422-472					
3	4	.422-484					
4	3	.422-496					
Shorting							
1	12	.422-502					
2	6	.422-514					
3	4	.422-526					
4	3	.422-538					
Metric with Solder Terminals							
Non-Shorting							
1	12	.480-502					
2	6	.480-514					
3	4	.480-526					
4	3	.480-538					

continued