

Anti-Vibration Mounts — continued

Radiaflex

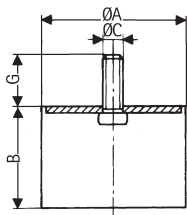

Single-threaded stud fixing

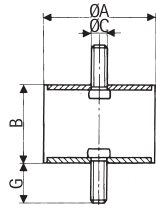

Two-threaded stud fixing

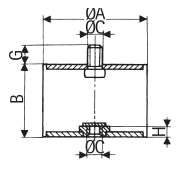

Combination fixing

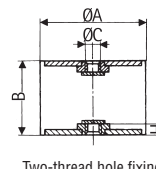

Two-thread hole fixing

- Metalwork: mild steel, plated
- Natural rubber bonded
- Fixings: 4 options (male one end only, male/male, male/female, female/female)
- Greater radial flexibility than axial
- Install at any angle to suit application

Operation in shear is very useful for vibration isolation provided that the radial forces are not too great

ØA	B	ØC	G	Weight g	Compression			Shear Deflection	Order Code
					Max. Load kg	Deflection Load kg	Max Load kg		
Single - Threaded Stud Fixing									
12.5	10	M5	10	5	12	2	N/A	N/A	710-8047
12.5	13.5	M5	10	5	11	2.5	N/A	N/A	710-8060
12.5	15	M5	10	5	10	3	N/A	N/A	710-8059
16	15	M5	12	7	20	3	N/A	N/A	710-7754
20	20	M6	16.5	15	30	5	N/A	N/A	710-7730
25.5	19	M8	20	25	55	4.5	N/A	N/A	710-7742
30	30	M8	25	40	70	8	N/A	N/A	710-7766
40	35	M10	25	80	120	8	N/A	N/A	710-7778
50	25	M10	25	95	300	6	N/A	N/A	710-7780
60	36	M10	25	165	300	9	N/A	N/A	710-7791
70	35	M10	25	250	450	9	N/A	N/A	710-7808
80	30	M14	35	315	950	8	N/A	N/A	710-7810
Two - Threaded Stud Fixing									
12.5	15	M5	10	7	10	3	2.5	2	710-7821
16	15	M5	12	10	20	3	2.5	2	710-7845
20	20	M6	16.5	20	30	4.5	5	3.5	710-7857
25.5	22	M8	20	40	50	4	8	4	710-7833
30	30	M8	25	55	70	8	11	6	710-7869
40	35	M10	25	110	120	8	20	6.5	710-7870
50	25	M10	25	130	300	6	25	4.5	710-7882
60	45	M10	25	240	250	11	30	9	710-7884
70	50	M10	25	400	350	11	35	11	710-7900
100	50	M16	47	960	900	12	60	10	710-7912
Combination fixing									
16	15	M5	12	8	20	3	2.5	2	710-7924
20	25	M6	16.5	15	30	5.5	4.5	4.5	710-7936
25.5	25	M8	20	35	50	5	8	4.5	710-7948
30	40	M8	25	50	60	9	11	7.5	710-7950
40	40	M10	25	105	120	10	20	7.5	710-7961
50	35	M10	25	135	250	8	25	7	710-7973
Two - Threaded Holes Fixing									
16	15	M5	-	5	20	3	2.5	2	710-7985
20	20	M6	-	10	30	4.5	5	3.5	710-7997
25.5	25	M8	-	30	50	4.5	8	4.5	710-8000
30	30	M8	-	30	70	7.5	11	6	710-8011
40	40	M10	-	85	120	10	20	7.5	710-8023
50	45	M10	-	130	190	10	25	9	710-8035

stc107

Mfrs. List No.	Order Code	Price Each				
		1+	12+	24+	48+	96+
Single - Threaded Stud Fixing						
511110	710-8047					
511128	710-8060					
511115	710-8059					
511294	710-7754					
511220	710-7730					
511251	710-7742					
511312	710-7766					
511452	710-7778					
511525	710-7780					
511635	710-7791					
511735	710-7808					
511830	710-7810					

Mfrs. List No.	Order Code	Price Each				
		1+	12+	240+	48+	96+
Two - Threaded Stud Fixing						
521128	710-7821					
521294	710-7845					
521297	710-7857					
521251	710-7833					
521312	710-7869					
521452	710-7870					
521580	710-7882					
521641	710-7894					
521710	710-7900					
521909	710-7912					
Combination Fixing						
520011	710-7924					
520017	710-7936					
520022	710-7948					
520028	710-7950					
520032	710-7961					
520035	710-7973					
Two - Threaded Holes Fixing						
520501	710-7985					
520506	710-7997					
520512	710-8000					
520517	710-8011					
520522	710-8023					
520526	710-8035					

Conical Progressive Stop

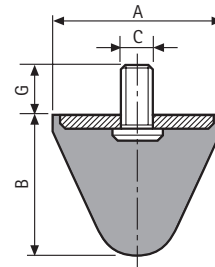

- Metalwork: mild steel, plated
- Natural rubber bonded
- Fixings: single - threaded stud
- Profiled for optimum snubbing
- High deformation allows a high level of energy to be absorbed

Stops must be fitted so that on impact the axis of the stop is perpendicular to the contact surface.

Applications: Avoid hammering and deterioration of equipment due to shocks.

ØA	B	ØC	G	Wgt g	Repetitive Shocks		React kg	Except Shock Energy Joules	Order Code
					Energy Joules	Deflection			
25.5	19	M8	20	20	3	8	100	9	710-0730
50	64	M8	35	40	32	370	120	150	710-0741
72	58	M12	30	50	26	550	150	300	710-0753

stc111

Mfrs. List No.	Order Code	Price Each				
		4+	12+	24+	48+	96+
512251	711-0730					
512502	711-0741					
512721	711-0753					

Miniflix®

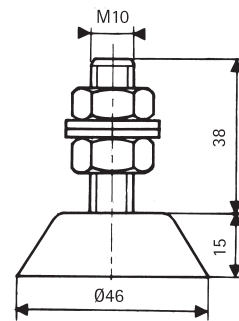

- Metalwork: mild steel plated and stainless steel
- Natural rubber: grey or black with anti-slip ridged surfaces
- Fixings: one threaded stud complete with nuts and washers

Applications: installation of electrical/electronic enclosures, packaging equipment, test/measuring equipment and food.