

## Sealed — Continued

### 900 Series Buccaneer Accessories

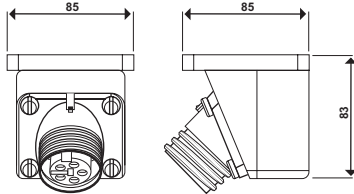
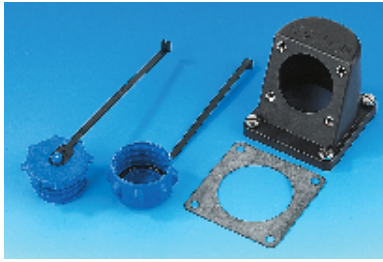

- PX0950**
  - Additional bulkhead adaptor moulding
  - For use with PX0941 to give 45° or 90° angle
  - Supplied with high grade sealing gasket and screws for fixing PX0941
- PX0950** Bulkhead adaptor moulding with gasket and screws
- PX0960** Sealing cap for use with PX091/x/xx/x
- PX0970** Sealing cap for use with all other styles
- PX0980** Gland pack for 7-13mm diameter cables

CM496

Mftrs. List No.	Order Code	1+	25+	50+	100+	250+	500+
PX0950	<b>313-6115</b>						
PX0960	<b>313-6127</b>						
PX0970	<b>313-6139</b>						
PX0980	<b>313-6140</b>						

## Low Voltage DC Power Connectors

Miniature plugs and sockets for low voltage dc power requirements. Suitable for a wide range of applications eg. measurement and test instruments, calculators, portable audio/visual equipment, rechargeable battery packs etc.

Available in three sizes of plugs and PCB mounting sockets or a single chassis mounting socket.

Contact rating	5A @ 12V dc (1A, 1.3mm)	Housing	Black ABS
Temperature range	0°C to +70°C	Contacts	Brass, nickel/silver plated
		Termination	Solder

CM215X

### Plugs



1.3      2.1      2.5

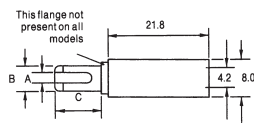

Dimensions	A	B	C
1.3	1.3	3.5	9.0
2.1	2.1	5.5	9.5
2.5	2.5	5.5	9.5

CM216X

10 Per Pack	Price Per Pack					
Hole Dia	Order Code	1+	10+	25+	50+	100+
1.3	<b>.224-911</b>					
2.1	<b>.224-923</b>					
2.5	<b>.224-935</b>					

### Chassis Mounting Sockets 2.1mm Pin Diameter

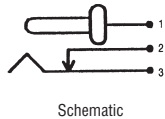
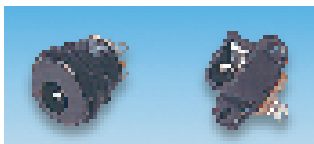

<b>Screw mount</b> D (behind panel) = 15.2 Dia = 16 max Panel cut-out = 12.6 ± 0.1 dia. Panel thickness = 7	<b>Flange fixing</b> H = 20.5, W = 9.0, D = 18.1 max (incl pins) Fixing centres = 15.5 2.4 diameter Panel thickness = 7.5 max,
---	--

CM218

10 Per Pack	Price Per Pack				
Order Code	1+	10+	25+	50+	100+
Screw mount	<b>299-972</b>				
Flange fixing	<b>.224-972</b>				

### PCB Mounting Sockets

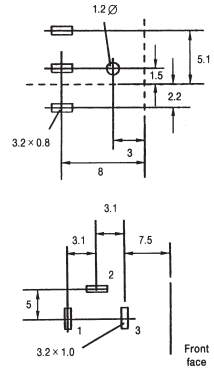
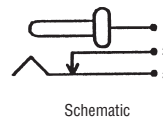
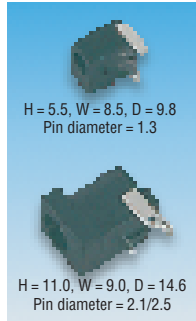

CM217

10 Per Pack	Price Per Pack					
Pin Dia	Order Code	1+	10+	25+	50+	100+
1.3	<b>.224-947</b>					
2.1	<b>.224-959</b>					
2.5	<b>.224-960</b>					

### DIN ISO 4165 Plug - Standard



L = 55, Dia = 23

- Designed for connecting accessories to 6-24V dc car, boat and caravan electrical systems
- Suitable for all standard **DIN ISO 4165** socket outlets

FOR MATING SOCKET SEE **BELOW**

CM347

Mftrs. List No.	Order Code	1+	10+	25+	50+
Plug 57725000	<b>658-674</b>				

### DIN ISO 4165 Plug – Universal

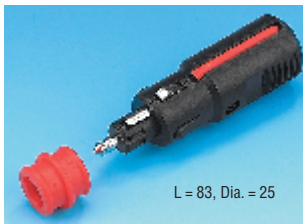

L = 83, Dia. = 25

- For 6 to 24V dc car, boat and caravan electrical systems
- High quality **DIN ISO 4165** certified universal plug
- Bayonet catch ensures firm positioning
- Unfused and fused versions available
- Suitable for cigarette lighter and standard **DIN ISO 4165** socket outlets
- TUV** approved

CM333

Type	Mftrs. List No.	Order Code	1+	10+	25+	50+
Unfused 8A	57716000	<b>658-364</b>				
Fused 8A	57715000	<b>658-376</b>				
Unfused 16A	57716004	<b>658-388</b>				

### DIN ISO 4165 Socket Outlet 16A @ 24V dc



L = 40, Dia. = 24,  
tabs = 6.3 0.8

- Accepts **DIN ISO 4165** universal plugs see **page 424**
- Dust and splash proof
- TUV** approved

CM341

Mftrs. List No.	Order Code	1+	10+	25+	50+
57607002	<b>658-431</b>				