

## IEC Plug Filters — Continued

### Panel Mounting – Twin Fused

**SCHAFFNER**

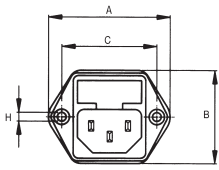
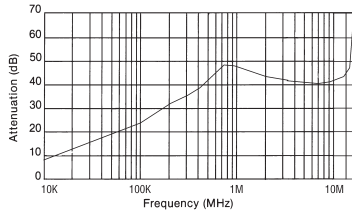

A = 46, B = 36, C = 36, H = 3.3  $\phi$

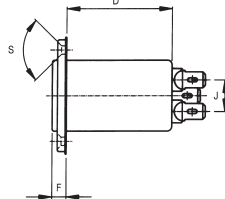

D = 41, F = 5.5, J = 12.5, S = 90°

- IEC320 mains filters with integral twin 5 20mm fuse holder
- Designed to comply with IEC950 approved to UL, CSA and VDE

Max. operating voltage	250V ac	Inductance	2 5.3mH – 1A
Max. leakage per phase	191 $\mu$ A		2 2.7mH – 2A
Capacitance Cx	100nF		2 1mH – 4A
Cy	2 2.2nF		2 0.3mH – 6A
Faston terminals	6.3 0.8		

Mftrs. List No. FN9260-X/06, X = Rating in Amps

FIL163

Rating	Order Code	Price Each				
		1+	25+	100+	250+	500+
1A	557-651					
2A	557-663					
4A	557-675					
6A	557-687					

### Panel Mounting, Fused Snap-In

**SCHURTER**

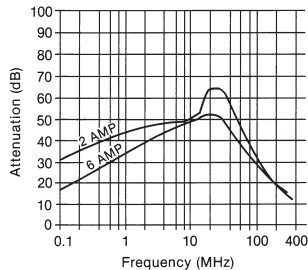

L = 48.7, H = 34, W = 36  
Panel cut-out = 29 32  
Depth behind panel = 50  
Tabs = 6.8 0.8, Max. panel thickness = 3.0

- IEC320 mains filter with integral 20 5mm fuseholder
- Approved to VDE, SEV, SEMKO, UL, and CSA
- Excellent filter and stop band characteristics to protect against mains borne interference and transients.

Voltage rating	250V @ 0 to 400Hz	Inductance	2 4mH (2A) or 2 0.8mH (6A)
Earth leakage current	50.5mA	Operating temperature	-25°C to +85°C
Capacitance	1 0.047 $\mu$ F (X) (Y) + 2 2200pF		

Mftrs. List No. 5200-0243-1 = 150-206, 5200-0643-1 = 150-207

FIL11

Rating	Order Code	Price Each			
		1+	25+	100+	250+
2A	150-206				
6A	150-207				

### Panel Mounting, Fused with Voltage Selector

**TIMONTA**

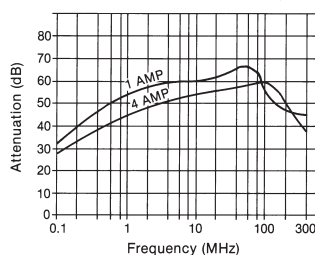

Panel cut-out = 33 29, Fixing centres = 36,  
Depth behind panel = 55, Tabs = 6.3 0.8

- IEC320 mains filter with integral 20 5mm fuseholder and three way voltage selector
- Easy to operate selector is switchable between 110V, 220V and 240V, allowing the filter to be fitted into equipment sold throughout the world
- Efficient earthing and HF screening ensure high attenuation at high frequencies
- Approved to VDE, SEV, SEMKO, UL, and CSA. Complies with IEC950 and EN133 200

Voltage rating	250V @ 50/60Hz	Earth leakage current	<0.5mA
Capacitance	0.068 $\mu$ F (X) + 2 2200pF (Y)	Operating temperature	-25°C to +85°C
Inductance	2 10mH (1A), 2 1.5mH (4A)		

Mftrs. List No. FKV2-55-1/1 = 150-928, FKV2-55-4/1 = 150-929

FIL13

Rating	Order Code	Price Each			
		1+	10+	25+	100+
1A	150-928				
4A	150-929				

### Panel Mounting, Switched and Fused, Snap-In

**Belling Lee**

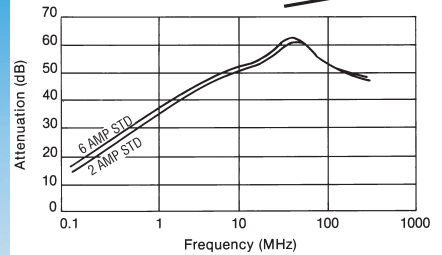
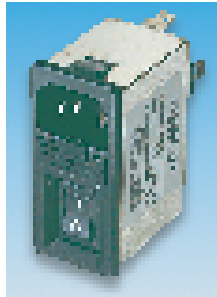

H = 65.5, W = 30, D = 67,  
Depth behind panel incl. tabs = 64. Tabs = 6.3 0.8

- IEC320 style filter conforming to BS613, with an integral 20 5mm fuse holder and double pole mains on/off switch.

Voltage rating	250V @ 0 to 400Hz	Inductance	2.0mH (2A), 0.5mH (6A)
Earth leakage current	Standard 0.2mA Medical 5 $\mu$ A	Switch operations	50,000
Capacitance	1 0.015 $\mu$ F (X) + 2 2200pF (Y) No Y Capacitors fitted to medical filters	Operating temp.	-40°C to +85°C

Mftrs. Dual List No: WF290 2/05 & SF2030-2/01 = 149-095,  
WF290 6/05 & SF2030-6/01 = 149-096.

Mftrs. List No. SF2030M-2/01 = 557-638, SF2030M-6/01 = 557-640

FIL15

Rating	Order Code	Price Each				
		1+	25+	100+	250+	500+
2A	.149-095					
6A	.149-096					
<b>Medical Versions</b>						
2A	557-638					
6A	557-640					

### Panel Mounting, Switched, Snap-In Mini Bezel

**BULGIN**  
Electrical • Electronic Components



Panel thickness = 1.5  
Depth behind panel = 63.5  
Tabs = 4.8 0.8 (switch),  
6.3 0.8 (filter).  
Panel cut-out = 45.9 21.3  
(S.P. switch)  
54.9 21.3 (D.P. Switch)

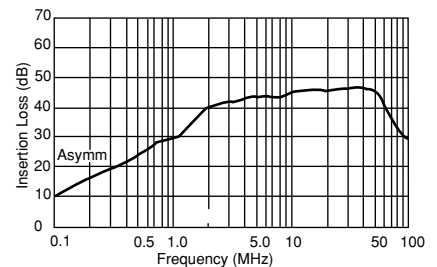

- Filtered version of Mini Bezel switched mains inlets
- Each item individually terminated for interconnection flexibility
- Approved to VDE, UL and CSA
- Green illuminated versions feature medical filters without fitted Y capacitors.

Voltage rating	250V @ 50 - 400Hz	Capacitance	0 - 015 $\mu$ F (X) + 2 2200pF (Y)
Current rating	6A	Inductance	2 0.7 mH
Earth leakage current	<0.35mA @ 250V, 50Hz	Operating temperature	-25°C to +85°C

FIL104