

2mm Minitek System

PCB Headers & Crimp Housings

2mm Minitek System



A range of PCB Headers, receptacles and crimp housings with 2mm x 2mm centrelines. Available in through mount and surface mount versions, with a choice of shrouded or unshrouded headers in both vertical or right angle design. Multiple stacking height options, including bottom entry.

- IDC capability
- Discrete crimp-to-wire
- UL and CSA approved

Current rating	2A continuous	Standard housing	Glass filled nylon (UL94V-0) Black
Voltage rating	200V ac/dc	High temp housing	Glass filled PCT (UL94V-0) Black or Cream
Withstanding voltage	650V rms		0.38um (15uin) min GXT in contact area
Contact resistance	25MΩ max	Plating (finish)	Phosphor Bronze
Insulation resistance	1000MΩ min	Mating cycles	100
Temperature range	Nylon -40 to +105°C PCT -55 to +125°C		

CP385

Order Multiple=5

No. of Ways	Mftrs. List No.	Order Code	5+	25+	50+	100+	250+
-------------	-----------------	------------	----	-----	-----	------	------

Vertical Shrouded Headers							
30	90309-530	134-168					
30	95615-530	134-170					

Vertical Stacking Header							
30	92813-003	134-181					

Right Angle Unshrouded Header							
30	94271-530	134-235					

Shunt							
2	86730-001	134-247					

Order Multiple=5

No. of Ways	Pin Length	Mftrs. List No.	Order Code	5+	25+	50+	100+	250+
-------------	------------	-----------------	------------	----	-----	-----	------	------

Vertical Unshrouded Headers								
30	2.0mm	94265-530	134-193					
30	4.0mm	94269-530	134-200					
30	2.0mm	94267-530	134-211					
30	4.0mm	94270-530	134-223					

Order Multiple=5

No. of Ways	Pin Length	Mftrs. List No.	Order Code	5+	25+	50+	100+	250+
-------------	------------	-----------------	------------	----	-----	-----	------	------

Vertical Receptacles-(board)								
30	4.5mm	87173-030	134-259					
30	4.0mm	91813-330	134-260					
30	3.0mm	91803-330	134-272					
30	4.0mm	91812-330	134-284					
30	3.0mm	91802-330	134-296					
30	2.3mm	91592-330	134-302					
30	2.3mm	91596-330	134-314					
30	2.1mm	92844-330	134-326					
30	2.1mm	92429-330	134-338					
40		88333-040	134-340					

IDC Receptacle								
30	-	89361-330	134-351					

Order Multiple=5

No. of Ways	Mftrs. List No.	Order Code	5+	25+	50+	100+	250+
-------------	-----------------	------------	----	-----	-----	------	------

Housings							
2	2	69307-004	134-387				
2	3	69307-006	134-399				
2	4	69307-008	134-405				
2	5	69307-010	134-417				
2	6	69307-012	134-429				
2	7	69307-014	134-430				
2	8	69307-016	134-442				
2	9	69307-018	134-454				
2	10	69307-020	134-466				
2	11	69307-022	134-478				
2	12	69307-024	134-480				
2	13	69307-026	134-491				
2	14	69307-028	134-508				
2	15	69307-030	134-510				

Order Multiple=50

Wire Size	Mftrs. List No.	Order Code	50+	100+	500+	1000+	2500+
-----------	-----------------	------------	-----	------	------	-------	-------

Crimp Terminals							
26-30 AWG	77138-001	134-363					
32-36 AWG	77139-001	134-375					

Order Multiple=1

Price Each

Tooling			
20-30 AWG	HT151	134-521	
32-36 AWG	HT152	134-533	

1+

2mm Pitch Connectors

Pin Headers and Sockets



- PCB headers on 2mm pitch, with mating sockets for board to board connections
- Crimp terminals and housing for wire to board connections
- Single and double row phosphor bronze headers 0.5mm square
- Available in up to 50 ways, can be cut to smaller sizes
- Mates with Harwin 2mm socket range

Housings	Glass filled thermoplastic, UL94V-0 rated
Contacts	Phosphor bronze
Contact rating	2A max. @ 25°C (for an individual contact) 1A max. @ 25°C (for all contacts)
Working voltage	250V dc/250V ac (peak)
Insulation resistance	10 ⁴ MΩ (min.)
Operating temperature	-41°C to +85°C



CP329

Pin Headers – Straight

Gold Plated, SIL and DIL

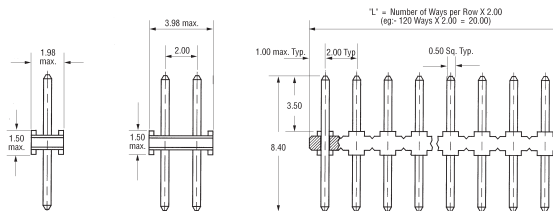
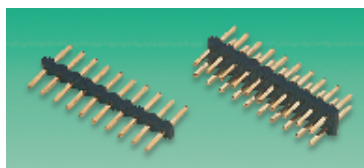

Mftrs. List No. Single row = M22-201xx05, Double row = M22-202xx05, where xx = No. of ways

CP327

No. of Ways	Order Code	10+	50+	100+	500+	1000+
-------------	------------	-----	-----	------	------	-------

Single Row						
Order Multiple=10						
2	671-915					
3	671-927					
4	671-939					
5	671-940					
6	671-952					
8	671-964					
10	671-976					
12	671-988					

Order Multiple=1						
20	671-990	1+	10+	50+	100+	500+
50	672-002					

Double Row						
Order Multiple=10						
2+2	672-014	10+	50+	100+	500+	1000+
3+3	672-026					
4+4	672-038					
5+5	672-040					
6+6	672-051					
8+8	672-063					
10+10	672-075					
12+12	672-087					

Order Multiple=1						
20+20	672-099	1+	10+	50+	100+	
50+50	672-105					

Pin Headers – 90°

Gold Plated, SIL and DIL

