

Circular Multipole — Continued

Cable Plugs - Series 3



Cable plug for pin contacts Cable plug for socket contacts

- Power density cable plugs accepting pin or socket contacts

CM437

| No. of Ways | Shell Size | Mfrs. List No. | Order Code | 1+ | 100+ | 250+ | 500+ |
|---|------------|----------------|-----------------|----|------|------|------|
| Cable Plug - Accepts Pin Contacts | | | | | | | |
| 3 | 17 | 206426-1 | 135-3860 | | | | |
| 7 | 23 | 206226-1 | 135-3925 | | | | |
| Cable Plug - Accepts Socket contacts | | | | | | | |
| 3 | 17 | 206037-1 | 135-3834 | | | | |
| 7 | 23 | 206136-1 | 135-3895 | | | | |

Contacts - Series 3



135-3937 176-8190 183-1136

- Gold plated crimp contacts for use with the series 3 range of AMP (CPC) connectors

Mfrs List No: 66261-2 = 135-3937, 66740-6 = 183-1136 66259-2 = 135-3949, 66741-6 = 145-8899 206508-1 = 176-8190,

CM439

| Order Multiple=4 | Order Code | 4+ | 48+ | 100+ |
|----------------------------------|-----------------|------------|-------------|-------------|
| Gold Plated Pins | | | | |
| 6-12AWG, 1.3-3.4mm ² | 135-3937 | | | |
| 10-8AWG, 4.5-8.3mm ² | 135-3949 | | | |
| Gold Plated Sockets | | | | |
| 16-12AWG, 1.3-3.4mm ² | 183-1136 | | | |
| 10-8AWG, 4.5-8.3mm ² | 145-8899 | | | |
| Order Multiple=10 | | | | |
| Keying Plug | 176-8190 | 10+ | 100+ | 500+ |

Receptacles - Series 3



Free Receptacles Fixed Receptacles

- Receptacles accepting either plug or socket contacts
- Available for fixed (bulkhead) or free (in-line) connections

Fixed Receptacle Dimensions

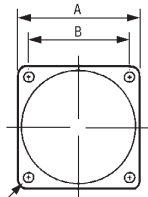

| Shell Size | A | B | C | Panel Cut-out Dia |
|------------|------|------|-----|-------------------|
| 17 | 36.5 | 28.6 | 3.8 | 29.4 |
| 23 | 44.5 | 36.5 | 3.8 | 40.9 |

CM438

| No of Ways | Shell Size | Mfrs. List No. | Order Code | 1+ | 100+ | 250+ | 500+ |
|--|------------|----------------|-----------------|----|------|------|------|
| Free Receptacles - Accepts Pin Contacts | | | | | | | |
| 3 | 17 | 206207-1 | 135-3822 | | | | |
| 7 | 23 | 206137-2 | 135-3883 | | | | |
| Fixed Receptacles - Accepts Pin Contacts | | | | | | | |
| 3 | 17 | 206036-2 | 135-3810 | | | | |
| 7 | 23 | 206137-1 | 135-3871 | | | | |
| Free Receptacles - Accepts Sockets Contacts | | | | | | | |
| 3 | 17 | 206425-2 | 135-3858 | | | | |
| 7 | 23 | 206227-2 | 135-3913 | | | | |
| Fixed Receptacles - Accepts Socket Contacts | | | | | | | |
| 3 | 17 | 135-3846 | 135-3846 | | | | |
| 7 | 23 | 135-3901 | 135-3901 | | | | |

Tools - Series 3

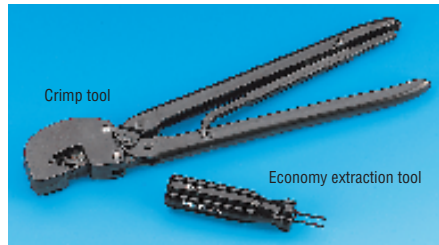

Crimp tool

Economy extraction tool

- Extraction on and ratchet crimp tool for use with AMP (CPC)
- Series 3 range of pin and socket contacts

CM440

| | Mfrs. List No. | Order Code | Price Each |
|-------------------------|----------------|-----------------|------------|
| Crimp tool (16-12 AWG) | 90382-2 | 135-3974 | 1+ |
| Crimp tool (10-8 AWG) | 90384-1 | 135-3986 | |
| Economy extraction tool | 91124-1 | 135-3950 | |
| Extraction tool | 91019-3 | 135-3962 | |

Circular Plastic and Circular Plastic Metal Shell



Series 5

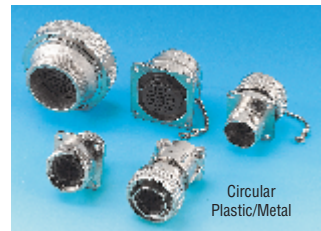

Circular Plastic/Metal



Series 6



Accessories



Series 1 Sealed

- Metal shell CPC series 1 are for standard density, signal and low current applications using Multimate size 16 contacts
- Metal shell CPC series 2 are currents up to 7.5A max. using size 20 contacts
- Sealed CPC series 1 have a pre-installed bonded peripheral seal – mates with series 1 plugs
- Sealed CPC series 5 & 6 take the new 0.125 powerband crimp contact

Metal CPC series 1 & 2

| | |
|---|------------------------------|
| Housing | Thermoplastic UL94V-0 |
| Metal shell | Zinc alloy, nickel plated |
| Grooved pin | Steel alloy, nickel plated |
| Retainer ring | Stainless steel |
| Coupling ring | Zinc alloy, nickel plated |
| Operating temperatures and approvals as standard CPC connectors | |

Sealed CPC series 1, 5 & 6

Currently being tested to **SAE, ASAE, IP 65, 66, 67, UL and NEMA class 4** standards
Amp powerband precision formed power contact fits series 5 & 6
Contains wire entry, peripheral and full interfacial seals
Powerband contacts offer the performance of a MIL-spec contact at stamped and formed price

Series 5 & 6

| | |
|-----------------------|--|
| Operating temperature | -50°C to +125°C |
| Voltage rating | Series 5: 600V ac/dc Series 6: 250V ac/dc |
| Flammability | UL94V-0 |
| Housing | High strength thermoplastic |
| Fluid resistance | Diesel, petrol, gear and engine oil, anti-freeze and hydraulic fluid |

| Mfrs. List No. | 208719-1 = 319-5168 | 208715-1 = 319-5170 | 208489-1 = 319-5181 | 208459-1 = 319-5193 |
|---------------------|---------------------|---------------------|---------------------|---------------------|
| 208471-1 = 319-5200 | 208718-1 = 319-5211 | 208714-1 = 319-5223 | 208488-1 = 319-5235 | |
| 208457-1 = 319-5247 | 208470-1 = 319-5259 | 208721-1 = 319-5260 | 208717-1 = 319-5272 | |
| 208487-1 = 319-5284 | 208473-1 = 319-5296 | 208720-1 = 319-5302 | 208716-1 = 319-5314 | |
| 208486-1 = 319-5326 | 208472-1 = 319-5338 | 208491-1 = 319-5340 | 208477-1 = 319-5351 | |
| 208490-1 = 319-5363 | 208476-1 = 319-5375 | 208493-1 = 319-5387 | 208475-1 = 319-5399 | |
| 208492-1 = 319-5405 | 208474-1 = 319-5417 | 208945-5 = 319-5429 | 208945-7 = 319-5430 | |
| 208945-8 = 319-5442 | 213823-2 = 319-5454 | 211903-1 = 319-5466 | 211904-1 = 319-5478 | |
| 206061-2 = 319-5480 | 206705-3 = 319-5491 | 206036-4 = 319-5508 | 206838-3 = 319-5510 | |
| 206151-3 = 319-5521 | 206153-2 = 319-5533 | 206705-4 = 319-5545 | 206036-5 = 319-5557 | |
| 206838-4 = 319-5569 | 206151-4 = 319-5570 | 213889-2 = 319-5582 | 213890-2 = 319-5594 | |
| 213905-1 = 319-5600 | 213889-1 = 319-5612 | 213902-1 = 319-5624 | 213904-1 = 319-5636 | |
| 213810-1 = 319-5648 | 213893-2 = 319-5650 | 213894-2 = 319-5661 | 213906-1 = 319-5673 | |
| 213900-1 = 319-5685 | 213845-4 = 319-5697 | 213845-3 = 319-5703 | 213841-1 = 319-5715 | |

continued